

FOR LEASE

WAREHOUSE SPACE

±115,822 SF

BILLERICA COMMERCE CENTER, 90 SALEM ROAD

North Billerica, MA



±115,822 SF WAREHOUSE SPACE

PROPERTY OVERVIEW

Billerica Commerce Center at 90 Salem Road is a first class distribution center consisting of 612,685 SF of warehouse space situated on 62 acres. Recent improvements include new entrance features for tenant spaces, new driveways and parking areas, new landscaping, façade improvements and new overhead dock doors.

Located northwest of Boston, the property is approximately three miles from the intersection of Route 3 and Interstate 495. The facility has warehouse clear heights of 30-38', 11 loading docks, six drive-in doors with levelers and rail service, all on a 62-acre site that can accommodate significant trailer and car parking.



BUILDING SPECIFICATIONS

- + **Use:** Warehouse and distribution
- + **Stories:** One
- + **Building Size:** 612,685 SF
- + **Available SF:** ±115,822 SF
 - **Warehouse:** ±111,322 SF
 - **Office:** ±4,500 SF
- + **Year Built/Renovated:** 1972/1982, 2007
- + **Site Size:** Approximately 62 acres
- + **Construction:** Steel-frame structure with precast-concrete panels
- + **Roof:** Ballasted rubber-membrane roof (2003)
- + **Clear Height:** 30'
- + **Bay Size:** 32' x 40' and 30' x 50'
- + **Loading:** 11 tailboard-level docks within available space and six drive-in doors
- + **HVAC:** Heat is provided by gas-fired blowers
- + **Sprinkler:** Full wet-sprinkler system (ESFR)
- + **Electric:** 5,000 Amp, 477 Volt service
- + **Utilities:**
 - **Electricity:** Mass Electric Co.
 - **Gas:** Boston Gas
 - **Water/Sewer:** Town of Billerica
- + **Rail Service:** The B&M line
- + **Parking:** The site has extensive trailer and car parking
- + **Economic Opportunity Zone:** The property is eligible for Economic Development Incentive Program & Investment Tax Credit

FOR LEASE

BILLERICA COMMERCE CENTER,
90 SALEM ROAD
North Billerica, MA



FLOOR PLAN

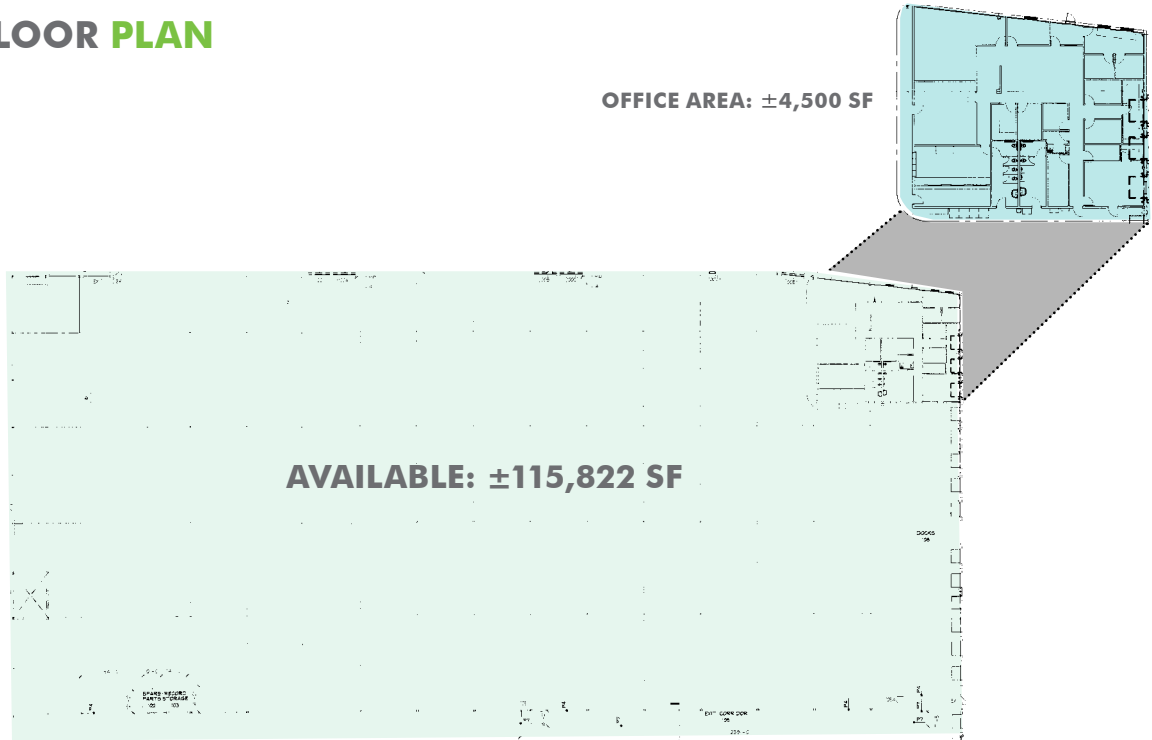

SITE PLAN

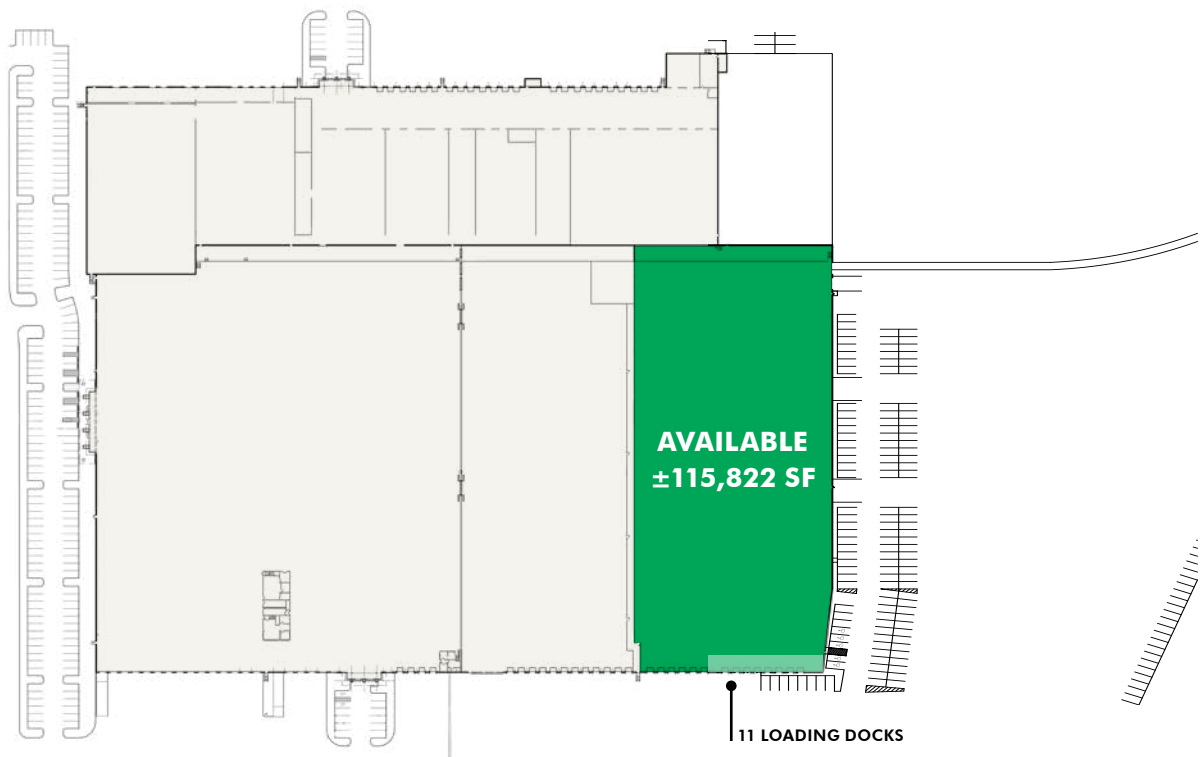

±115,822 SF WAREHOUSE SPACE

FOR LEASE
BILLERICA COMMERCE CENTER,
90 SALEM ROAD
North Billerica, MA



CONTACT US

MARK REARDON

Executive Vice President/Partner
+1 617 912 7046
mark.reardon@cbre-ne.com

DAVID CORKERY

First Vice President
+1 617 912 7036
david.corkery@cbre-ne.com

© 2017 CB Richard Ellis – N.E. Partners, LP. This information has been obtained from sources believed reliable. We have not verified it and make no guarantee, warranty or representation about it. Any projections, opinions, assumptions or estimates used are for example only and do not represent the current or future performance of the property. You and your advisors should conduct a careful, independent investigation of the property to determine to your satisfaction the suitability of the property for your needs. Photos herein are the property of their respective owners and use of these images without the express written consent of the owner is prohibited.

CBRE and the CBRE logo are service marks of CBRE, Inc. and/or its affiliated or related companies in the United States and other countries. All other marks displayed on this document are the property of their respective owners.