

# Redwood City Flex/R&D Space for Lease

783-785 Broadway, Redwood City



## ±15,800 Square Feet Available (Divisible)

We are pleased to offer the following space:

- ◆ 2 Adjacent Connected Spaces
- ◆ ±7,900 Square Foot Office Space
- ◆ Warehouse Suitable for “Tech” R&D Office
- ◆ New Skylights, Roof and Four Restrooms
- ◆ 2 Drive-in Doors
- ◆ 25 On-site Parking Spaces
- ◆ 600 Amps, 110/240 Volt, 3 Phase Power
- ◆ TIs Available
- ◆ Zoning LII Light Industrial Incubator
- ◆ Close to Stanford Office Park and Facebook Campus
- ◆ Easy Access to Woodside Road, Highway 101 & Dumbarton Bridge and Downtown Redwood City
- ◆ Call Brokers for Pricing



**Josh Rowell** 650.358.5261 [jrowell@ngkf.com](mailto:jrowell@ngkf.com) CA RE License #01236434

**John Weatherby** 650.358.5269 [jweatherby@ngkf.com](mailto:jweatherby@ngkf.com) CA RE License #00640295



2950 S. Delaware Street, Suite 125, San Mateo, CA 94403

[www.ngkf.com](http://www.ngkf.com)

The distributor of this communication is performing acts for which a real estate license is required. The information contained herein has been obtained from sources deemed reliable but has not been verified and no guarantee, warranty or representation, either express or implied, is made with respect to such information. Terms of sale or lease and availability are subject to change or withdrawal without notice.

18-0882-06/20

# Redwood City Flex/R&D Space for Lease

783-785 Broadway, Redwood City

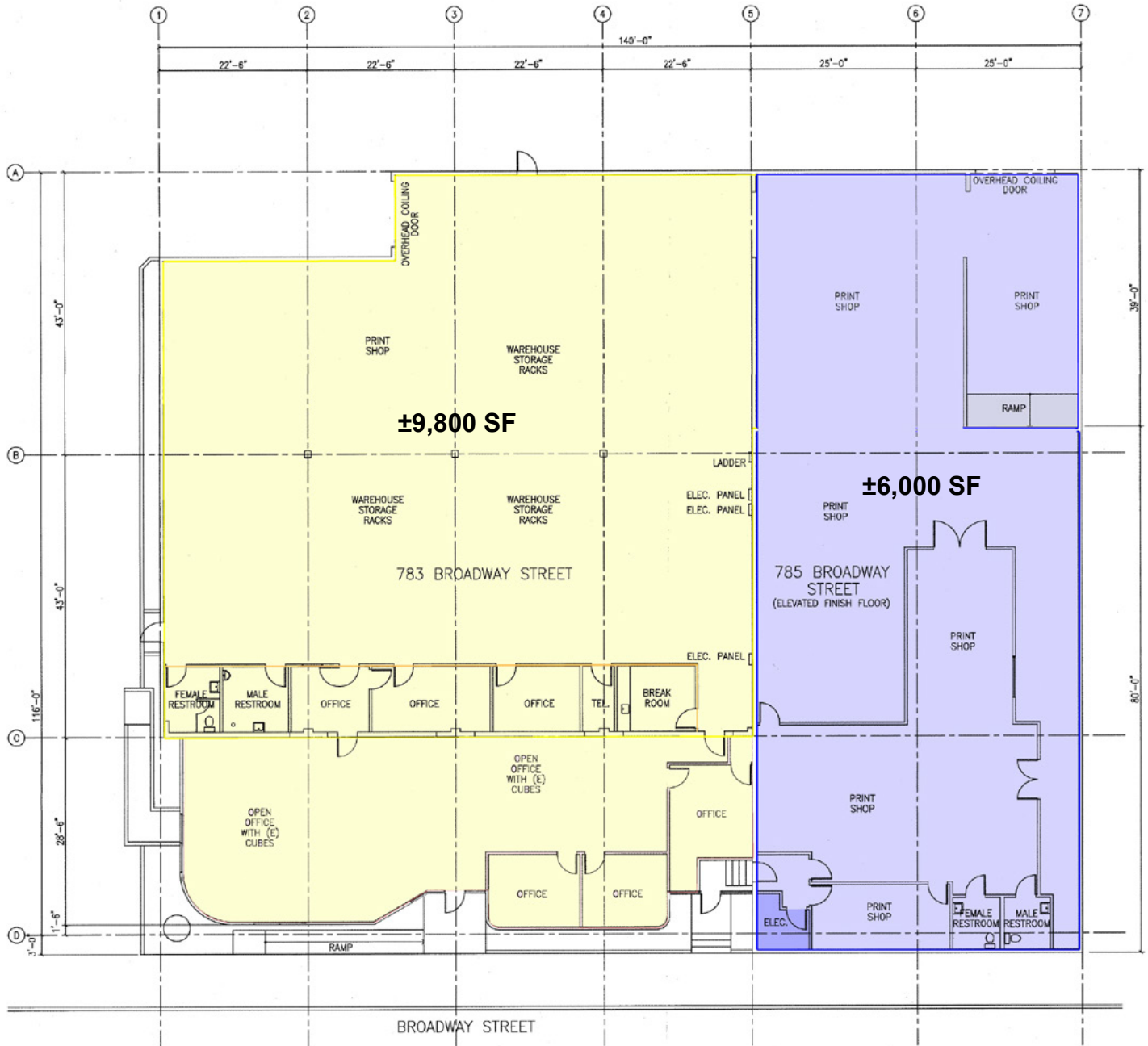

**Josh Rowell** 650.358.5261 [jrowell@ngkf.com](mailto:jrowell@ngkf.com) CA RE License #01236434

**John Weatherby** 650.358.5269 [jweatherby@ngkf.com](mailto:jweatherby@ngkf.com) CA RE License #00640295



2950 S. Delaware Street, Suite 125, San Mateo, CA 94403

[www.ngkf.com](http://www.ngkf.com)

The distributor of this communication is performing acts for which a real estate license is required. The information contained herein has been obtained from sources deemed reliable but has not been verified and no guarantee, warranty or representation, either express or implied, is made with respect to such information. Terms of sale or lease and availability are subject to change or withdrawal without notice.

# Redwood City Flex/R&D Space for Lease

783-785 Broadway, Redwood City



**Josh Rowell** 650.358.5261 [jrowell@ngkf.com](mailto:jrowell@ngkf.com) CA RE License #01236434

**John Weatherby** 650.358.5269 [jweatherby@ngkf.com](mailto:jweatherby@ngkf.com) CA RE License #00640295



2950 S. Delaware Street, Suite 125, San Mateo, CA 94403

[www.ngkf.com](http://www.ngkf.com)

The distributor of this communication is performing acts for which a real estate license is required. The information contained herein has been obtained from sources deemed reliable but has not been verified and no guarantee, warranty or representation, either express or implied, is made with respect to such information. Terms of sale or lease and availability are subject to change or withdrawal without notice.

18-0882-06/20

# Redwood City Flex/R&D Space for Lease

783-785 Broadway, Redwood City



**Josh Rowell** 650.358.5261 [jrowell@ngkf.com](mailto:jrowell@ngkf.com) CA RE License #01236434

**John Weatherby** 650.358.5269 [jweatherby@ngkf.com](mailto:jweatherby@ngkf.com) CA RE License #00640295



2950 S. Delaware Street, Suite 125, San Mateo, CA 94403

[www.ngkf.com](http://www.ngkf.com)

The distributor of this communication is performing acts for which a real estate license is required. The information contained herein has been obtained from sources deemed reliable but has not been verified and no guarantee, warranty or representation, either express or implied, is made with respect to such information. Terms of sale or lease and availability are subject to change or withdrawal without notice.

18-0882-06/20

# Redwood City Flex/R&D Space for Lease

783-785 Broadway, Redwood City

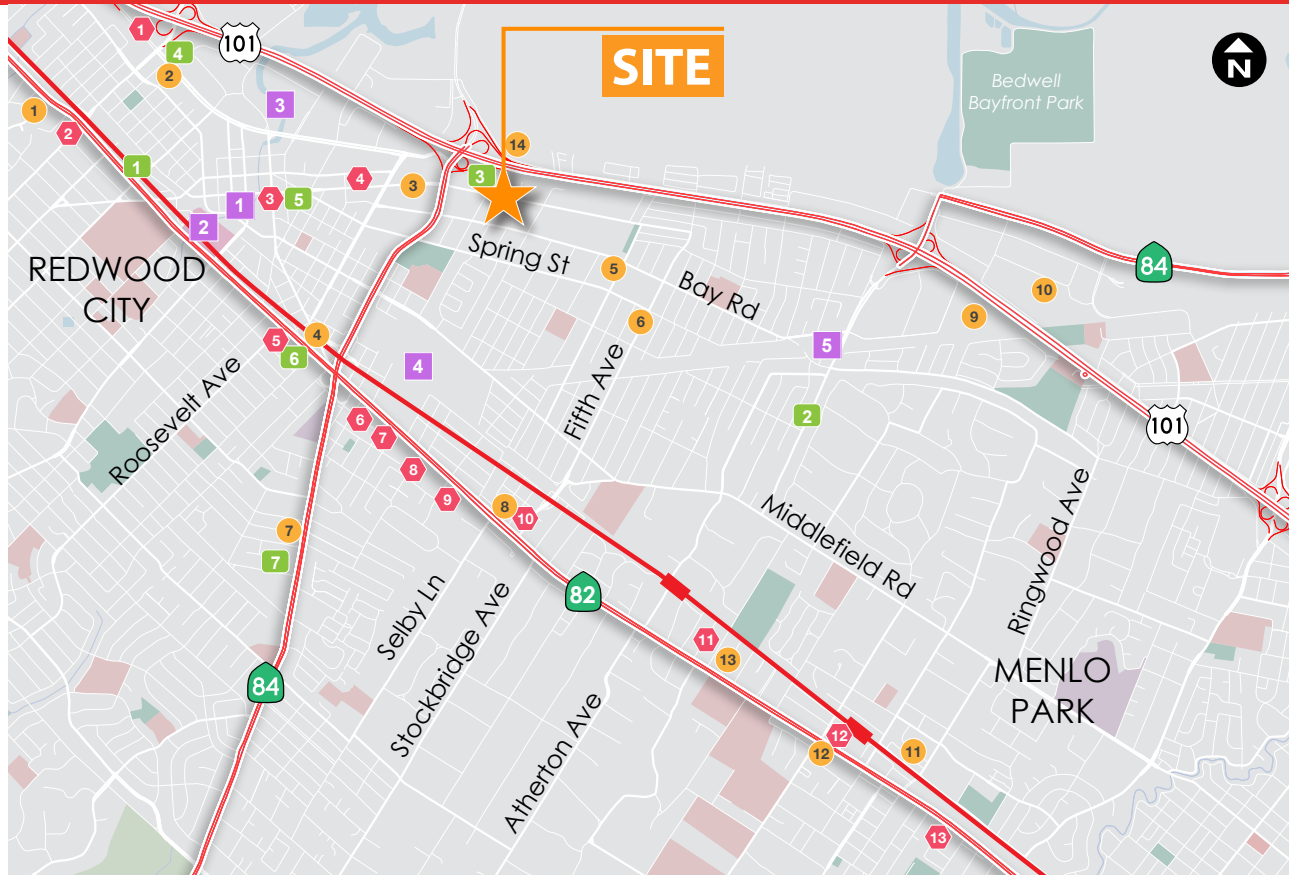

## ● RESTAURANTS

1. Mountain Mike's Pizza  
Stack's  
Nikko's Mexican Grill  
Ben Frank's  
Pasta Pomodoro  
Higuma Japanese Restaurant  
Chef Peking
2. Taqueria Mar & Tierra  
Rickshaw Chinese Restaurant  
Denny's
4. Big Tharman's BBQ  
Taqueria Los Temos  
Thai House Restaurant  
Harry's Hofbrau
5. Mi Hacienda Taqueria
6. El Grullense
7. Karlita's Taco Place  
Karakade Thai Cuisine  
El Grullense Grill  
Thaibodia
8. John Bentley's Restaurant  
Chantilly  
Bonsai Japanese Cuisine  
Hometown Noodle Restaurant  
Taqueria Apatzingan  
Mexcal Taqueria
10. Papa Balgos
13. Iberia Restaurant
14. Fey Restaurant  
Gombe Japanese Restaurant
15. Celia's
16. Varsity Restaurant

## ● HOTELS

1. Good Nite Inn
2. Best Western Inn  
Sequoia Inn
3. Sequoia Hotel  
Pacific Euro Hotel  
Garden Motel
4. Comfort Inn  
Holiday Inn Express
6. Capri Motel
7. Budget Inn
8. Pacific Inn  
Days Inn
9. Atherton Park Inn & Suites
10. Best Western Plus Executive Suites
11. Red Cottage Inn & Suites
12. Residence Inn  
Menlo Park Inn
13. Mermaid Inn Motel

## ■ SERVICES

1. Chavez Supermarket
2. Chavez Supermarket
3. 24 Hour Fitness
4. Crunch
5. Grocery Outlet
6. Mi Rancho Supermarket
7. Safeway

## ■ SHOPPING CENTERS

1. **Shops On Broadway**  
Arya Global Cuisine, Chipotle, Cinemark Century 20 Theatres, Cost Plus World Market, db Shoes, Fish's Wild, Five Guys, Green Leaf Bistro & Cafe, Pizza My Heart, Portobello Grill, San Mateo Credit Union, Sequoia Realty, Sola Salon Studios, Yoppi Frozen Yogurt, La Victoria Taqueria, Vesta
2. **Sequoia Station**  
Franklin Street Caffe, Perfect 10 Nail Salon, Starbucks, CVS Pharmacy, See's Candies, Panda Express, Pack and Mail Express, MetroPCS, Jambda Juice, Site for Sore Eyes, Max's Cafe, Pet Food Express, Safeway, Western Union, Pier 1 Imports, Noah's Bagels, Old Navy, European Wax Center
3. **Creekside Plaza**  
FedEx, Old Port Lobster Shack, In-N-Out Burger, Carl's Jr, Sakura 2 Teppanyaki and Sushi, Sizzler, Erik's DeliCafe, Starbucks, Styles For Less, Payless, Fashion Tune, Foot Locker, Jo-Ann, Quickly, Kohl's, Big 5 Sporting Goods, Babies R Us, Toys "R" Us, Applebee's
4. **Woodside Central**  
O'Reilly Auto Parts, Target, Marshalls, Chuck E. Cheese's, GNC, Crazy 8, Carter's, Payless, Pandora Foot Spa, GameStop, El Grullense, Fabulous Nails, SalonCentric, Men's Warehouse, Verizon Wireless, Panaderia Michoacan, Costco
5. **Marsh Manor**  
Delucchi's Market, DVDExpress, Angel Heart Cakes, FreeWheel Brewing Company, Los Gallos Taqueria, Yat Sing, Starbucks, Atherton Subs

## ➔ CALTRAIN STATIONS

**Josh Rowell** 650.358.5261 [jrowell@ngkf.com](mailto:jrowell@ngkf.com) CA RE License #01236434

**John Weatherby** 650.358.5269 [jweatherby@ngkf.com](mailto:jweatherby@ngkf.com) CA RE License #00640295



2950 S. Delaware Street, Suite 125, San Mateo, CA 94403

[www.ngkf.com](http://www.ngkf.com)