

PARRISH CREEK BUSINESS PARK

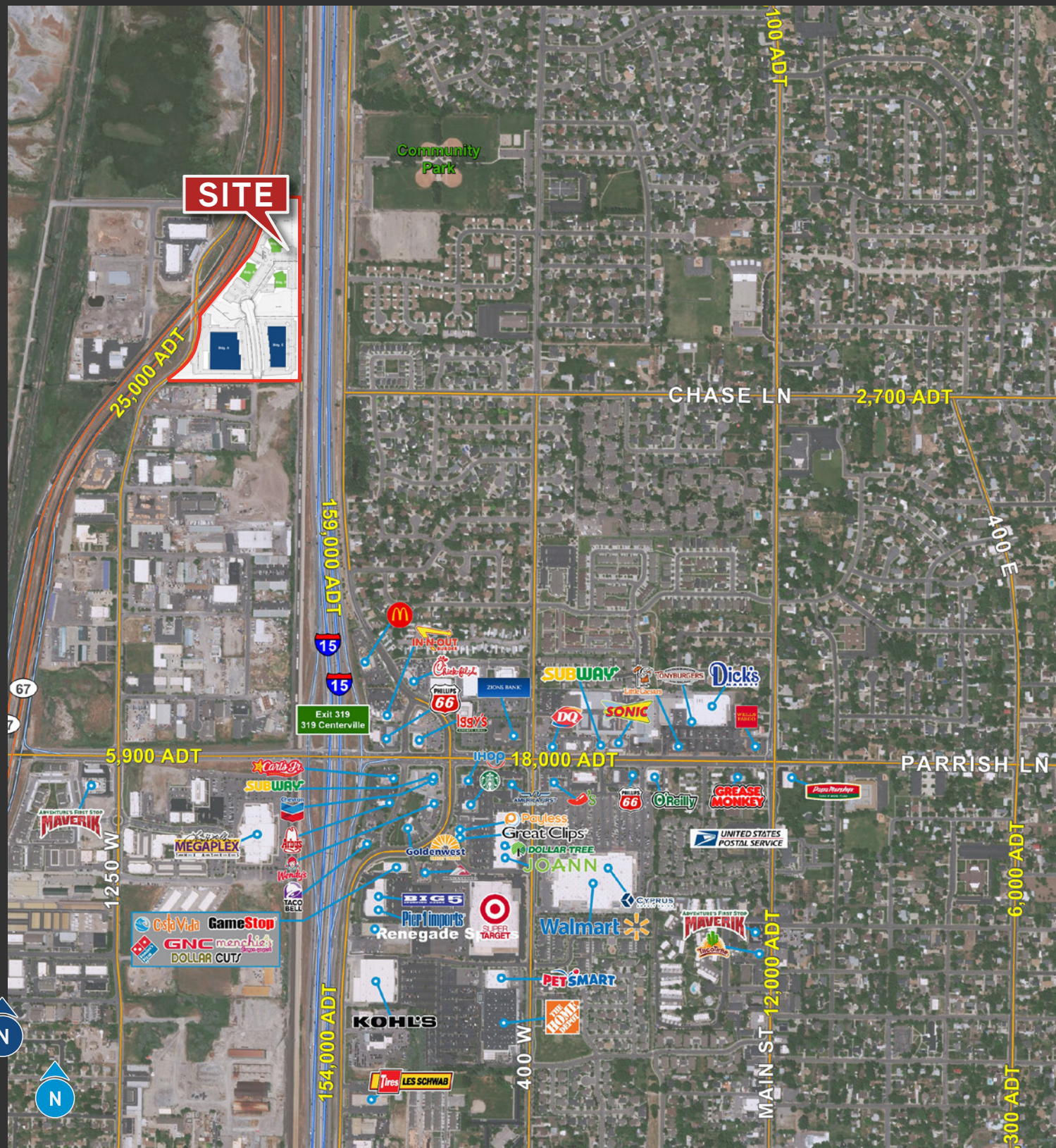

FOR SALE OR LEASE | 1250 WEST 1050 NORTH CENTERVILLE, UTAH



Accelerating success

Colliers International
111 Main Street | Suite 2200
Salt Lake City, UT 84111
P: +1 801 947 8300

Ryan Flint
+1 801 814 9632
ryan.flint@colliers.com

Rand Sargent
+1 801 989 1600
rand.sargent@colliers.com

Ryan Flint
+1 801 814 9632
ryan.flint@colliers.com

Rand Sargent
+1 801 989 1600
rand.sargent@colliers.com

Colliers International
111 Main Street | Suite 2200
Salt Lake City, UT 84111
P: +1 801 947 8300



Accelerating success

PARRISH CREEK BUSINESS PARK

1250 WEST 1050 NORTH CENTERVILLE, UTAH

Property Information

- Call agent for sale price & information
- Class A Flex
- Office Lease Rate is \$1.15 PSF, NNN
- Warehouse Lease Rate is \$0.65 PSF, NNN
- To Be Built
- Clear Height: 28' - 30'
- Space Type: Class A Office/Distribution/Manufacturing
- Power: 3 phase, 480 V power
- Doors: Dock High & 14' Ground Level
- Parking: Ample
- Utopia fiber optics
- ESFR Fire Suppression System
- This site provides traffic counts of 121,095 ADT on I-15 and 30,095 ADT on Legacy Highway with unmatched visibility.
- Excellent accessibility to northbound / southbound I-15 and Legacy Highway for both clients and employees.
- Park will include dominant landscaping with natural water features throughout.
- Property will also feature a walking trail throughout the 16 acres to help you enjoy it all.



CLASS A FLEX

- Building A: 57,000 SF
- Building B: 10,000 SF
- Building C: 10,000 SF
- Building D: 10,000 SF
- Building E: 35,099 SF

