

7,800 SF

Industrial Space For Lease



Northwest Corporate Park - Kent

20206 87th Avenue S
Kent, WA



LOCATION

- 50 yard line location
- Great access to Hwy-167, I-5 and I-405

FACILITY

- 7,800 SF shell
- 1,090 SF office
- 2 DH doors / 1 GL Door
- 24' clear height
- Rail served
- Available October 1, 2017

7,800 SF

Industrial Space For Lease

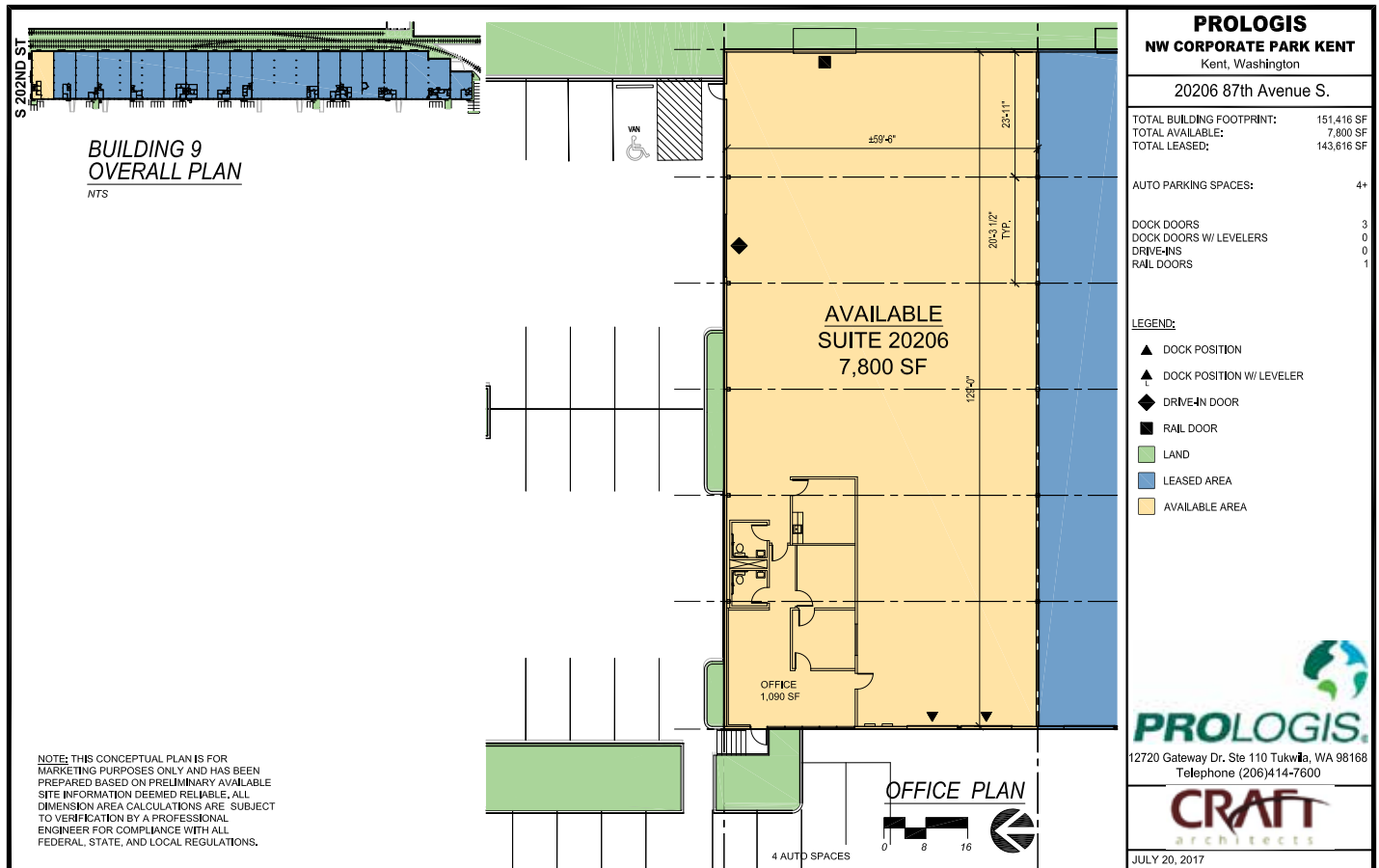

Kidder Mathews
Matt Wood, SIOR
 mwood@kiddermathews.com
 ph 206 248 7306
 fax 206 248 7342
 12886 Interurban Ave S
 Seattle, WA 98168

Kidder Mathews
Thad Mallory, SIOR
 tmallory@kiddermathews.com
 ph 206 248 7338
 fax 206 248 7342
 12886 Interurban Ave S
 Seattle, WA 98168

Kidder Mathews
Tony Miltenberger, SIOR
 tonym@kiddermathews.com
 ph 206 248 7307
 fax 206 248 7342
 12886 Interurban Ave S
 Seattle, WA 98168

Prologis
Rick Kolpa
 rkolpa@prologis.com
 ph 206 414 7610
 fax 206 414 7601
 12720 Gateway Dr, Ste 110
 Tukwila, WA 98168

7,800 SF

Industrial Space For Lease



Kidder Mathews

Matt Wood, SIOR
mwood@kiddermathews.com
ph 206 248 7306
fax 206 248 7342
12886 Interurban Ave S
Seattle, WA 98168

Kidder Mathews

Thad Mallory, SIOR
tmallory@kiddermathews.com
ph 206 248 7338
fax 206 248 7342
12886 Interurban Ave S
Seattle, WA 98168

Kidder Mathews

Tony Miltenberger, SIOR
tonym@kiddermathews.com
ph 206 248 7307
fax 206 248 7342
12886 Interurban Ave S
Seattle, WA 98168

Prologis

Rick Kolpa
rkolpa@prologis.com
ph 206 414 7610
fax 206 414 7601
12720 Gateway Dr, Ste 110
Tukwila, WA 98168