

FLEET INDUSTRIAL PARK

WAREHOUSE SPACE
FOR LEASE
ALEXANDRIA, VA 22310

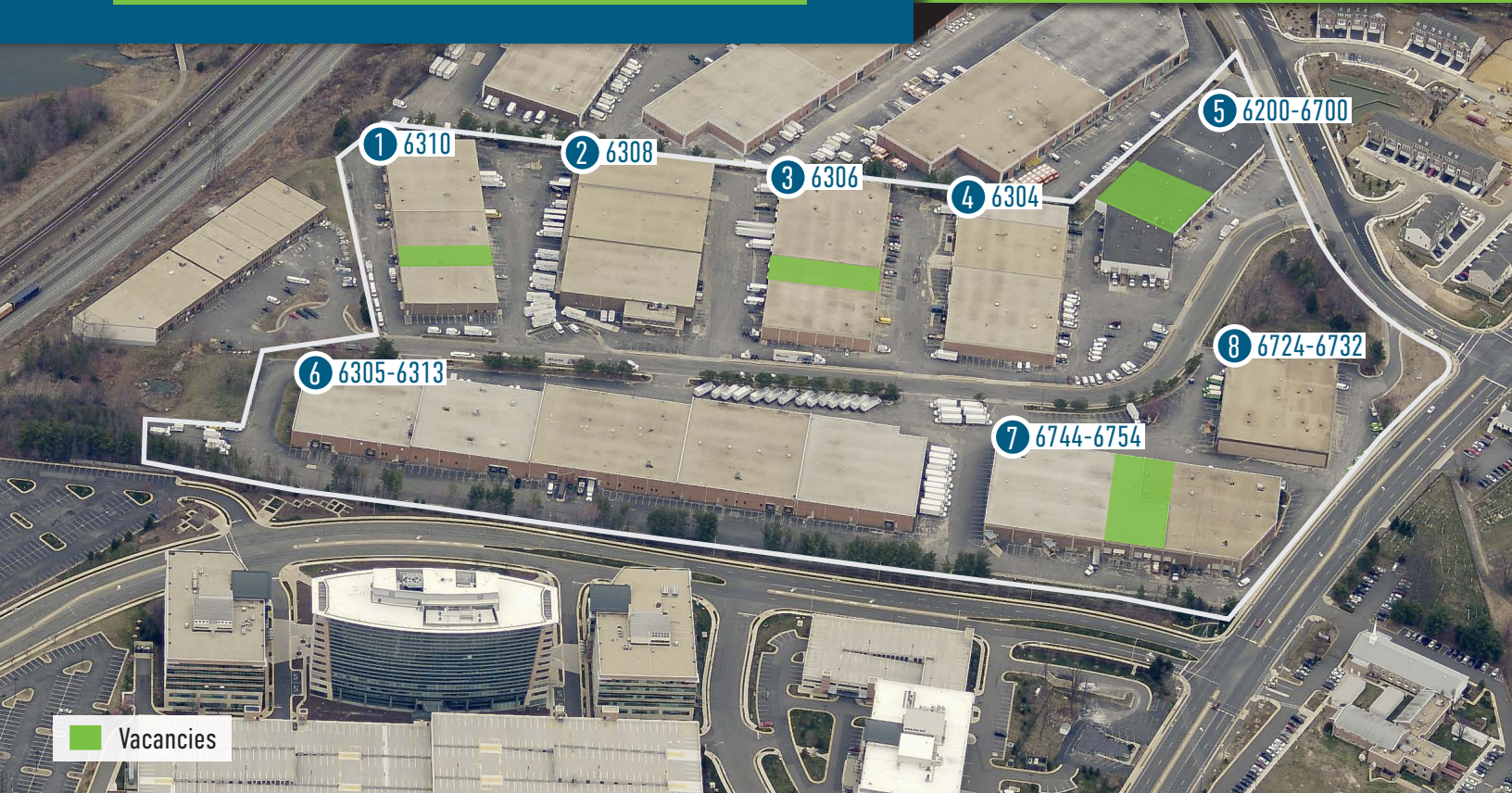

PARK OVERVIEW

Fleet Industrial Park is a 489,372 square foot business park consisting of 8 Industrial warehouse buildings. It is located in Alexandria, Virginia, just minutes from Interstate 95 and 495. The park offers clear heights ranging from 18 to 24 feet, and contains 63 loading docks and 50 drive-ins, creating a highly functional warehouse facility for industrial and flex users.



VELSOR PROPERTIES, LLC

PARK HIGHLIGHTS

- Allows for flexible tenant uses with 18' to 24' clear heights
- 63 loading docks
- 50 drive-in doors
- Average of 90' truck court radius
- Located just 13 miles south of Washington, DC and three miles from the "mixing bowl" where I-95, I-395 and I-495 join in Fairfax County
- Constructed of brick and block
- Built in 1971

Bob Gibbs

Executive Vice President
+1 703 905 0301
bob.gibbs@cbre.com

Tony Russo

Senior Vice President
+1 703 905 0210
tony.russo@cbre.com

Daniela Patino

Transaction Manager
+1 703 905 0303
daniela.patino@cbre.com

CBRE

FLEET INDUSTRIAL PARK

BUILDING 1
6310 GRAVEL AVENUE
ALEXANDRIA, VA 22310

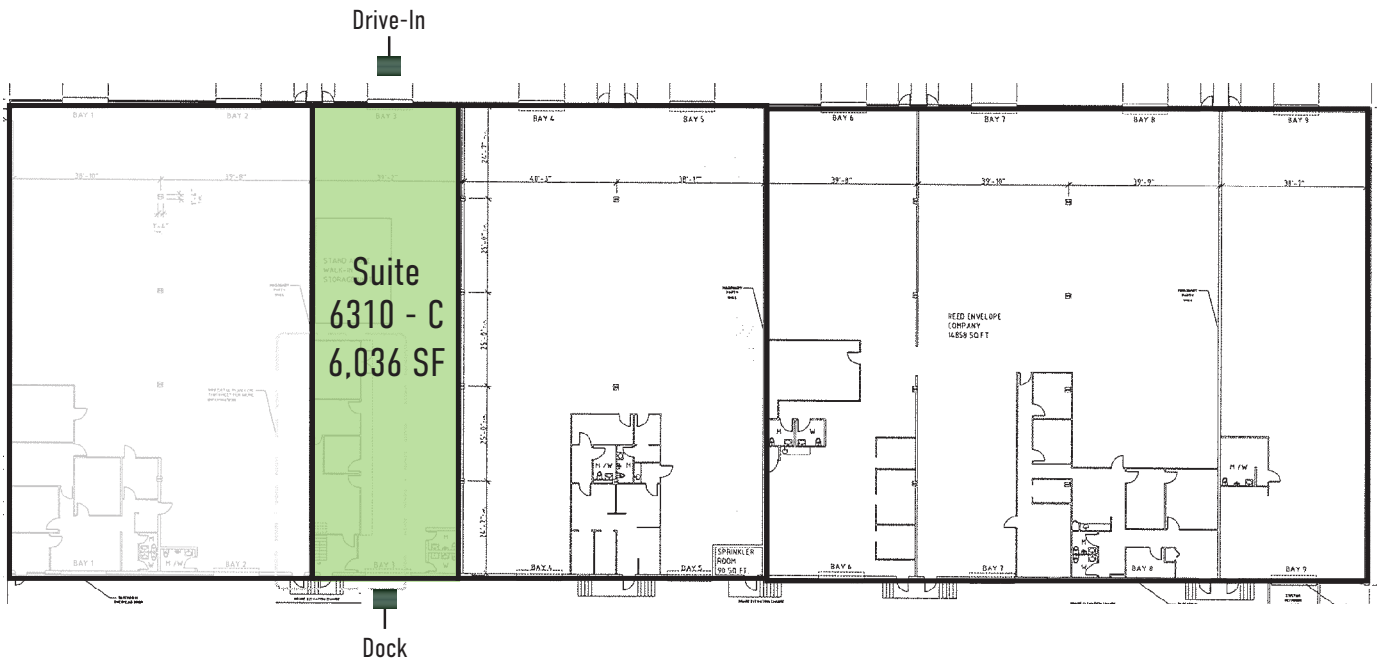

PROPERTY HIGHLIGHTS



Rental Rate:	\$9.50 NNN
Space:	Suite 6310-C: 6,036 SF
Parking:	1 per 1,000 SF
Column Spacing:	25' x 38'
Zoning:	I-4
Ceiling Height:	18'
Operating Expenses:	\$2.56 PSF
Loading:	One (1) Drive-In One (1) Dock

Bob Gibbs
Executive Vice President
+1 703 905 0301
bob.gibbs@cbre.com

Tony Russo
Senior Vice President
+1 703 905 0210
tony.russo@cbre.com

Daniela Patino
Transaction Manager
+1 703 905 0303
daniela.patino@cbre.com

CBRE

FLEET INDUSTRIAL PARK

BUILDING 3

6306 GRAVEL AVENUE
ALEXANDRIA, VA 22310

Available April 1st, 2020

Suite 6306-C

5,703 SF

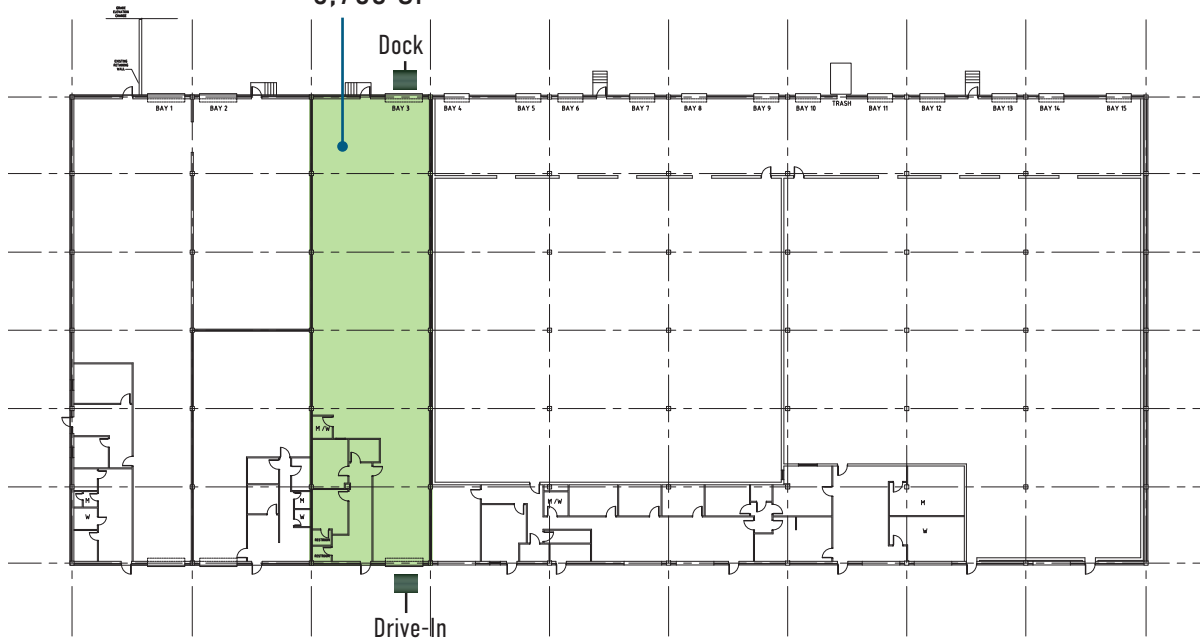

PROPERTY HIGHLIGHTS



Rental Rate:	\$9.50 NNN
Space:	Suite 6306-C: 5,703 SF
Parking:	1 per 1,000 SF
Column Spacing:	25' x 38'
Zoning:	I-4
Ceiling Height:	22'
Operating Expenses:	\$2.56 PSF
Loading:	One (1) Drive-In One (1) Dock

Bob Gibbs

Executive Vice President

+1 703 905 0301

bob.gibbs@cbre.com

Tony Russo

Senior Vice President

+1 703 905 0210

tony.russo@cbre.com

Daniela Patino

Transaction Manager

+1 703 905 0303

daniela.patino@cbre.com

CBRE

FLEET INDUSTRIAL PARK

BUILDING 5

6200-6700 GRAVEL AVENUE
ALEXANDRIA, VA 22310

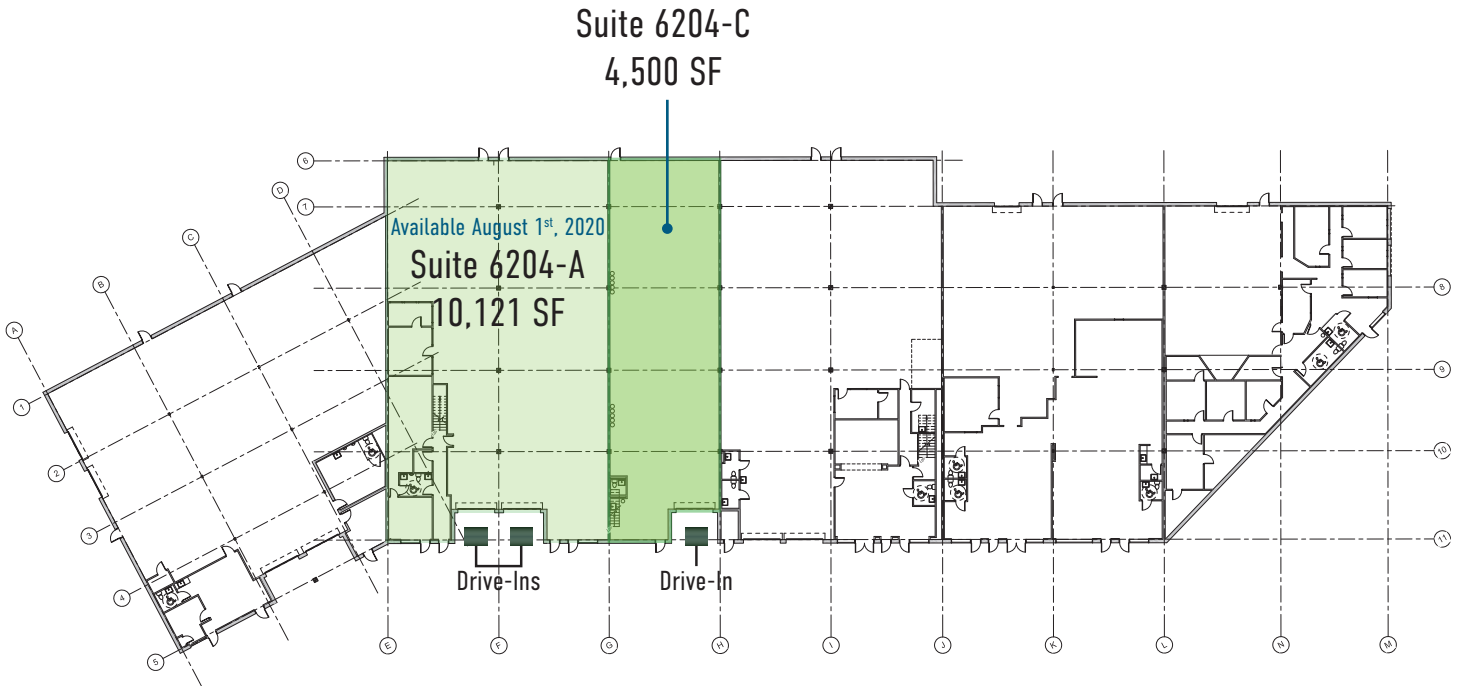

PROPERTY HIGHLIGHTS



Rental Rate:	\$11.50 NNN
Space:	Suite 6204-A: 10,121 SF Suite 6204-C: 4,500 SF
Parking:	Abundant
Column Spacing:	25' x 38'
Zoning:	I-4
Ceiling Height:	20'
Operating Expenses:	\$2.56 PSF
Loading:	Three (3) Drive-Ins

Bob Gibbs

Executive Vice President
+1 703 905 0301
bob.gibbs@cbre.com

Tony Russo

Senior Vice President
+1 703 905 0210
tony.russo@cbre.com

Daniela Patino

Transaction Manager
+1 703 905 0303
daniela.patino@cbre.com

CBRE

FLEET INDUSTRIAL PARK

BUILDING 7

6744-6757 GRAVEL AVENUE
ALEXANDRIA, VA 22310

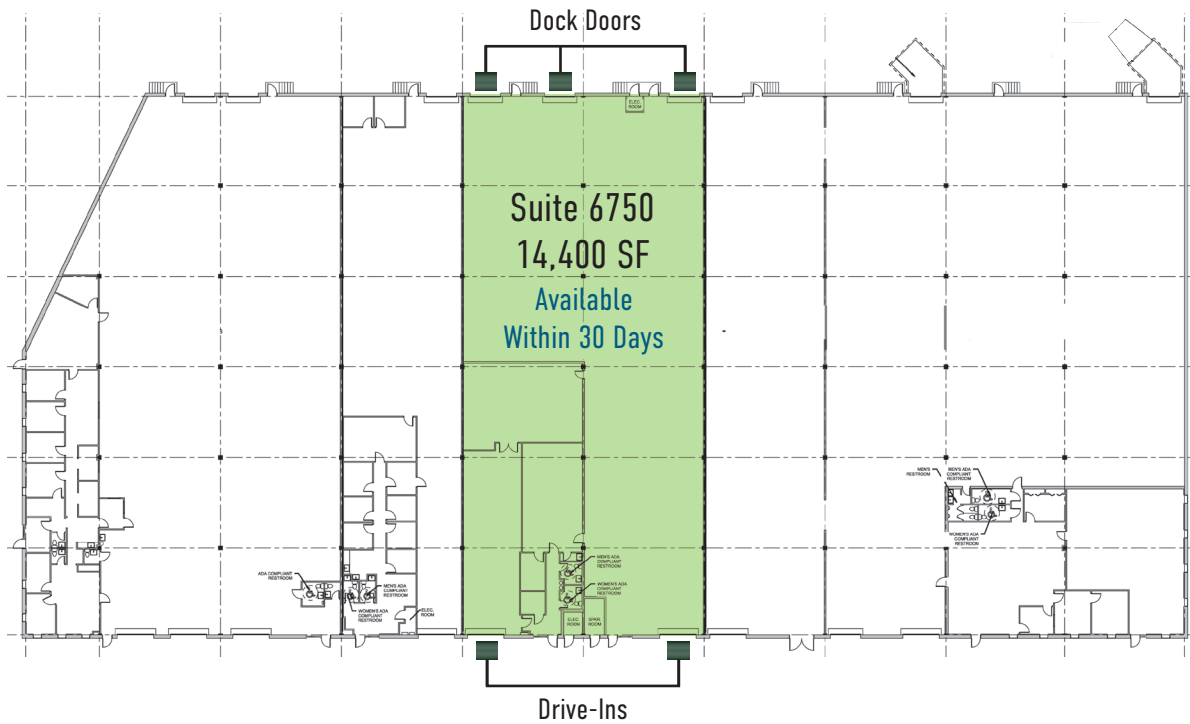

PROPERTY HIGHLIGHTS



Rental Rate:	\$9.50 NNN
Space:	Suite 6750: 14,400 SF └ Office: ±1,973 SF
Parking:	Abundant
Column Spacing:	25' x 38'
Zoning:	I-4
Ceiling Height:	20'
Operating Expenses:	\$2.56 PSF
Loading:	Three (3) Docks Two (2) Drive-Ins

Bob Gibbs

Executive Vice President
+1 703 905 0301
bob.gibbs@cbre.com

Tony Russo

Senior Vice President
+1 703 905 0210
tony.russo@cbre.com

Daniela Patino

Transaction Manager
+1 703 905 0303
daniela.patino@cbre.com

CBRE

FLEET INDUSTRIAL PARK

WAREHOUSE SPACE
FOR LEASE
ALEXANDRIA, VA 22310

Building Vacancies



LOCATION OVERVIEW

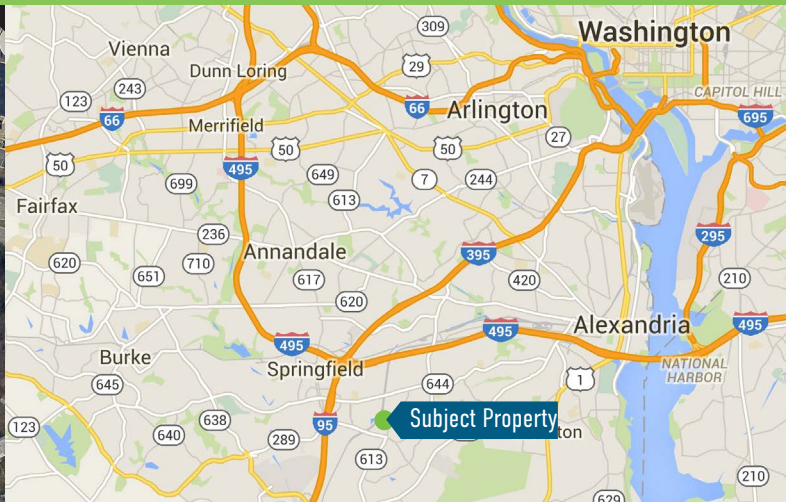

DISTANCE TO:

Interstate 95	2 Miles
Interstate 495	3 Miles
Interstate 66	11 Miles
Washington DC	13 Miles
Reagan National Airport	15 Miles
Dulles Toll Rd	15 Miles
Dulles International Airport	29 Miles

Bob Gibbs

Executive Vice President
+1 703 905 0301
bob.gibbs@cbre.com

Tony Russo

Senior Vice President
+1 703 905 0210
tony.russo@cbre.com

Daniela Patino

Transaction Manager
+1 703 905 0303
daniela.patino@cbre.com

CBRE

© 2020 CBRE, Inc. All rights reserved. This information has been obtained from sources believed reliable, but has not been verified for accuracy or completeness. You should conduct a careful, independent investigation of the property and verify all information. Any reliance on this information is solely at your own risk. CBRE and the CBRE logo are service marks of CBRE, Inc. All other marks displayed on this document are the property of their respective owners, and the use of such logos does not imply any affiliation with or endorsement of CBRE. Photos herein are the property of their respective owners. Use of these images without the express written consent of the owner is prohibited.