

McDowell Mountain Business Park | Executive Suites

FOR LEASE

±326 to 626 SQ. FT.

Executive Office Space

16420 N 92nd Street | Scottsdale, Arizona 85260

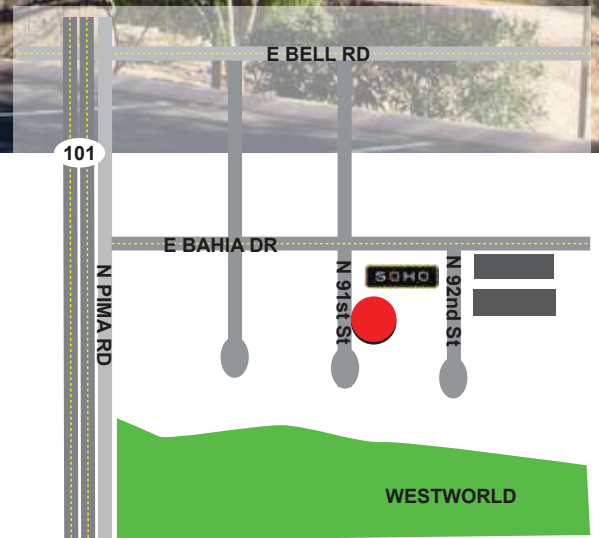

- Appealing architectural details
- Covered parking at a low monthly rate
- Twenty-four-hour monitored security system with controlled card access
- Easy access to Loop 101

For further property information or to schedule a tour please contact:



Randy Shell
Designated Broker
C 480.694.4100
O 480.443.3992
randy@shellcommercial.com



480 443 3992

480.443.3992 shellcommercial.com



16410 N 91st Street | Suite 112 | Scottsdale, Arizona 85260

The above is subject to prior sales and leasing. This information has been secured from sources we believe to be reliable, but we make no representation or warranties, expressed or implied as to the accuracy of this information.

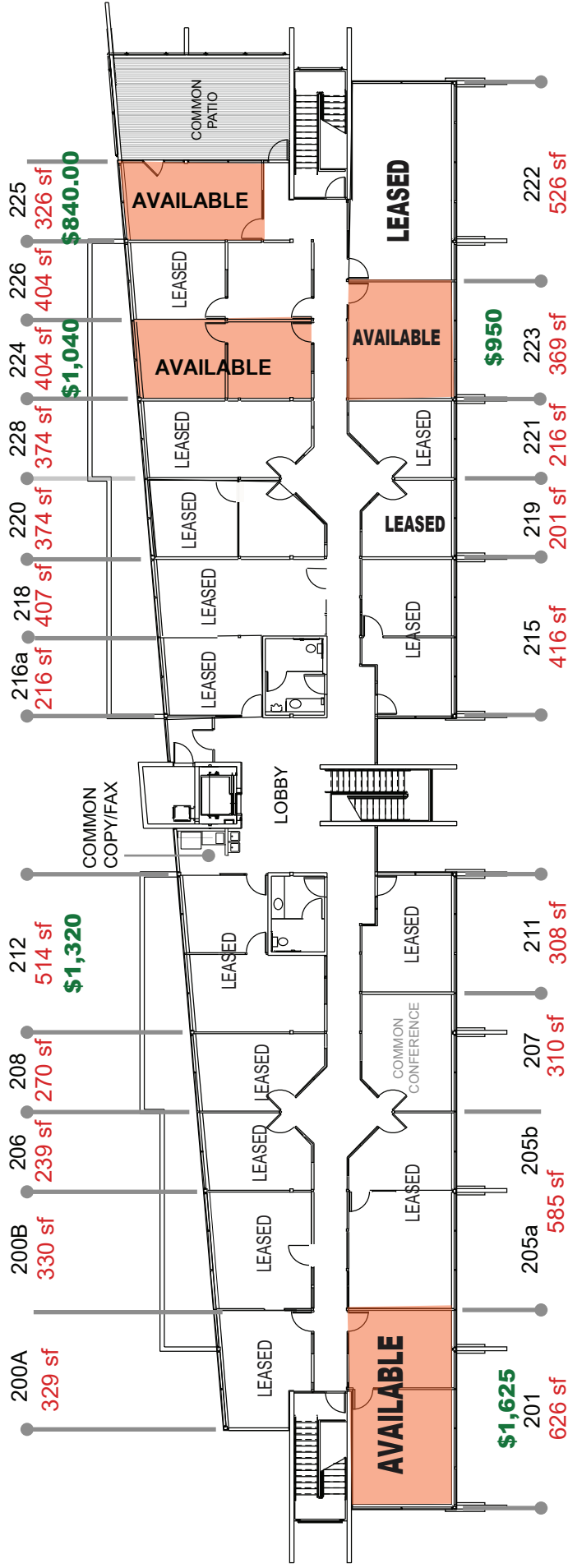

Features:

- Single or multiple office executive suites
- Class "A" build-out with hardwood wainscot and fabric on all office walls
- Suite entrances with 9' high wood doors and sidelites
- Wired for high-speed Internet and phone service (tenant's cost)
- Controlled card access to suites for security
- All utilities/janitorial included in rent (tenant responsible for phone/Internet)
- Copier machine (not for printing)
- Covered parking available \$35/month (based on availability)

