

# FOR LEASE

9915 Creviston Dr. NW  
Gig Harbor, WA 98329



## CREVISTON RETAIL

Lisa Tallman | Jamie Firth

First Western Properties—Tacoma Inc. | 253.472.0404  
6402 Tacoma Mall Blvd, Tacoma, WA 98409 | fwp-inc.com

9915 CREVISTON DR. NW:

PROPOSED 8,000 +/- SF \$24.00 PSF PLUS NNN

- Project Completion: Q2 2020
- Located in the Heart of the Key Peninsula Community
- Prominant location on Highway 302 and Creviston Drive
- Zoning: Rural 10
- Located across the street from new Pierce County Park facility



Population



Average HH Income

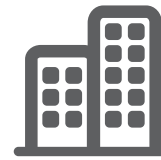

Daytime Population

Regis - 2019

	Population	Average HH Income	Daytime Population
Mile 1	3,552	\$118,192	1,518
Mile 3	13,447	\$114,909	6,226
Mile 5	37,090	\$122,660	19,898

NEARBY TENANTS

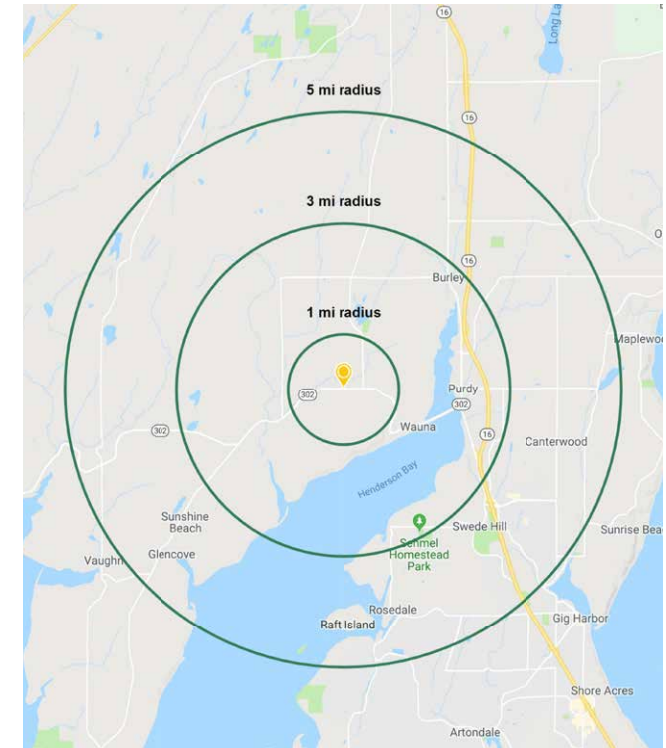



LOCATION DETAILS



Located on visible corner of Highway 302 & Creviston Drive



18,951 CPD Highway 302



3,071 CPD Creviston Drive NW



# SITE PLAN

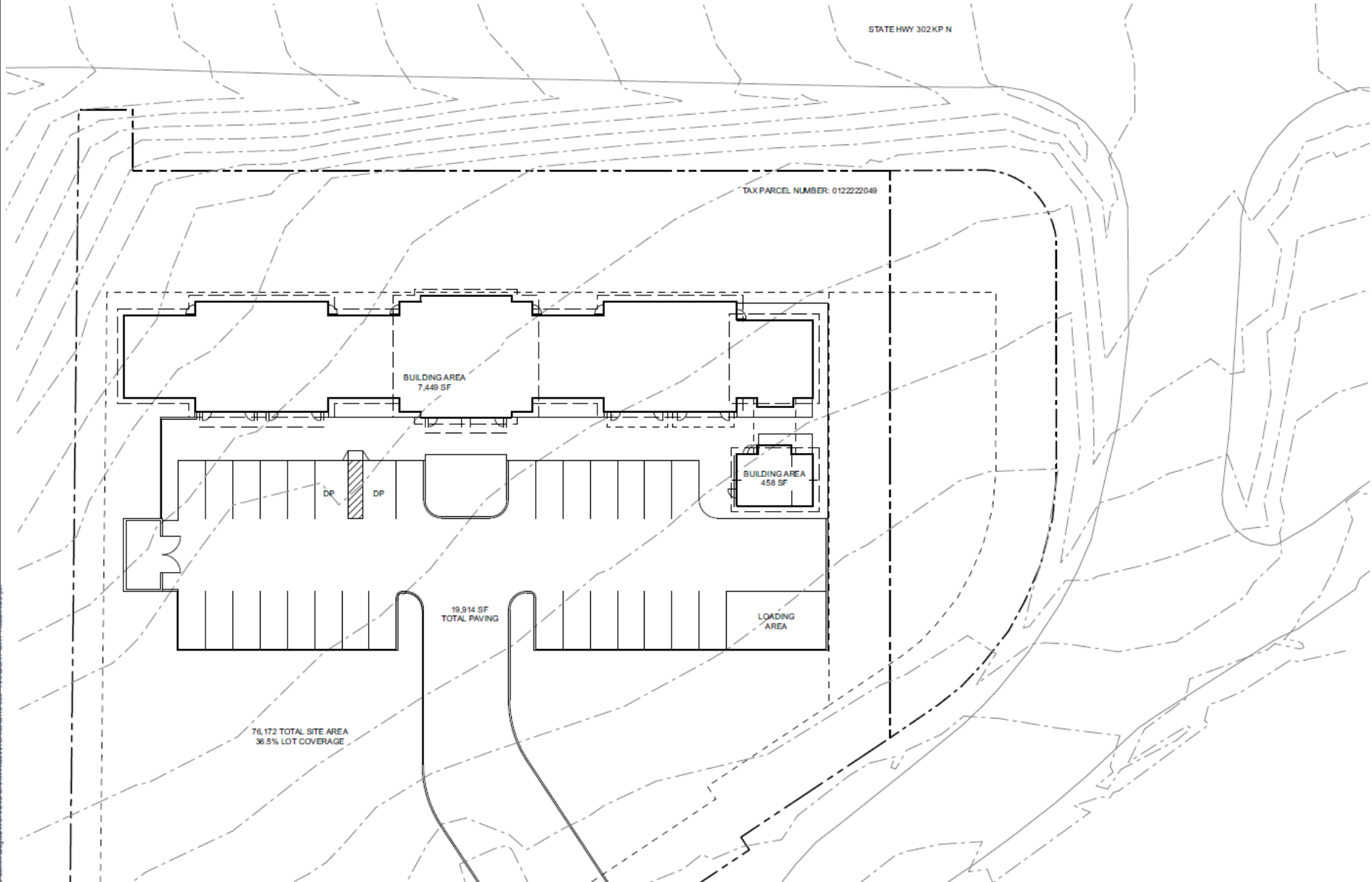









**GIG HARBOR, WA** is both a bay on the Puget Sound and a harbor town that has been named one of the Smithsonian Magazines Top Five Small Towns for culture, heritage and charm. Its unique location, close to metropolitan centers, yet positioned on a quiet, beautiful and historic peninsula - provides visitors and residents with excellent site-seeing, history, culture, dining, shopping and more.



TACOMA | KIRKLAND | PORTLAND | SEATTLE



**RETAIL FOCUSED. RESULTS DRIVEN.**

**LISA TALLMAN**

253.471.5504  
lisa@firstwesternproperties.com

**JAMIE FIRTH**

253.284.3649  
jamie@firstwesternproperties.com



First Western Properties—Tacoma Inc. | 253.472.0404  
6402 Tacoma Mall Blvd, Tacoma, WA 98409 | fwp-inc.com

© First Western Properties, Inc. DISCLAIMER: The above information has been secured from sources believed to be reliable, however, no representations are made to its accuracy. Prospective tenants or buyers should consult their professional advisors and conduct their own independent investigation. Properties are subject to change in price and/or availability without notice.