

4112

FOR LEASE
E. COMMERCE WAY
Sacramento, CA, 95834



**±1,380 SF
MEDICAL SPACE
AVAILABLE**

CHAD COOK, MCR, SIOR, CCIM

Senior Director
+1 916 764 1181
chad.cook@cushwake.com
CA LIC #01711687

ZACH MOSLE, CCIM

Senior Associate
+1 916 329 1543
zach.mosle@cushwake.com
CA LIC #0192459



400 CAPITOL MALL, SUITE 1800, SACRAMENTO, CA 95814

PROPERTY HIGHLIGHTS

Lease Rate: \$1.70-\$1.85/SF, NNN

- Former Quest Diagnostics
- Office / Medical Space Available
- Building and Monument Signage
- Nearby Restaurants and Shopping
- Immediate access to Interstate 5 & Interstate 80
- Abundant Parking
- Zoned EC-40



PROPERTY LOCATION



CONTACT INFO

CHAD COOK, MCR, SIOR, CCIM

Senior Director
+1 916 764 1181
chad.cook@cushwake.com
CA LIC #01711687

ZACH MOSLE, CCIM

Senior Associate
+1 916 329 1543
zach.mosle@cushwake.com
CA LIC #0192459

CUSHMAN & WAKEFIELD

400 Capitol Mall, Suite 1800
Sacramento, CA 95814
+1.916.288.4800

PROPERTY PHOTOS

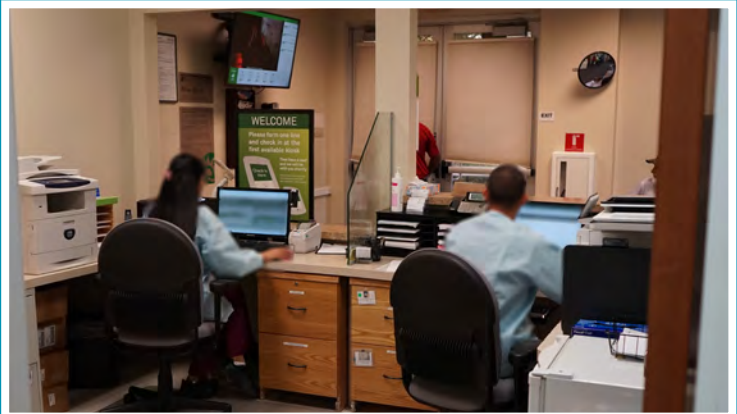
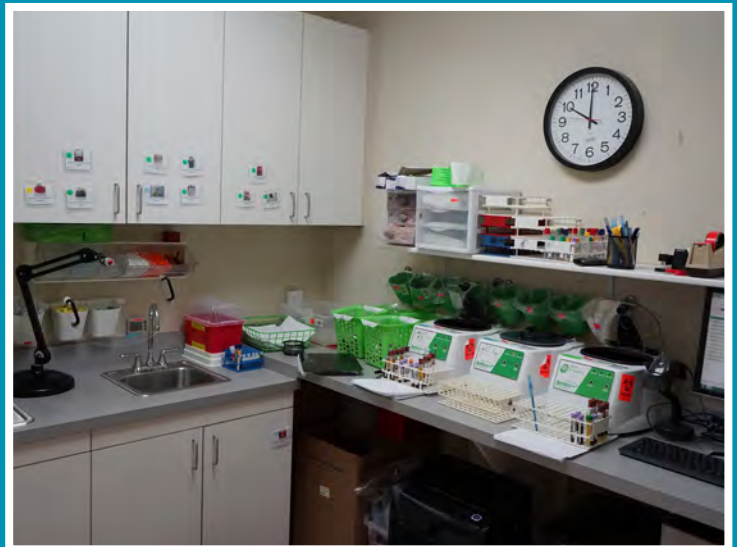

CONTACT INFO

CHAD COOK, MCR, SIOR, CCIM

Senior Director
+1 916 764 1181
chad.cook@cushwake.com
CA LIC #01711687

ZACH MOSLE, CCIM

Senior Associate
+1 916 329 1543
zach.mosle@cushwake.com
CA LIC #0192459



400 Capitol Mall, Suite 1800
Sacramento, CA 95814
+1.916.288.4800

FLOOR PLAN

±1,380 SF MEDICAL SPACE AVAILABLE

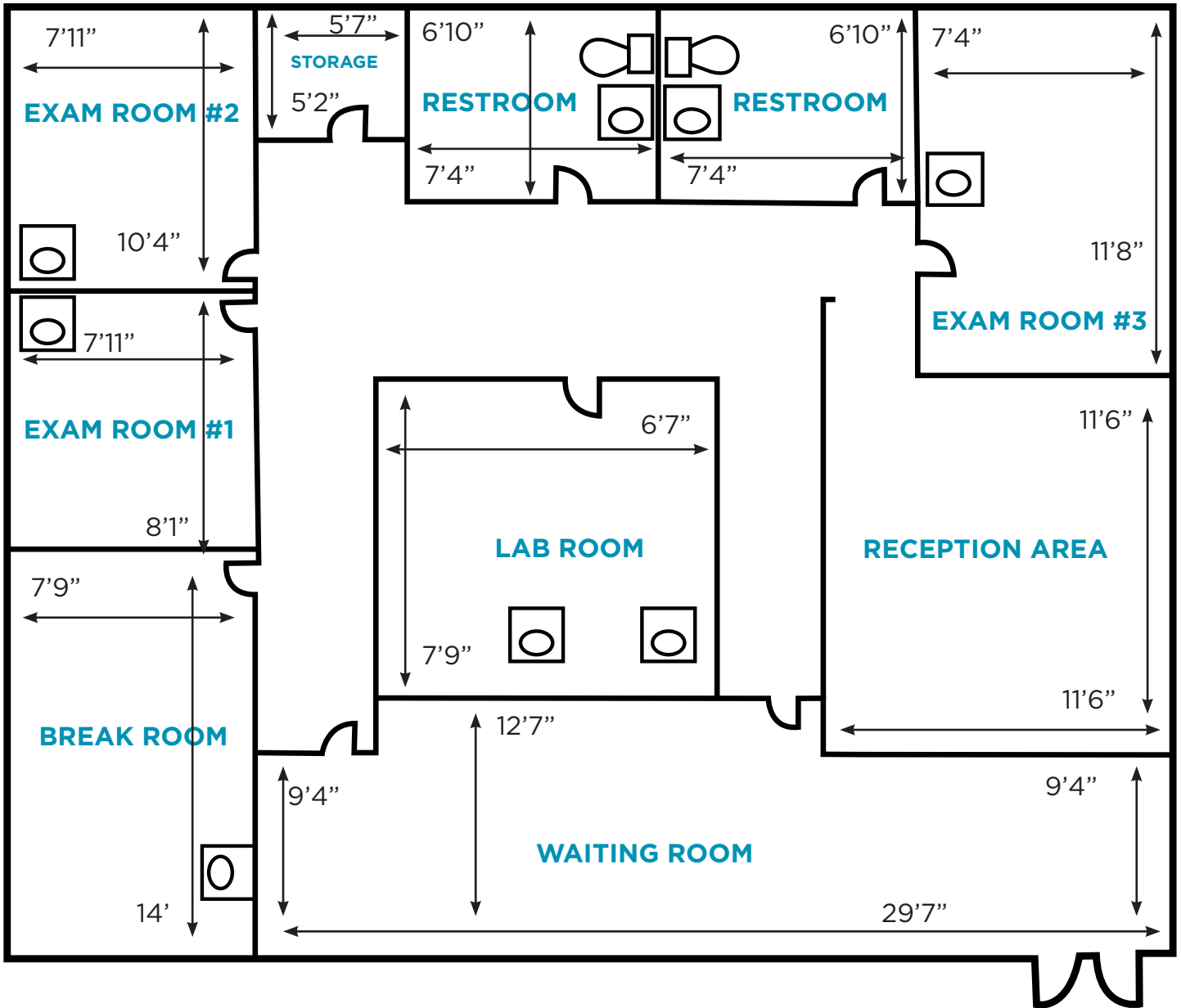

CONTACT INFO

CHAD COOK, MCR, SIOR, CCIM

Senior Director
+1 916 764 1181
chad.cook@cushwake.com
CA LIC #01711687

ZACH MOSLE, CCIM

Senior Associate
+1 916 329 1543
zach.mosle@cushwake.com
CA LIC #0192459



400 Capitol Mall, Suite 1800
Sacramento, CA 95814
+1.916.288.4800

AERIAL



CONTACT INFO

CHAD COOK, MCR, SIOR, CCIM

Senior Director
 +1 916 764 1181
 chad.cook@cushwake.com
 CA LIC #01711687

ZACH MOSLE, CCIM

Senior Associate
 +1 916 329 1543
 zach.mosle@cushwake.com
 CA LIC #0192459



400 Capitol Mall, Suite 1800
 Sacramento, CA 95814
 +1.916.288.4800