



# 18500 Via Princessa

Santa Clarita, California 91387

## Lease Highlights

- Part of a highly visible mixed-use retail/medical center
- Across from Costco & 24 Hour Fitness, adjacent to I-14 freeway on-ramp
- Surrounded by thousands of newly developed homes with limited commercial services
- Building signage available

## Property Description

Building C - Unit 2B | Medical clinic space with 7 exam rooms, X-Ray area, restroom, and business office

Building A - Suite 205 | Small 2nd floor office suite with private office, open area, and private restroom

## Available Spaces

Spaces	Lease Rate	Size (SF)
Building C - Unit 2B	\$2.25 SF/month	2,675
Building A - Suite 205	\$2.25 SF/month	638

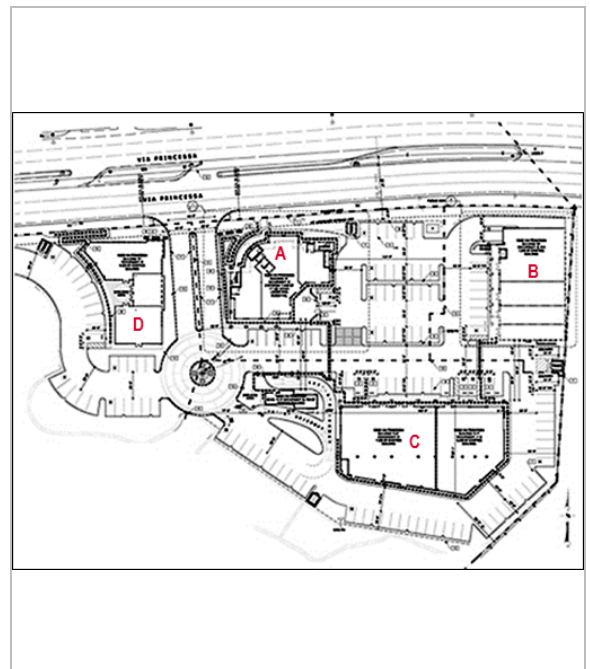

For more information

**Scott Crane**

O: 310.440.8500  
scrane@naicapital.com | CalDRE #00973713

**Peter Lund**

O: 310.440.8500  
plund@naicapital.com | CalDRE #01052090

No warranty, express or implied, is made as to the accuracy of the information contained herein. This information is submitted subject to errors, omissions, change of price, rental or other conditions, withdrawal without notice, and is subject to any special listing conditions imposed by our principals. Cooperating brokers, buyers, tenants and other parties who receive this document should not rely on it, but should use it as a starting point of analysis, and should independently confirm the accuracy of the information contained herein through a due diligence review of the books, records, files and documents that constitute reliable sources of the information described herein. Logos are for identification purposes only and may be trademarks of their respective companies. NAI Capital, Inc. CAL DRE Lic. #01990696.

**NAI Capital**

11835 W. Olympic Blvd. Ste. 700E  
Los Angeles, CA 90064  
310.440.8500

[naicapital.com](http://naicapital.com)



For Lease

# 18500 Via Princessa

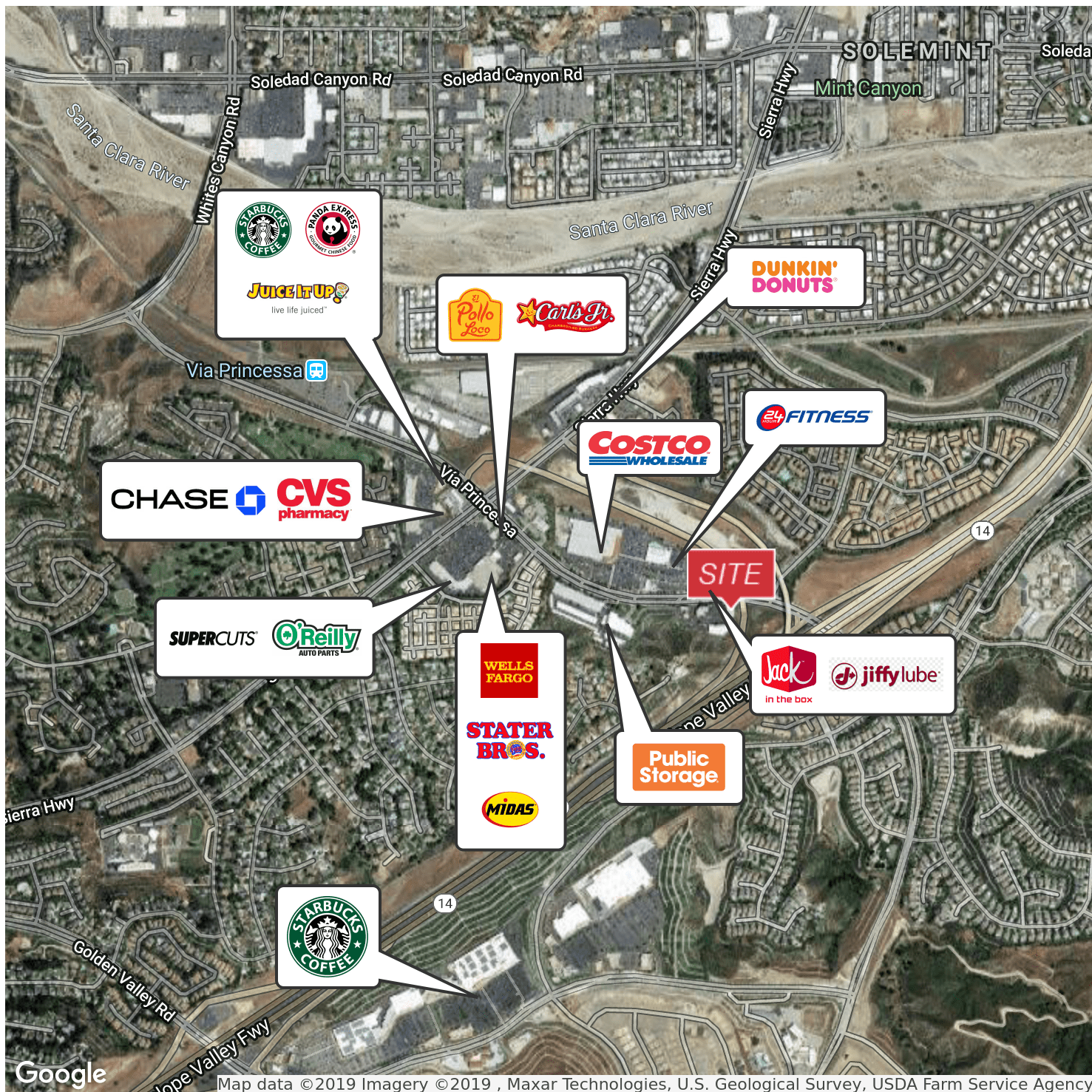

**Scott Crane**  
310.440.8500  
scrane@naicapital.com  
CalDRE #00973713

**Peter Lund**  
310.440.8500  
plund@naicapital.com  
CalDRE #01052090

For Lease

# 18500 Via Princessa

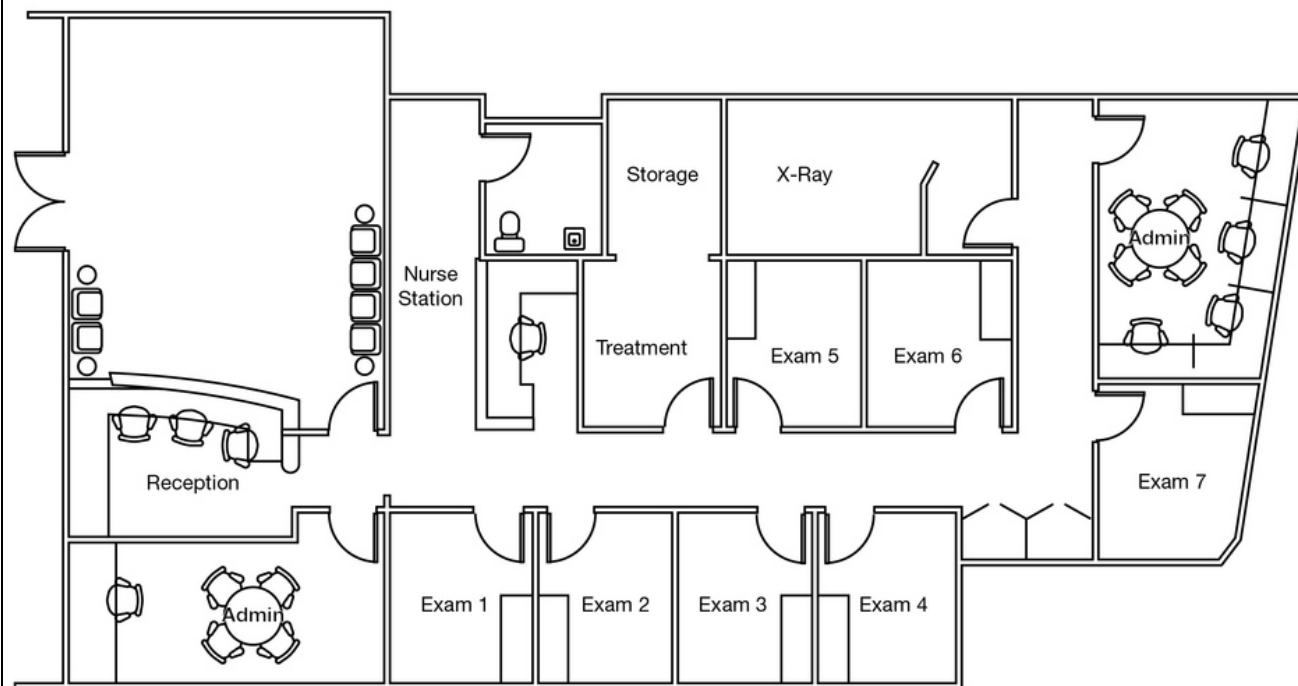

Building C - Unit 2B | Built-out medical space consisting of 7 exam rooms and X-ray area.

**Scott Crane**  
310.440.8500  
scrane@naicapital.com  
CalDRE #00973713

**Peter Lund**  
310.440.8500  
plund@naicapital.com  
CalDRE #01052090