

EAST AURORA OFFICE BUILDING FOR LEASE

PROFESSIONAL OFFICE SPACE AVAILABLE

FEATURES	
Building Size	6,820 ± Sq. Ft.
Available for Lease	1,750 – 4,500 ± Sq. Ft.
Parking	Surface Lot
Lot Size	1.37 ± Acres
Zoning	Commercial

Property Highlights

- Professional office available for lease
- Turn-key office with furniture and work stations in place
- Nice finishes throughout
- Surface lot parking on-site
- Located within two (2) miles of the East Aurora Traffic Circle
- Proximate to Transit Road, Route 400, Knox State Farm, and Moog
- Ideal for: professional office, medical office, accountant, retail, financial planner, insurance, daycare provider, engineering firm



For more information, contact:

DAVID P. SEIDER
Real Estate Salesperson
 716.570.9086 - cell
dseider@pyramidbrokerage.com

14 Lafayette Square
 Suite 1900
 Buffalo, New York 14203
 phone: +1 716 852-7500

pyramidbrokerage.com

DEMOGRAPHIC	1 MILE	3 MILE	5 MILE
Population	785	13,610	46,210
Average Household Income	\$107,107	\$103,260	\$110,467

FOR LEASE
7625 Seneca Street
East Aurora, New York

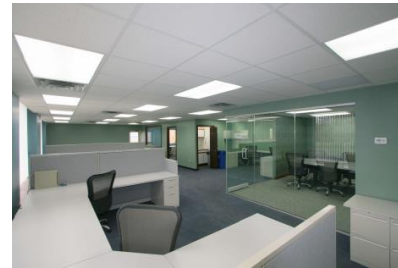
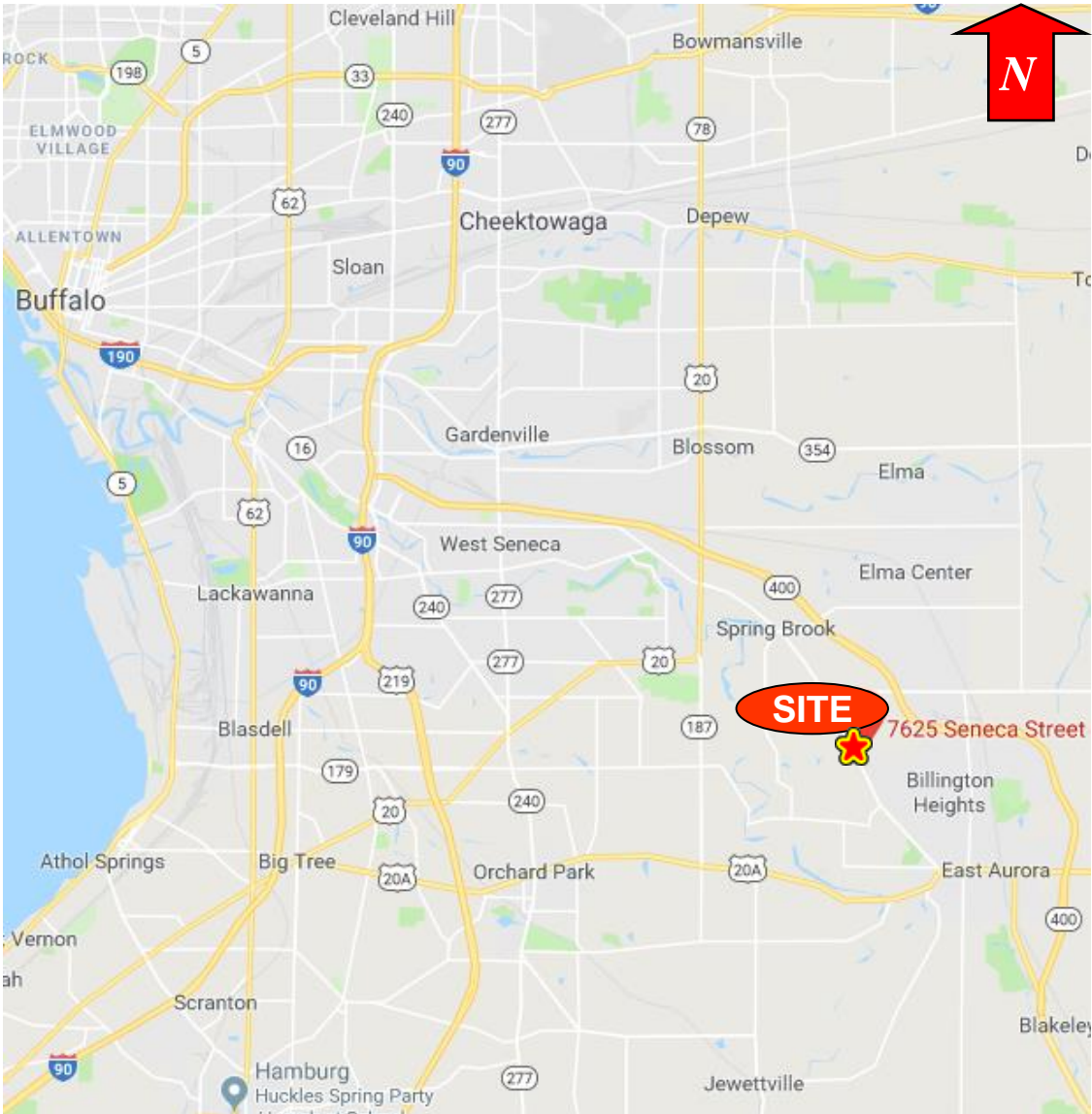

Location Map

Interior Photos