

24645 PLYMOUTH ROAD
 REDFORD, MICHIGAN

RETAIL / INDUSTRIAL FOR SALE
 17,253 Square Feet Available



SIGNATURE ASSOCIATES
 KNOW SIGNATURE | KNOW RESULTS



PROPERTY FEATURES

- 17,253 available square feet
- 800 square feet of office space
- 30' ceiling height
- Currently operating as a collision shop and used car lot
- (3) grade level doors
- Zoned C-2
- 1.25 acres with fenced yard
- 100+ car parking
- Sale Price: \$1,200,000 (\$69.55/sf)



For more information, please contact:

JUSTIN GAFFREY
 (248) 799 3143
 jgaffrey@signatureassociates.com

JASON KELMIGIAN
 (248) 359 0629
 jkelmigian@signatureassociates.com

SIGNATURE ASSOCIATES
 One Towne Square, Suite 1200
 Southfield, MI 48076
 www.signatureassociates.com

24645 Plymouth Road – Redford, Michigan

Retail / Industrial For Sale

17,253
Square Feet
AVAILABLE



DEMOGRAPHICS

	POPULATION	MED. HH INCOME
1 MILE	13,018	\$54,111
3 MILE	105,788	\$52,321
5 MILE	326,254	\$54,657

TRAFFIC COUNTS (TWO-WAY)

58,642	Telegraph Rd. N. of Plymouth Rd. 2-Way
64,992	Telegraph Rd. S. of Plymouth Rd. 2-Way
18,025	Plymouth Rd. W. of Telegraph Rd. 2-Way
13,593	Plymouth Rd. E. of Telegraph Rd. 2-Way



For more information, please contact:

JUSTIN GAFFREY
(248) 799 3143
jgaffrey@signatureassociates.com

JASON KELMIGIAN
(248) 359 0629
jkelmigian@signatureassociates.com

SIGNATURE ASSOCIATES
One Towne Square, Suite 1200
Southfield, MI 48076
www.signatureassociates.com

24645 Plymouth Road – Redford, Michigan

Retail / Industrial For Sale

17,253
Square Feet
AVAILABLE

Site Plan

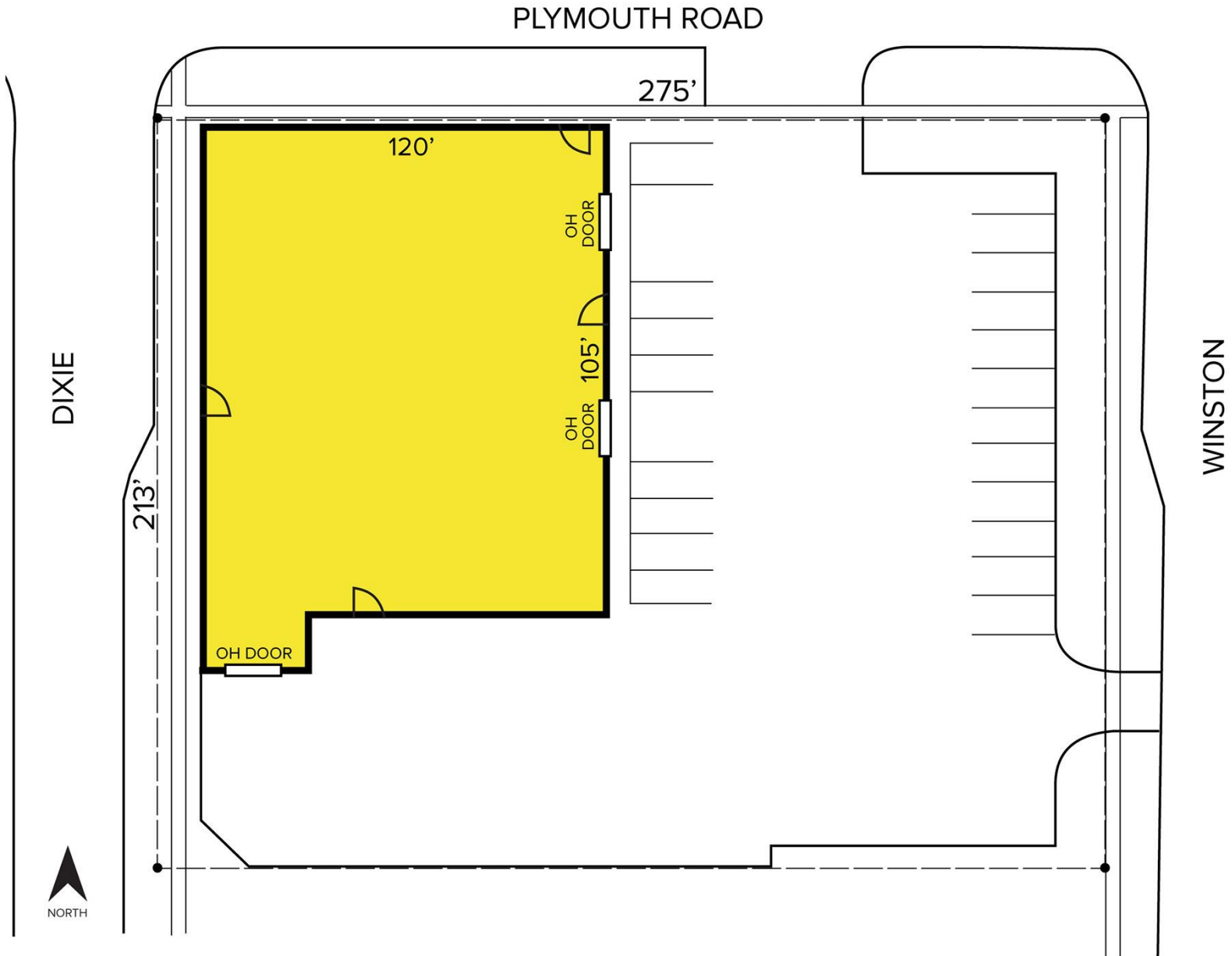

For more information, please contact:

JUSTIN GAFFREY
(248) 799 3143
jgaffrey@signatureassociates.com

JASON KELMIGIAN
(248) 359 0629
jkelmigian@signatureassociates.com

SIGNATURE ASSOCIATES
One Towne Square, Suite 1200
Southfield, MI 48076
www.signatureassociates.com