

Oceanic Business Park

3800 - 3840 Oceanic Drive
Oceanside, CA 92056

Industrial suite for lease
1,767 SF

Grade-level loading
(12' x 14' door)

Common loading dock and
concrete loading area

Clear height 18' minimum

120/208 volt, 3 phase power

3.0/1,000 SF parking ratio

Built in 2004



Location



Contact

Bob Willingham, SIOR
858.369.3013
bobw@kiddermathews.com
LIC #01469841

Ronald L. King, SIOR
858.369.3011
rking@kiddermathews.com
LIC #00868661

Oceanic Business Park



Availability

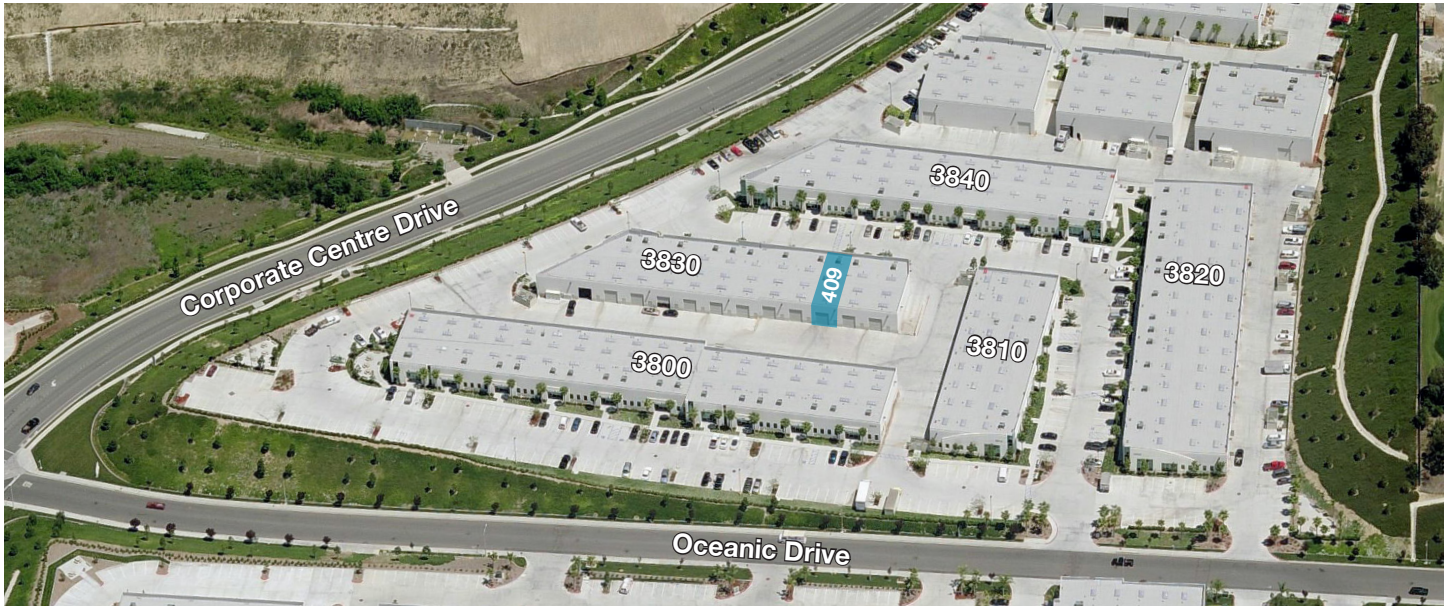

UNIT	SQUARE FEET	MONTHLY RATE PSF	AVAILABLE	DESCRIPTION
3830 Oceanic Drive, Unit 409	1,767 SF	\$0.99/SF*	Now	40% office, 60% warehouse, 2 private offices, reception area, restroom

*Plus \$0.11 per month for CAM.

Contact

Bob Willingham, SIOR
 858.369.3013
 bobw@kiddermathews.com
 LIC #01469841

Ronald L. King, SIOR
 858.369.3011
 rking@kiddermathews.com
 LIC #00868661

Floor Plan

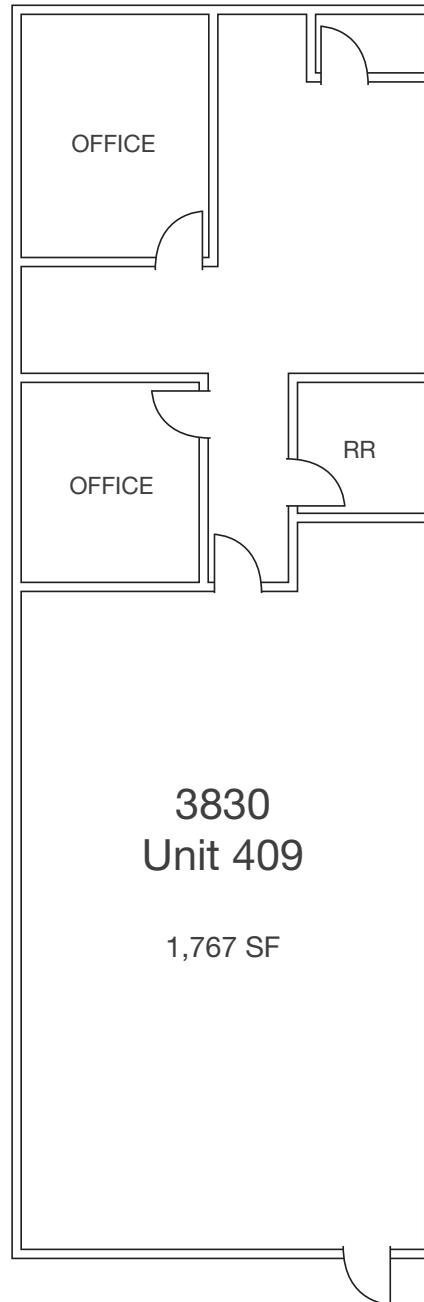

Contact

Bob Willingham, SIOR
858.369.3013
bobw@kiddermathews.com
LIC #01469841

Ronald L. King, SIOR
858.369.3011
rking@kiddermathews.com
LIC #00868661