

59,403 SF



Industrial Space For Lease



Prologis Park Kent 7

5630 South 226th Street
Kent, WA 98032 USA



LOCATION

- Strategic distribution location
- Excellent access to I-5 and SR-167
- Just minutes from SeaTac International Airport

FACILITY

- Total building size: 117,620 s.f.
- Total available: 59,403 s.f., office space: 2,978 s.f.
- Divisible to 21,652 s.f. w/1,227 s.f. office or 37,751 s.f. w/1,751 s.f. office
- Available Now
- 26' clear height
- 13 dock high doors (12 with dock seals), 7 EOD levelers and 2 dock locks with back up lights
- 1 grade level door
- ESFR sprinkler system
- Skylights
- Corporate image

ADVANTAGES AND AMENITIES

- Multiple space configurations

59,403 SF

Industrial Space For Lease

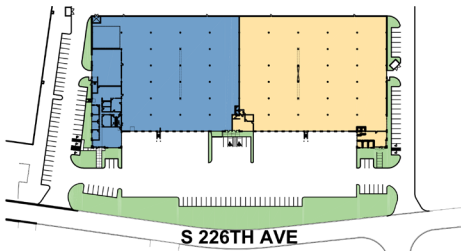

VAN DOREN'S LANDING #3
OVERALL PLAN
NTS

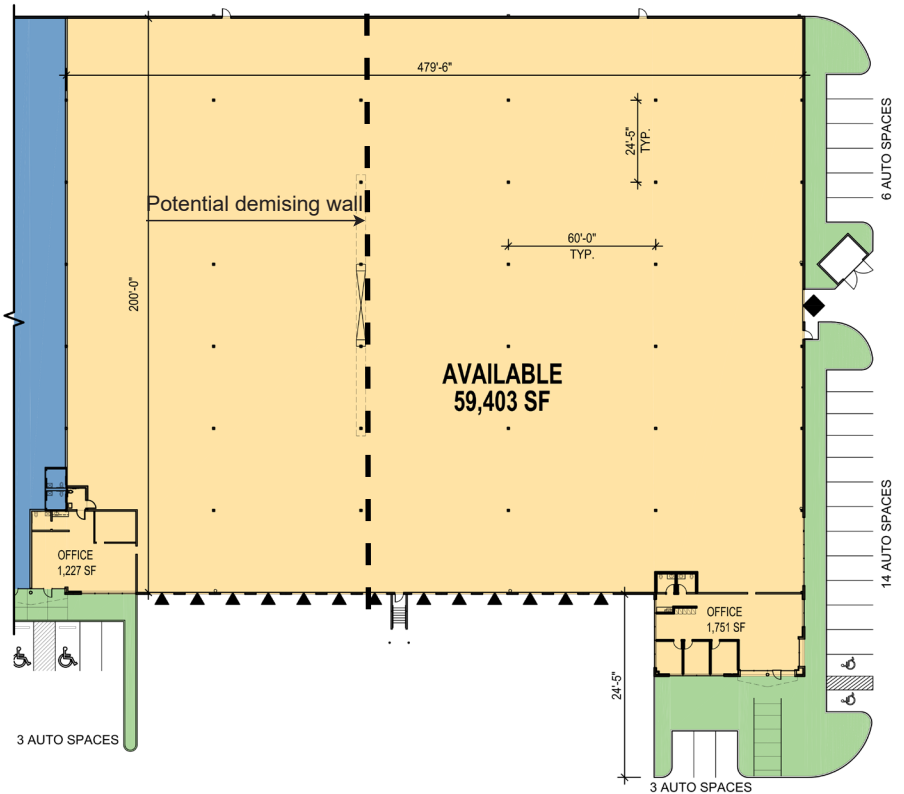

SITE PLAN



NOTE: THIS CONCEPTUAL PLAN IS FOR MARKETING PURPOSES ONLY AND HAS BEEN PREPARED BASED ON PRELIMINARY AVAILABLE SITE INFORMATION DEEMED RELIABLE. ALL DIMENSION AREA CALCULATIONS ARE SUBJECT TO VERIFICATION BY A PROFESSIONAL ENGINEER FOR COMPLIANCE WITH ALL FEDERAL, STATE, AND LOCAL REGULATIONS.



JLL
David Cahill
david.cahill@am.jll.com
ph +1 425 974 4002
cell +1 206 930 5599
225 108th Avenue NE
Suite 550
Bellevue, WA 98004 USA

JLL
Scott Carter
scott.carter@am.jll.com
ph +1 425 974 4004
cell +1 425 761 5880
225 108th Avenue NE
Suite 550
Bellevue, WA 98004 USA

JLL
Les Boudwin, SIOR
les.boudwin@am.jll.com
ph +1 425 974 4023
cell +1 206 679 6393
225 108th Avenue NE
Suite 550
Bellevue, WA 98004 USA

Prologis
Rick Kolpa
rkolpa@prologis.com
ph +1 206 414 7610
cell +1 206 949 5681
12720 Gateway Drive
Suite 110
Tukwila, WA 98168 USA