



3000 Lincoln Drive East

Marlton, New Jersey

Property Description

- 4,900± SF office suite available for lease
- Private entrance
- Within a 65,056± SF one-story office/flex building
- Situated on 5.31± acres
- Constructed in 1982
- Ceiling heights 10'
- Gas heat
- City water and sewer
- Ideal for professional or medical office



LEASE RATE: NEGOTIABLE

For more information:

Rebecca Ting, SIOR

+1 856 234 9600 • rebecca.ting@naimertz.com

Julie Kronfeld, SIOR

+1 856 802 6516 • julie.kronfeld@naimertz.com

Fred Meyer, SIOR

+1 856 802 6515 • fred.meyer@naimertz.com

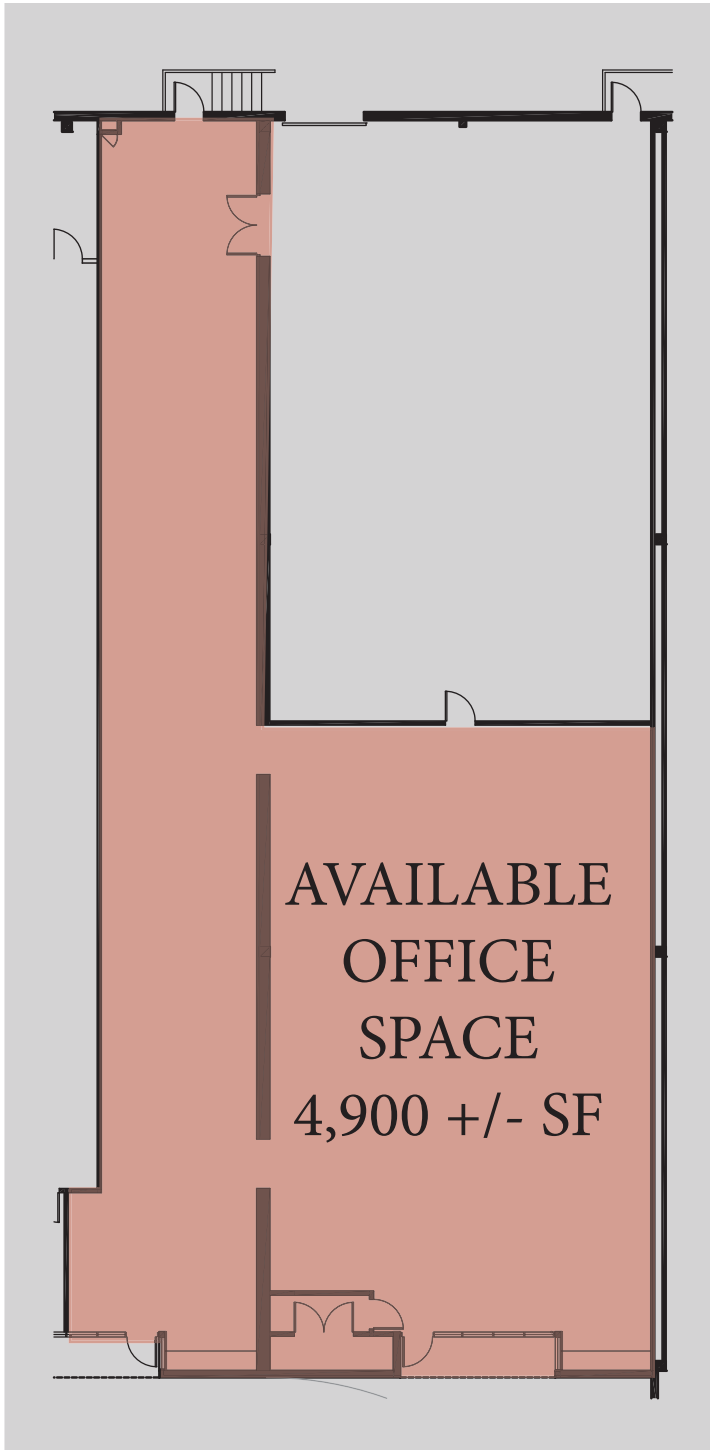

For more
information:

Rebecca Ting, SIOR
+1 856 234 9600
rebecca.ting@naimertz.com

Julie Kronfeld, SIOR
+1 856 802 6516
julie.kronfeld@naimertz.com

Fred Meyer, SIOR
+1 856 802 6515
fred.meyer@naimertz.com

Location
3000 Lincoln Drive East, Marlton, NJ



Location Information

- Located just off Route 73 in Greentree North Corporate Center
- Minutes from NJ Turnpike (Exit 4), I-295 (Exit 34) and Routes 38 & 70
- Within 25 minutes of Center City Philadelphia and Philadelphia International Airport

Within 1 Mile of 3000 Lincoln Drive East

Lodging

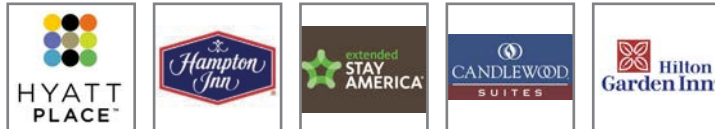

Dining

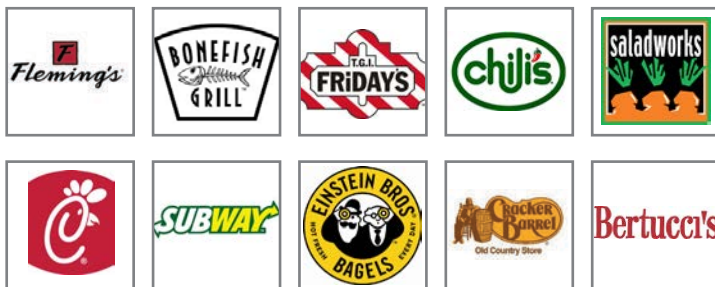

Shopping & Services



Distance to Other Nearby Amenities:

The Promenade at Sagemore	3.0 mi
Moorestown Mall	3.2 mi
Cherry Hill Mall	6.0 mi
Centreton Square	6.2 mi
Center City Philadelphia	13.0 mi
Philadelphia Airport	25.0 mi
Atlantic City Airport	44.5 mi

For more information:

Rebecca Ting, SIOR
+1 856 234 9600
rebecca.ting@naimertz.com

Julie Kronfeld, SIOR
+1 856 802 6516
julie.kronfeld@naimertz.com

Fred Meyer, SIOR
+1 856 802 6515
fred.meyer@naimertz.com



21 Roland Avenue
Mount Laurel, New Jersey
+1 856 234 9600
naimertz.com