

AVAILABLE FOR LEASE
1419-1433 JEFFREY DRIVE
Addison, Illinois



BUILDING SPECIFICATIONS

BUILDING SIZE:	38,512 SF
CEILING HEIGHT:	16'
YEAR BUILT:	1987
PARKING:	2.60 / 1,000 SF
LOADING:	Three (3) Common Docks One (1) Common Drive-in Door
PROPERTY TAXES:	\$1.47 PSF (2018)
OPERATING EXPENSES:	\$1.25 PSF (2018 Estimated)
COMMENTS:	<ul style="list-style-type: none">Low DuPage County TaxesEasy Access to I-355Perfect for Flex User

INDUSTRIAL CONDO SPECIFICATIONS

	Unit 1427
AVAILABLE SPACE:	9,191 SF
OFFICE AREA:	1,426 SF
POWER:	200 A @ 120/480 V
LEASE RATE:	\$5.75 PSF Net



Jay C. Farnam
Senior Vice President
jfarnam@lee-associates.com
D 773.355.3029

Michael J. Plumb
Principal
mplumb@lee-associates.com
D 773.355.3019

All information furnished regarding property for sale, rental or financing is from sources deemed reliable, but no warranty or representation is made to the accuracy thereof and same is submitted to errors, omissions, change of price, rental or other conditions prior to sale, lease or financing or withdrawal without notice. No liability of any kind is to be imposed on the broker herein.

AVAILABLE FOR LEASE
1419-1433 JEFFREY DRIVE
Addison, Illinois

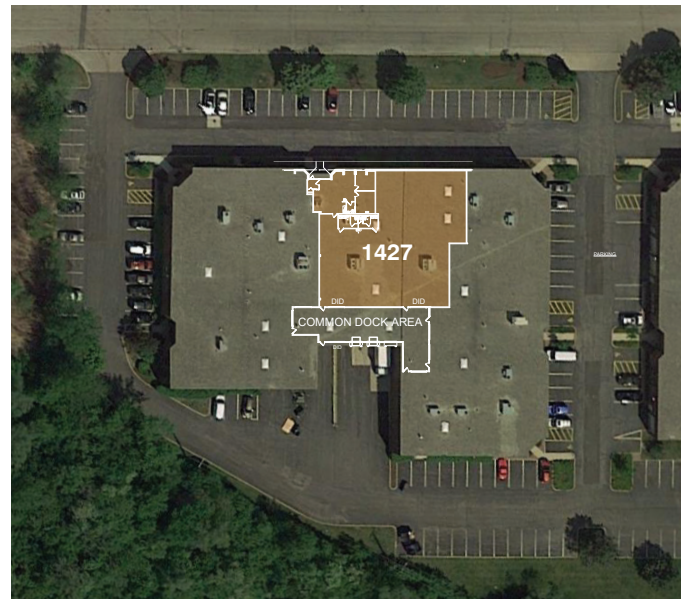
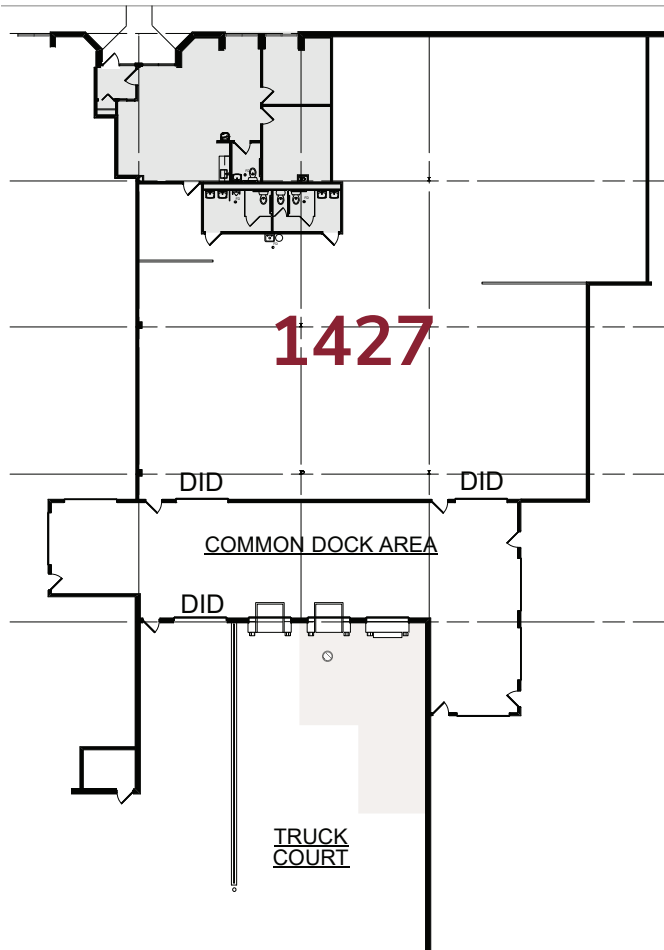

Jay C. Farnam
Senior Vice President
jfarnam@lee-associates.com
D 773.355.3029

Michael J. Plumb
Principal
mplumb@lee-associates.com
D 773.355.3019

All information furnished regarding property for sale, rental or financing is from sources deemed reliable, but no warranty or representation is made to the accuracy thereof and same is submitted to errors, omissions, change of price, rental or other conditions prior to sale, lease or financing or withdrawal without notice. No liability of any kind is to be imposed on the broker herein.