

Willow Creek
Corporate
Center

BUILDING D

10785 Willows Road NE
Redmond, Washington

FOR LEASE



Willow Creek Corporate Center



TRAILS

Expansive trail system runs right behind Willow Creek Corporate Center



VIEWS

Sweeping views of the Sammamish Valley & Willows Run Golf Course



SETTING

High-tech business park environment with nicely built-out office finishes

FOR LEASE | 17,457 SF

Office Space Available

Floor	Size	Available	Description
2	17,457 SF	NOW	Second floor space, mix of wide open areas and private offices



FIBER

Comcast High Speed Ethernet Fiber



PARKING

3/1,000 SF parking ratio



ON-SITE

Showers & lockers



FOOD

Minutes from downtown Redmond restaurants

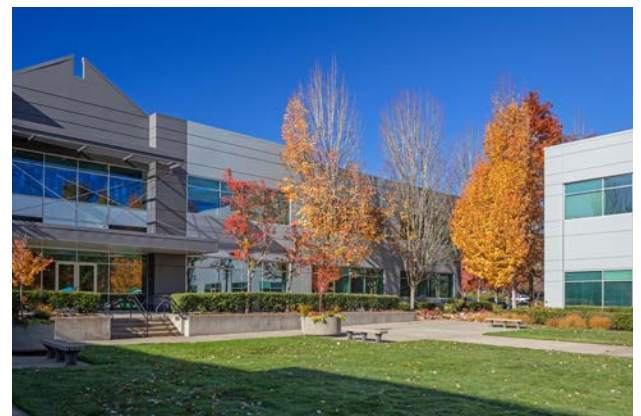

For more information, please contact:



10500 NE 8th Street, Suite 900
Bellevue, Washington 98004

broderickgroup.com

Paul Jerue
425.646.5223
jerue@broderickgroup.com

Tyler Slone
425.274.4281
slone@broderickgroup.com

Eric Meussner
425.274.4282
meussner@broderickgroup.com

The information contained herein has been given to us by the owner or sources which we deem reliable. We have no reason to doubt its accuracy, but we do not guarantee it. Prospective tenants should carefully verify all information contained herein.

SECOND FLOOR

17,457 RSF

AVAILABLE NOW

 [VIEW MATTERPORT](#)



↓ *Willows Golf Course*



For more information, please contact:



10500 NE 8th Street, Suite 900
Bellevue, Washington 98004

broderickgroup.com

Paul Jerue
425.646.5223
jerue@broderickgroup.com

Tyler Slone
425.274.4281
slone@broderickgroup.com

Eric Meussner
425.274.4282
meussner@broderickgroup.com

SECOND FLOOR - FURNITURE PLAN

17,457 RSF

AVAILABLE NOW

 [VIEW MATTERPORT](#)

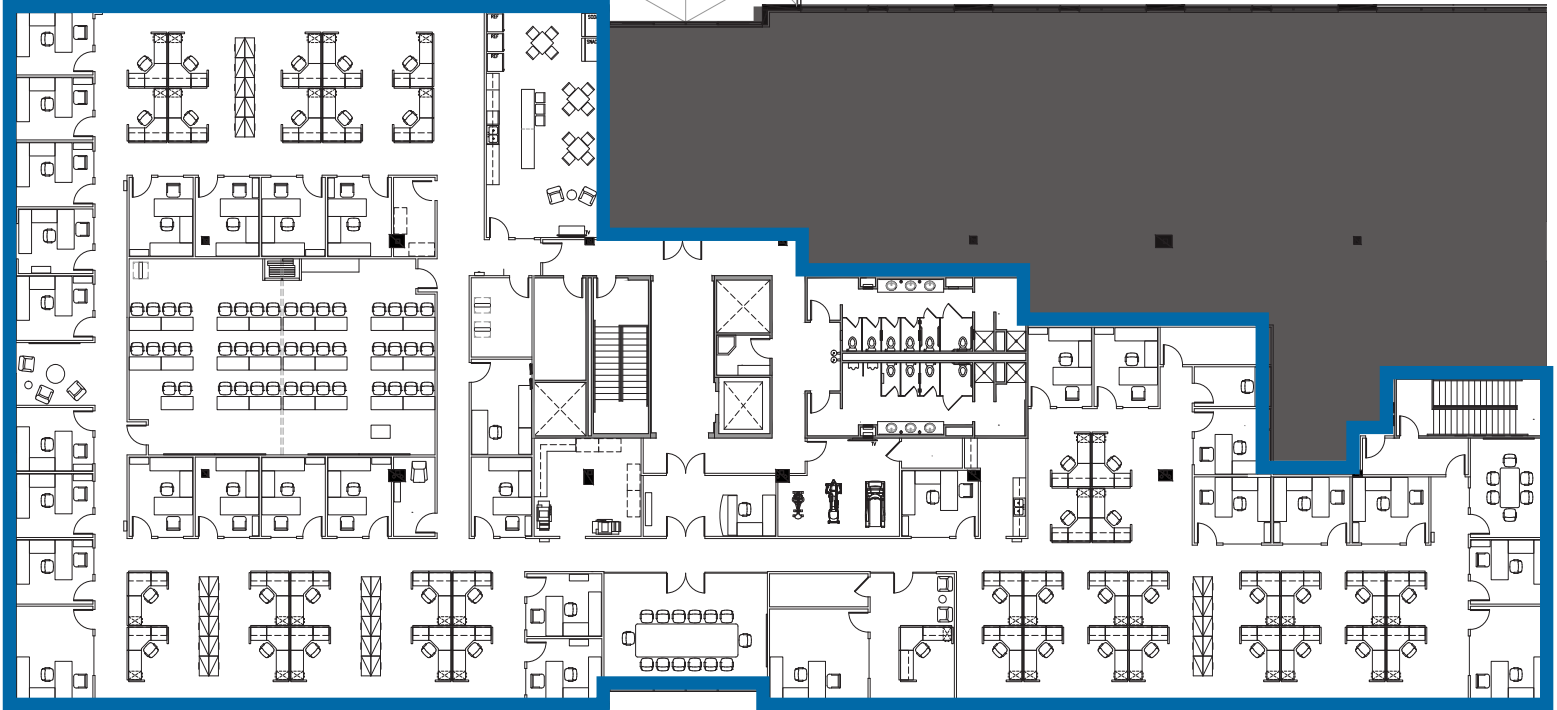

↓ *Willows Golf Course*



For more information, please contact:



10500 NE 8th Street, Suite 900
Bellevue, Washington 98004

broderickgroup.com

Paul Jerue
425.646.5223
jerue@broderickgroup.com

Tyler Slone
425.274.4281
slone@broderickgroup.com

Eric Meussner
425.274.4282
meussner@broderickgroup.com

The information contained herein has been given to us by the owner or sources which we deem reliable. We have no reason to doubt its accuracy, but we do not guarantee it. Prospective tenants should carefully verify all information contained herein.

BUILDING D

10785 Willows Road NE
Redmond, Washington

FOR LEASE



Willow Creek Corporate Center

Willow Creek Corporate Center offers a distinctive seven-building corporate campus totaling 419,000 square feet within 27 acres of landscaped grounds overlooking Willows Run Golf Course. Minutes from downtown Redmond, Willow Creek Corporate Center is exceptionally well located and easy to access off of Willows Road. Both high-profile corporate companies and small private businesses call Willow Creek Corporate Center home.



For more information, please contact:



10500 NE 8th Street, Suite 900
Bellevue, Washington 98004

broderickgroup.com

Paul Jerue
425.646.5223
jerue@broderickgroup.com

Tyler Slone
425.274.4281
slone@broderickgroup.com

Eric Meussner
425.274.4282
meussner@broderickgroup.com

The information contained herein has been given to us by the owner or sources which we deem reliable. We have no reason to doubt its accuracy, but we do not guarantee it. Prospective tenants should carefully verify all information contained herein.