

For Lease: Downtown Tampa Office / Exec. Suites

COURTHOUSE PLAZA

625 E Twiggs St., Tampa, FL 33602



Flexible Lease Terms!



FEATURES

- ❖ Class A 2-story office building w/ attractive lobby, on-site parking, private courtyard & Free WiFi/Access to 2 conference rooms!
- ❖ Excellent location in Downtown Tampa at the NE Corner of E Twiggs and N Pierce St w/ immediate access to I-275, I-4 and the Selmon Crosstown Expressway
- ❖ Steps away from Circuit, County and Federal Courthouse
- ❖ Blocks from the Riverwalk, Convention Center, Florida Aquarium and Transit
- ❖ Opportunity to occupy the entire first floor! (7,0006 SF)
- ❖ Two Onsite Parking Lots and Street Parking!!
- ❖ Fully Furnished Executive Suites Available! (70 SF - 225 SF)
- ❖ 2,182 SF - 7,006 SF Available (max. contiguous - 4,229 SF)
- ❖ Asking Rent: \$25.00/SF Full Service

LOCATION MAP

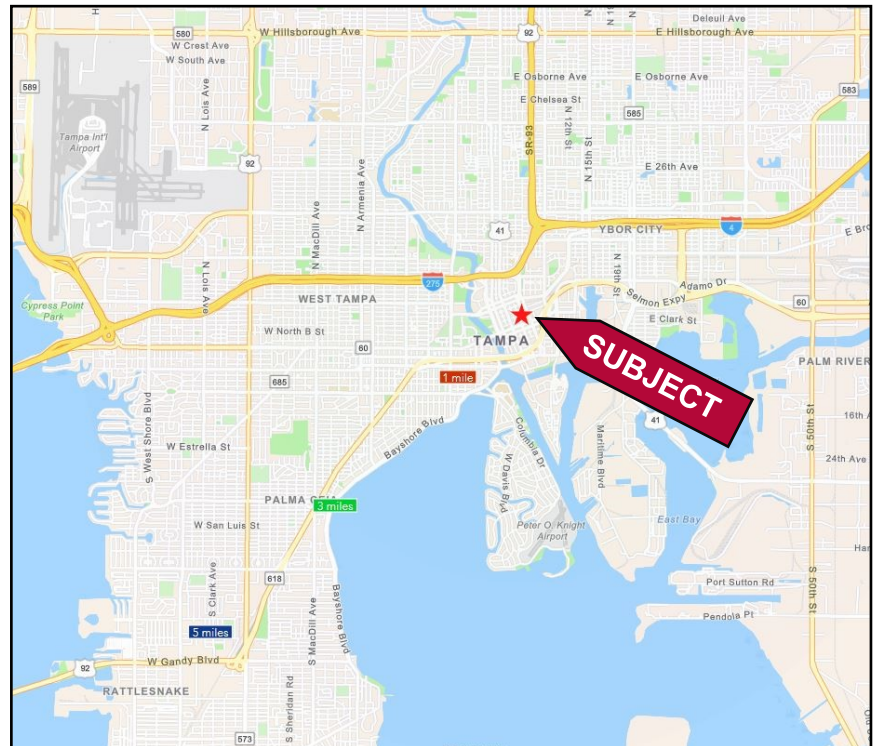

Elliott M. Ross, CCIM
O: 813.755.6700
C: 727.639.3800
elliott@rossrealtytampabay.com

Jennifer Aprile
O: 813.755.6700
C: 813.727.9588
jenaprile@rossrealtytampabay.com

ROSS REALTY GROUP, INC.
Watermark Building 5
5415 Mariner St. Suite 208
Tampa, FL 33609

DOWNTOWN TAMPA OFFICE SPACE

625 E Twiggs St., Tampa, FL 33602

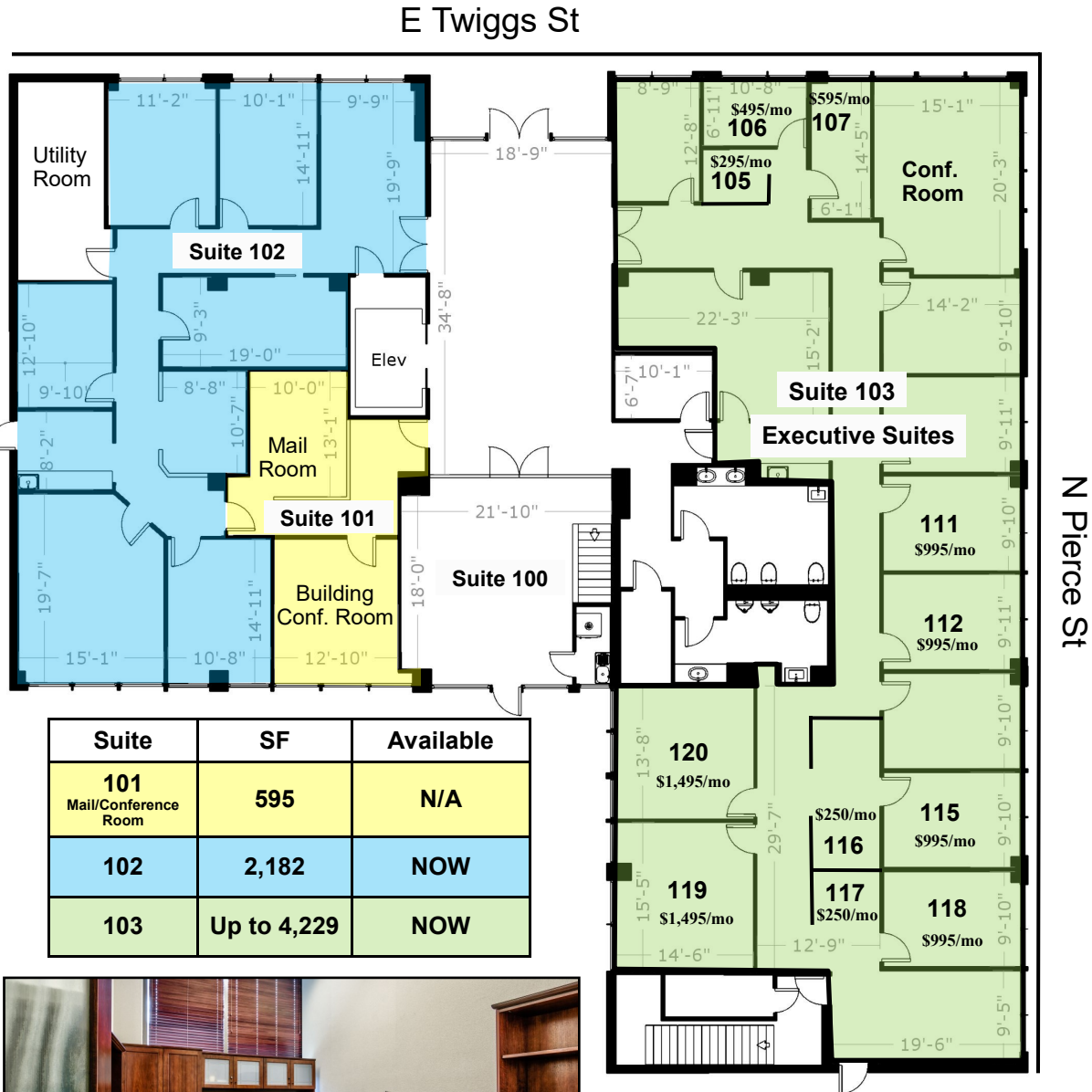

Suite	SF	Available
101 Mail/Conference Room	595	N/A
102	2,182	NOW
103	Up to 4,229	NOW



Additional Onsite Parking

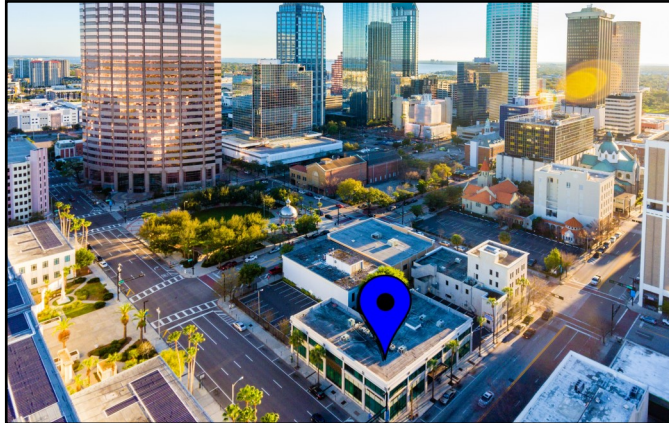

Any information given herein is obtained from sources considered reliable. However, we are not responsible for misstatement of facts, errors, omissions, prior sale, withdrawal from market, modification of mortgage commitment, terms and considerations, or change in price without notice. The information supplied herein is for informational purposes only and shall not contain a warranty or assurance that said information is correct. Any person intending to rely upon the information supplied herein should verify said information independently.