



# 555

BROADWAY

SOHO / NYC



BE  
BOLD.



CONCEPTUAL RENDERING



# CAPTURE YOUR PIECE OF SOHO

Two incomparable **flagship opportunities** with tremendous flexibility for **expansion** and **attention**.

# FLAGSHIP VISION

- Newly renovated space adjacent to Sephora's new flagship
- Expansive frontages, soaring ceilings, three brand-boosting flags and two plaques
- Expand up to all or a portion of the Second Floor

- Combine with 120 Mercer Street for dual entrances and maximum exposure
- Possession:
  - SPACE A Arranged
  - SPACE B February 15th, 2020
  - SPACE C Immediate

## GROUND FLOOR (CEILING HEIGHT 17' 4")

## SECOND FLOOR (CEILING HEIGHT 13' 4")

## BASEMENT (CEILING HEIGHT 14' 3")

555 BROADWAY  
CAN BE COMBINED  
WITH 120 MERCER  
STREET FOR  
OVER 7,500 SF  
IN EACH DIVISION

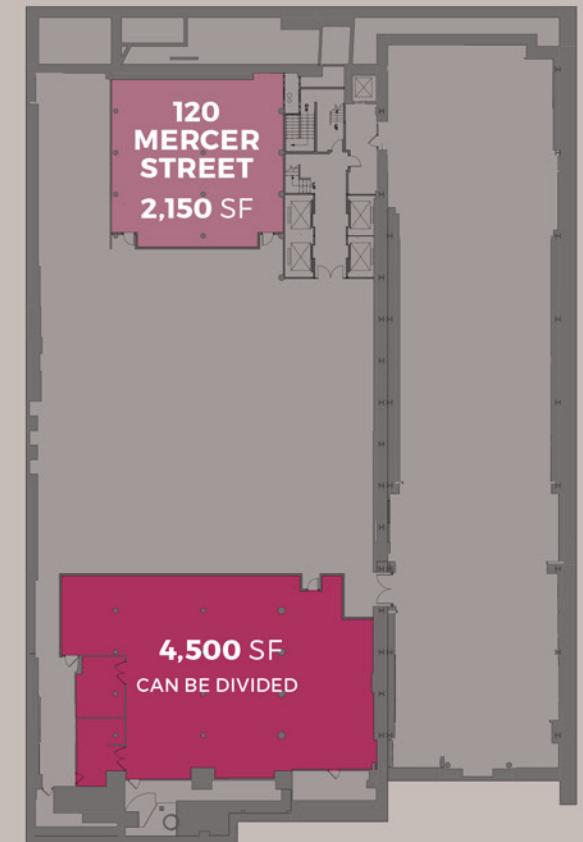
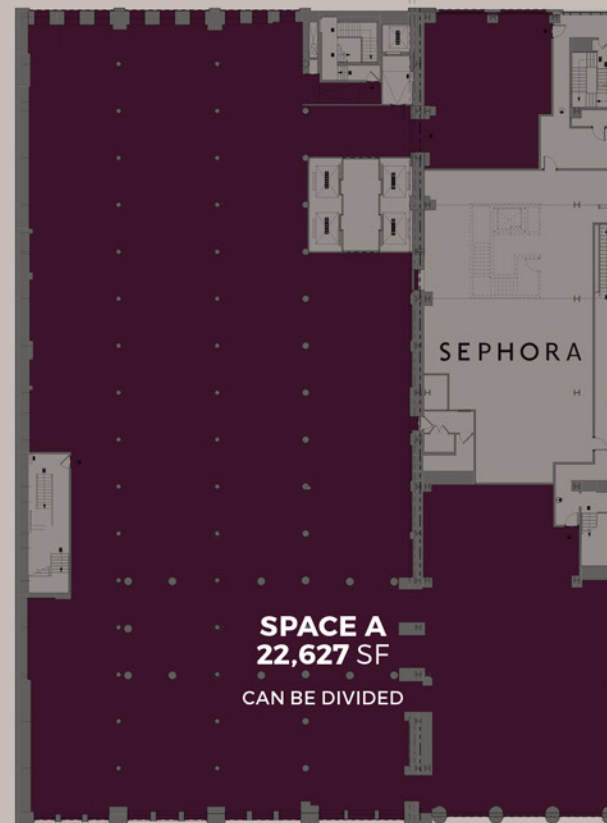
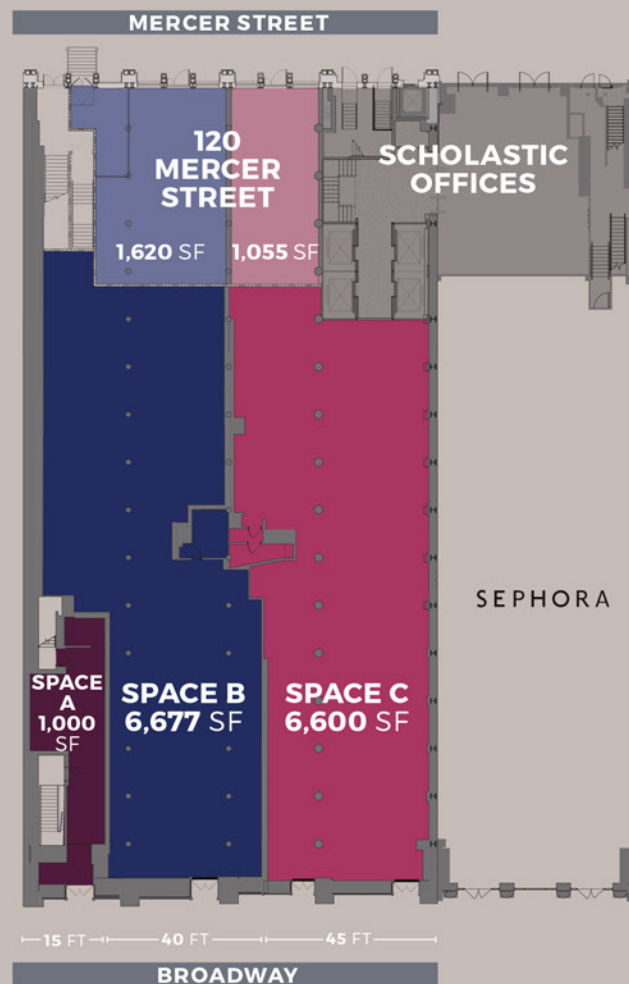



# IN STYLE

Surround yourself by the **most enviable brands** and over 100,000 weekly shoppers in the **most desirable retail location** in New York City.





# CONNECT WITH US

**555**  
BROADWAY  
SOHO / NYC

## CONTACT EXCLUSIVE AGENTS

**Karen Bellantoni**  
karen.bellantoni@ngkf.com  
212.331.0116

**Pierce Thompson**  
pierce.thompson@ngkf.com  
212.916.3361

**Jackie Totolo**  
jackie.totolo@ngkf.com  
212.916.3392



© 2019 NEWMARK KNIGHT FRANK RETAIL. The information contained herein has been obtained from sources deemed reliable but has not been verified and no guarantee, warranty or representation, either express or implied, is made with respect to such information. Terms of sale or lease and availability are subject to change or withdrawal without notice.