

# THE HAMILTON

21 Milton Avenue, Alpharetta, GA 30009

## EXECUTIVE SUMMARY



### LOCATION OVERVIEW

Located at the prime corner of Milton Ave and N Main Street with immediate proximity to Alpharetta City Center

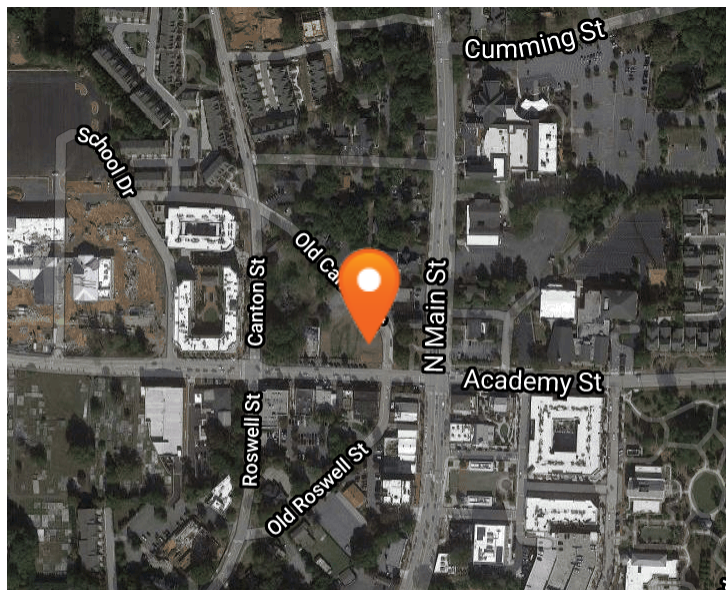

### PROPERTY HIGHLIGHTS

- Available: +/-9,000 SF (can be subdivided--flexibility with demising wall)
- Ground floor retail space fronting Milton Avenue
- Luxury 119-room, boutique hotel development from The Curio Collection by Hilton
- Spring 2021 delivery
- GA DOT Traffic Counts: Hwy 9/Main St-25,000 AADT

### DEMOGRAPHICS

	1 MILE	3 MILES	5 MILES
Population Density	8,541	59,825	187,528
Average HH Income	\$110,837	\$122,355	\$134,397
Daytime Population	11,879	140,879	263,305

### EXCLUSIVE AGENT(S)

STACI SPANGLER • [staci.spangler@tscg.com](mailto:staci.spangler@tscg.com) • 770.955.2434  
 MEGAN MCCRANEY • [megan.mccraney@tscg.com](mailto:megan.mccraney@tscg.com) • 770.955.2434



# THE HAMILTON

21 Milton Avenue, Alpharetta, GA 30009

## SITE PLAN - OPTION A

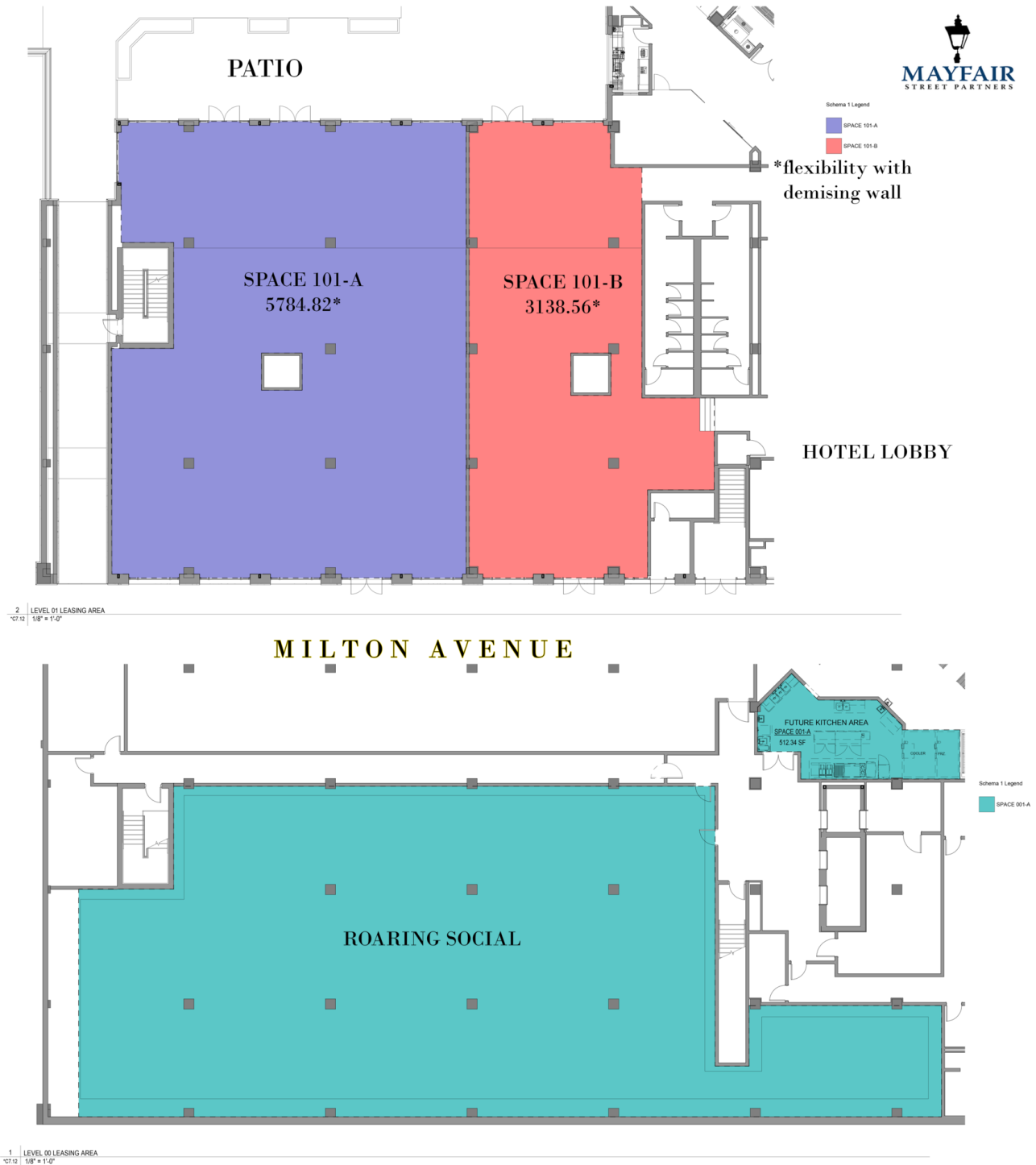

### EXCLUSIVE AGENT(S)

STACI SPANGLER • staci.spangler@tscg.com • 770.955.2434

MEGAN MCCRANEY • megan.mccraney@tscg.com • 770.955.2434

# THE HAMILTON

21 Milton Avenue, Alpharetta, GA 30009

## SITE PLAN - OPTION B

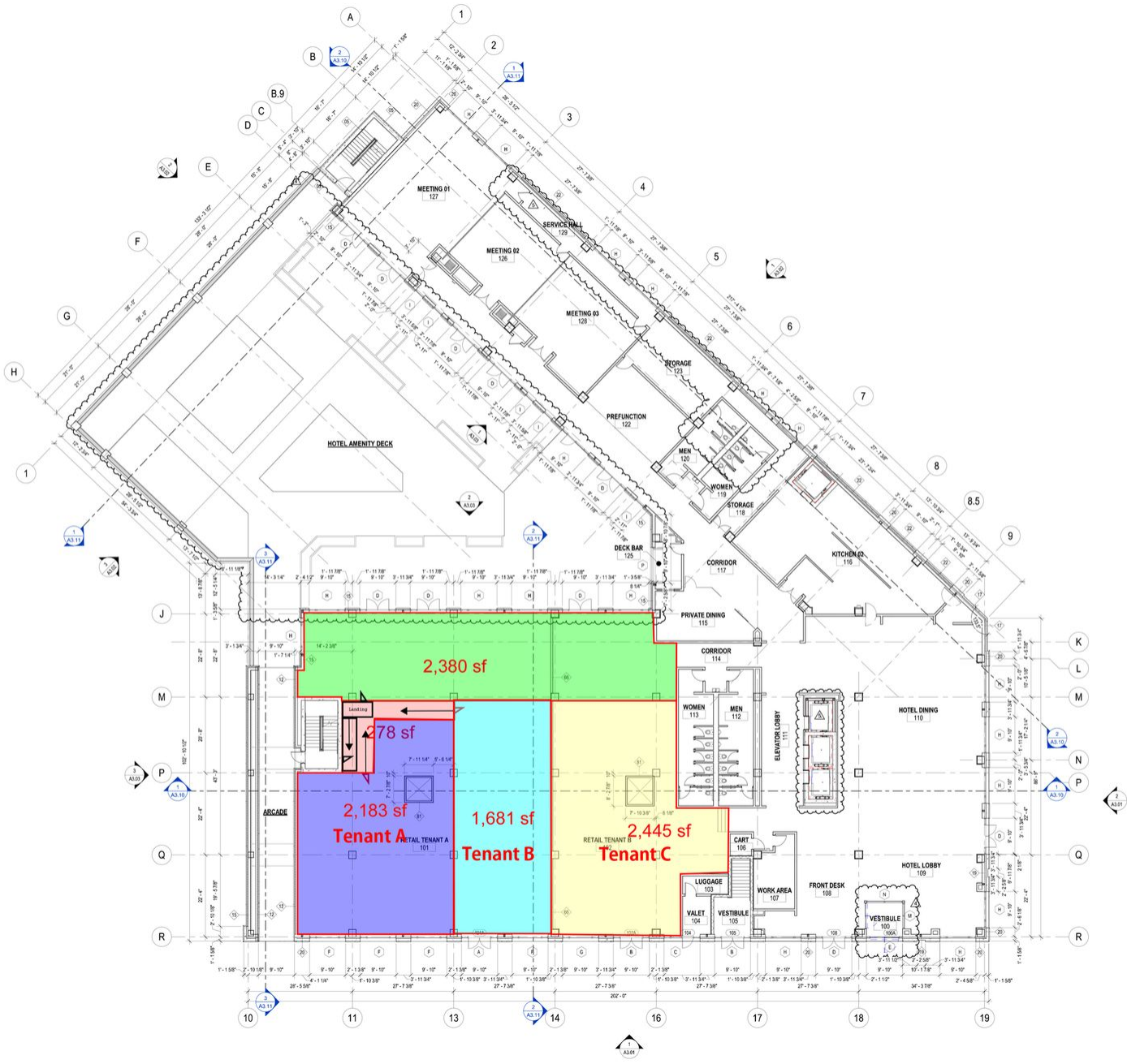

### EXCLUSIVE AGENT(S)

STACI SPANGLER • [staci.spangler@tscg.com](mailto:staci.spangler@tscg.com) • 770.955.2434

MEGAN MCCRANEY • [megan.mccraney@tscg.com](mailto:megan.mccraney@tscg.com) • 770.955.2434

