

ENSIGN WAREHOUSE

925 WEST 100 NORTH, NORTH SALT LAKE, UTAH 84054

FOR LEASE

ENSIGN WAREHOUSE

925 WEST 100 NORTH, NORTH SALT LAKE, UTAH 84054

FOR LEASE



PROPERTY FEATURES

- 4,289 - 12,100 SF AVAILABLE
- Building Depth 147' 1"
- Clear Height: 28'
- Zoned Commercial
- High Image Fronts
- Power 480 Volt / 200 amp / 3 Phase
- Fenced Rear Access with Automated Gates
- Access: - Just off of Center Street and Redwood - 0.9 Mile from 2-15, 2 Miles from I-15 with a 10 minute drive to the airport



JEFF HEATON, SIOR
 801.578.5539
 jeff.heaton@ngkf.com

ELI PRIEST
 801.746.4746
 eli.priest@ngkf.com

376 East 400 South, Suite 120 | Salt Lake City, Utah 84111
 801.578.5555 | www.ngacres.com

376 East 400 South, Suite 120 | Salt Lake City, Utah 84111
 801.578.5555 | www.ngacres.com



This document has been prepared by Newmark Knight Frank for advertising and general information purposes only. While the information contained herein has been obtained from what are believed to be reliable sources, the same has not been verified for accuracy or completeness. Newmark Knight Frank accepts no responsibility or liability for the information contained in this document. Any interested party should conduct an independent investigation to verify the information contained herein.



This document has been prepared by Newmark Knight Frank for advertising and general information purposes only. While the information contained herein has been obtained from what are believed to be reliable sources, the same has not been verified for accuracy or completeness. Newmark Knight Frank accepts no responsibility or liability for the information contained in this document. Any interested party should conduct an independent investigation to verify the information contained herein.

ENSIGN WAREHOUSE

925 WEST 100 NORTH, NORTH SALT LAKE, UTAH 84054

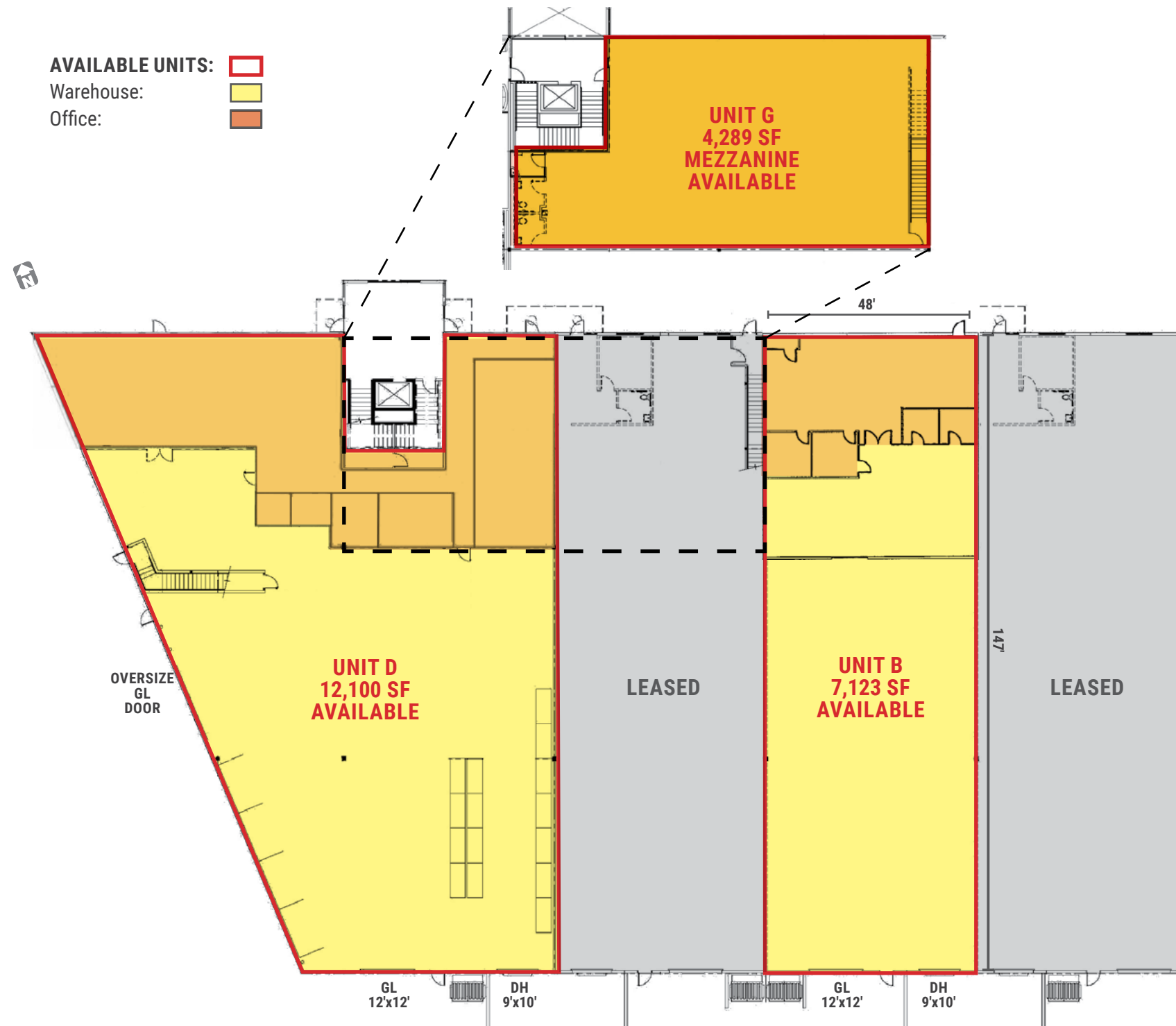

UNIT B

- Unit B: 7,123 SF AVAILABLE
 - Warehouse: 5,723 SF
 - Office: 1,400 SF
- Loading
 - One (1) Dock High Door (9' x 10')
 - One (1) Ground Level Door (12' x 12')
- Power 480 Volt / 200 amp / 3 Phase
- Fenced Rear Access with Automated Gates
- **Lease Rate: \$0.65 PSF / Mo. NNN**

UNIT D

- Unit D: 12,100 SF AVAILABLE
 - Warehouse: 8,420 SF
 - Office: 3,680 SF
- Loading
 - One (1) Dock High Door (9' x 10')
 - Two (2) Ground Level Door (12' x 12')
- Power 480 Volt / 200 amp / 3 Phase
- Fenced Rear Access with Automated Gates
- **Lease Rate: \$0.62 PSF / Mo. NNN**

UNIT G

- 4,289 SF – Mezzanine Built to Suit Office
- 2nd story marque entrance with elevator and stair access
- Improvement Allowance Subject to Term, Tenant Financials, & Rate
- **Lease Rate: \$12.00 PSF / Yr. NNN**