

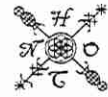

NEW ORLEANS HEALING CENTER



1st FLOOR

| | |
|------|------------------------------|
| 100 | Island of Salvation Botanica |
| 104 | Magnolia Physical Therapy |
| 110 | New Orleans Food Coop |
| 111 | Affordable Healing Arts |
| 122 | Vacant 625 sq ft |
| 124C | Arbor House Floral |
| 124W | Vacant 147 sq ft |
| 125 | Two Guys Cutting Hair |
| 128 | Vacant 144 sq ft |
| 130 | The Peach Cobbler Factory |
| 140 | Café Istanbul |
| 169 | Vacant 200 sq ft |

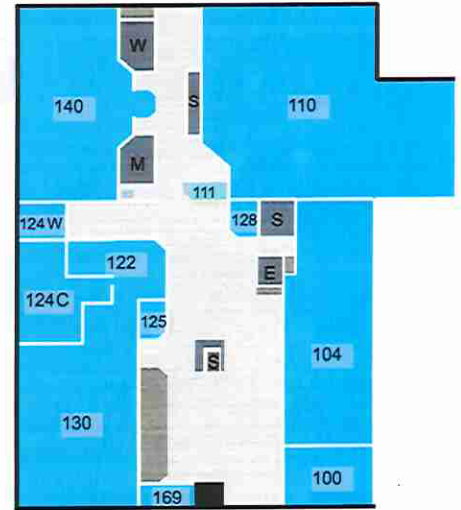

2nd LOWER FLOOR

| | |
|-----|----------------------------|
| 250 | Vacant 400 sq ft |
| 251 | Second Story Art Gallery |
| 252 | Tim Dolzine Woodwinds |
| 253 | YoMaggie Productions |
| 254 | Vacant 483 sq ft |
| 255 | Vacant 393 sq ft |
| 256 | Casa de España |
| 258 | WWOZ |
| 260 | NOHC Administrative Office |
| 264 | Downtown Fitness Center |

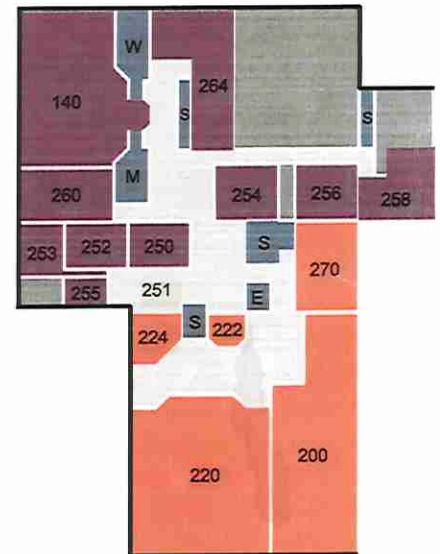

2nd UPPER FLOOR

| | |
|-----|--------------------------------|
| 200 | Vacant 1632 / 2377 sq ft |
| 204 | Vacant 624 sq ft |
| 220 | Affordable Healing Arts |
| 222 | Law Office of William Most |
| 224 | Crouch Law - Attorney & Notary |
| 270 | The Lambda Center |

3rd FLOOR

| | |
|------|----------------------------|
| 261 | Crawford Engineering |
| 300 | The Building Block |
| 300A | School Food Solutions |
| 300B | Law Office of William Most |
| 300C | Groundwork New Orleans |

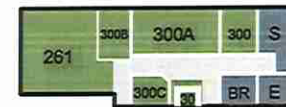

4th FLOOR

| | |
|-----|------------------|
| 400 | Vacant 710 sq ft |
|-----|------------------|

2372 St Claude

| | |
|-----|-------------------|
| 230 | Vacant 1172 sq ft |
|-----|-------------------|

