

## Prime Intersection in Brookside/Waldo



NE Corner of Gregory Blvd & Oak St., Kansas City, Missouri

For more information:

- Well-established Brookside/Waldo neighborhood
- Minutes from the Country Club Plaza and Mission Hills
- Street and off-street parking available (in rear)
- Access to basements available for storage - not included in SF/ Rent
- Garage building available for storage/service - 500 SF with overhead door

Michael R. Block, CPM  
816.932.5549  
mblock@blockllc.com

The information contained in this marketing flyer is presented as general information only. Block Real Estate Services, LLC. makes no representation as to its accuracy. This information is not intended as legal, financial or real estate advice and must not be relied upon as such. You should make your own inquiries, obtain independent inspections, and seek professional advice tailored to your specific circumstances before making any legal, financial or real estate decisions.

## 2019 Estimated Net Charges

Net Charges: (2018 Est.)	Real Estate Taxes:	\$1.34 PSF
	Insurance:	\$0.10 PSF
	<u>CAM:</u>	<u>\$3.19 PSF</u>
	Total:	\$4.63 PSF

For more information:

Michael R. Block, CPM  
816.932.5549  
mblock@blockllc.com

# Gregory & Oak Shops

NE Corner of Gregory Blvd. & Oak St., Kansas City, Missouri

# For Lease

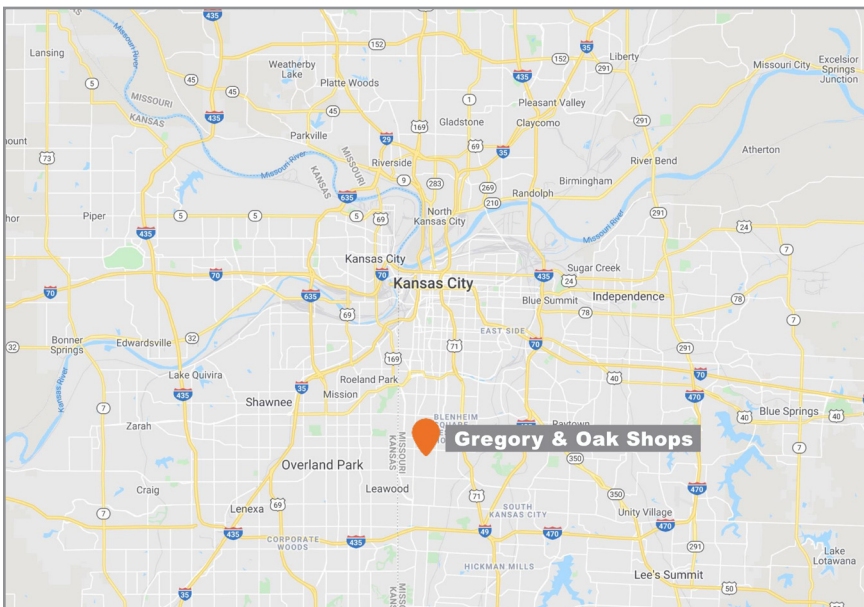

For more information:

Michael R. Block, CPM  
816.932.5549  
[mblock@blockllc.com](mailto:mblock@blockllc.com)

700 W. 47th Street, Suite 200  
Kansas City, MO 64112  
816.756.1400 | [www.BLOCKLLC.com](http://www.BLOCKLLC.com)

**BLOCK**  
REAL ESTATE SERVICES, LLC

# Gregory & Oak Shops

NE Corner of Gregory Blvd. & Oak St., Kansas City, Missouri

# For Lease

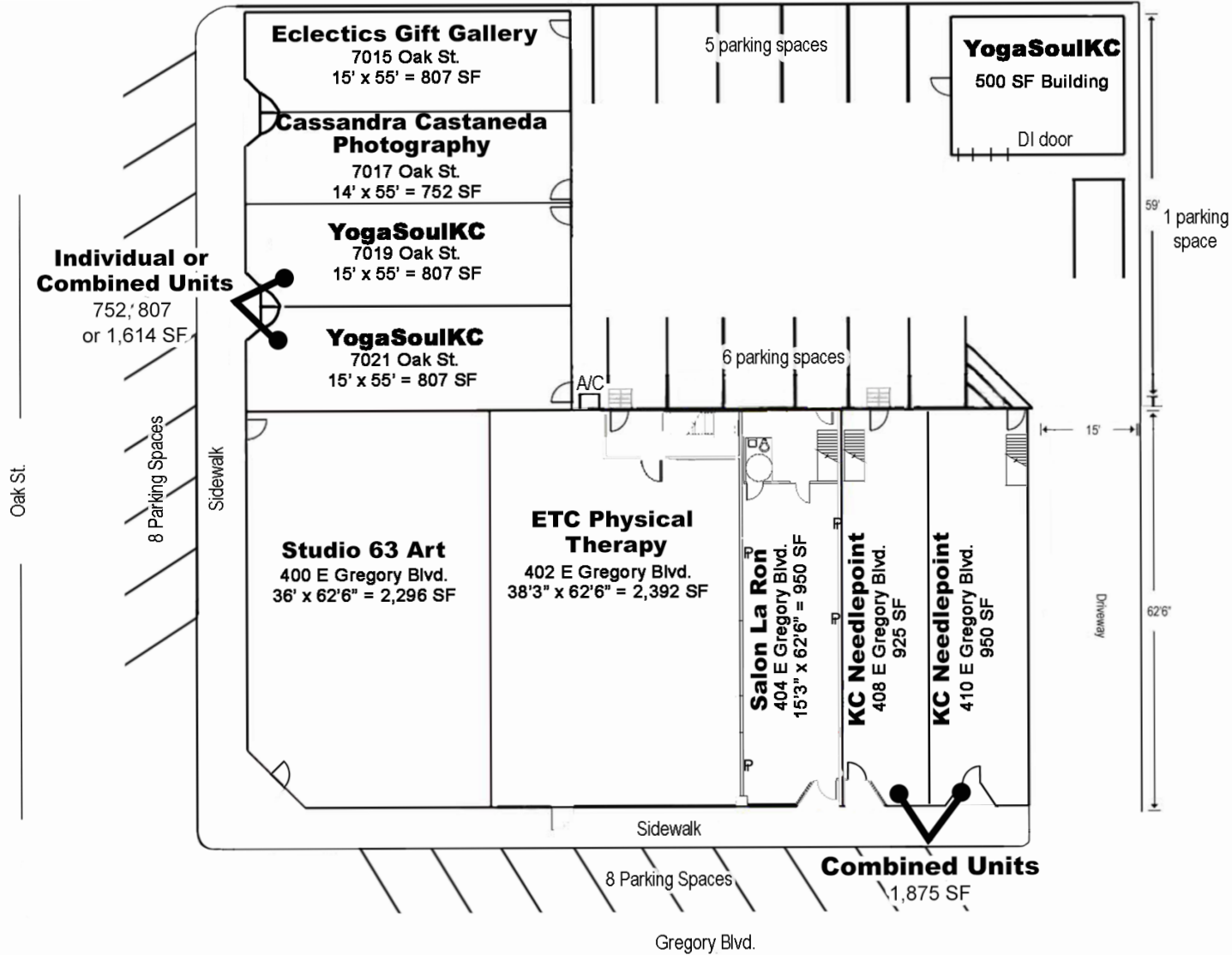

# Gregory & Oak Shops

NE Corner of Gregory Blvd. & Oak St., Kansas City, Missouri

# For Lease

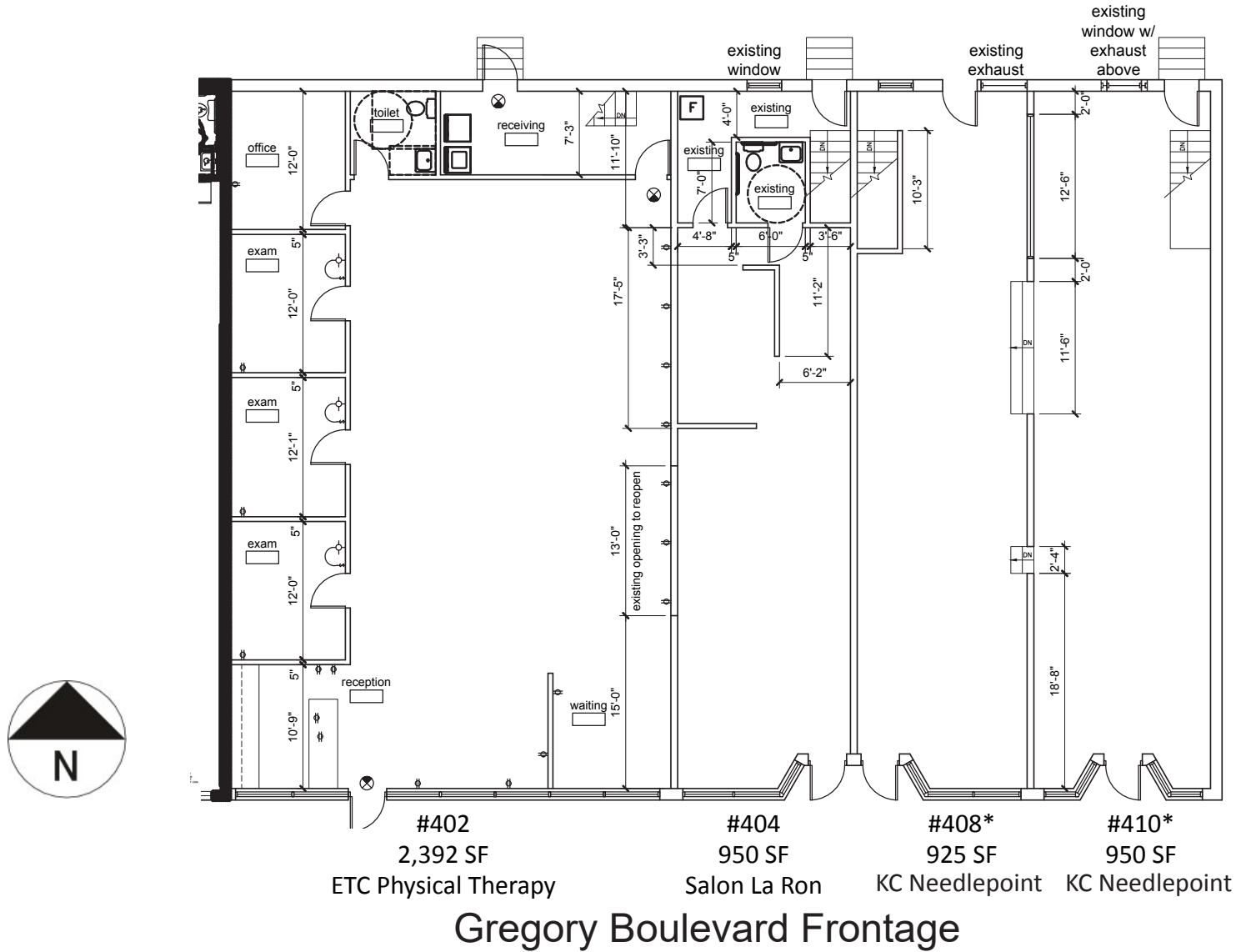

## Demographics

Gregory & Oaks Shops		1 mi radius	2 mi radius	3 mi radius
KCMO, MO 64113				
POPULATION	2019 Estimated Population	14,762	53,003	97,067
	2024 Projected Population	14,912	54,190	100,443
	2010 Census Population	14,901	52,694	95,310
	2000 Census Population	15,436	56,173	102,642
	Projected Annual Growth 2019 to 2024	0.2%	0.4%	0.7%
	Historical Annual Growth 2000 to 2019	-0.2%	-0.3%	-0.3%
	2019 Median Age	37.4	38.0	38.1
HOUSEHOLDS	2019 Estimated Households	7,073	24,628	44,725
	2024 Projected Households	7,196	25,331	46,532
	2010 Census Households	6,780	23,291	41,817
	2000 Census Households	6,957	24,176	44,422
	Projected Annual Growth 2019 to 2024	0.3%	0.6%	0.8%
	Historical Annual Growth 2000 to 2019	-	-	-
RACE AND ETHNICITY	2019 Estimated White	73.5%	60.0%	60.2%
	2019 Estimated Black or African American	20.8%	34.1%	33.1%
	2019 Estimated Asian or Pacific Islander	1.6%	1.7%	2.4%
	2019 Estimated American Indian or Native Alaskan	0.3%	0.4%	0.3%
	2019 Estimated Other Races	3.8%	3.9%	4.0%
	2019 Estimated Hispanic	4.5%	4.2%	4.2%
INCOME	2019 Estimated Average Household Income	\$118,029	\$109,214	\$113,018
	2019 Estimated Median Household Income	\$90,004	\$82,383	\$80,972
	2019 Estimated Per Capita Income	\$56,592	\$50,801	\$52,192
EDUCATION (AGE 25+)	2019 Estimated Elementary (Grade Level 0 to 8)	1.1%	1.2%	1.3%
	2019 Estimated Some High School (Grade Level 9 to 11)	2.8%	4.7%	4.7%
	2019 Estimated High School Graduate	14.1%	18.5%	18.5%
	2019 Estimated Some College	15.9%	17.6%	17.9%
	2019 Estimated Associates Degree Only	5.0%	6.2%	5.9%
	2019 Estimated Bachelors Degree Only	34.9%	29.7%	29.3%
	2019 Estimated Graduate Degree	26.2%	22.0%	22.4%
BUSINESS	2019 Estimated Total Businesses	810	2,270	4,518
	2019 Estimated Total Employees	6,544	21,349	55,454
	2019 Estimated Employee Population per Business	8.1	9.4	12.3
	2019 Estimated Residential Population per Business	18.2	23.3	21.5