

For Lease or Sale



±3,500 SF

Free Standing Office Building for Lease or Sale

- High quality office building conveniently located just off Highway 101 in Mill Valley, CA
- Ground floor: 1,839 SF for lease
- Rate: \$3.75 SF/mo - Full service (net of janitorial services)
- Purchase price: Contact JLL for pricing guidance
- Current owner will vacate to deliver entire building for owner/user sale

1058 Redwood Highway
Frontage Road, Mill Valley, CA

Chris Tewhill

+1 415 299 6865

RE License #: 02034376

chris.tewhill@am.jll.com

Jordan Lazor

+1 415 299 6859

RE License #: 02011117

jordan.lazor@am.jll.com

Glen Dowling

+1 415 299 6868

RE License #: 00890450

glen.dowling@am.jll.com

www.DBREA.com | www.JLL.com



©2019 Jones Lang LaSalle IP, Inc. All rights reserved. All information contained herein is from sources deemed reliable; however, no representation or warranty is made to the accuracy thereof. Jones Lang LaSalle Brokerage, Inc. Real Estate License#: 01856260

The Offering

- Standalone office property for sale or lease
- Ground floor office for lease - available now
 - 953 SF - 1,839 SF
 - \$3.75 sf/mo full service (net of janitorial services)
 - Tenant responsible for janitorial service and internet
- Owner/user purchase opportunity
- Ownership will relocate to deliver full building in the event of a sale



Site location



Freestanding office property in the

heart of Southern Marin

Floor Plans

First Floor

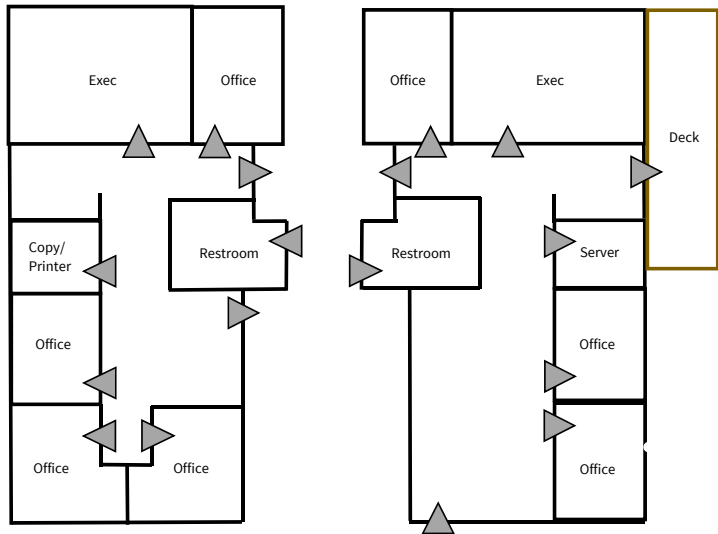

Second Floor

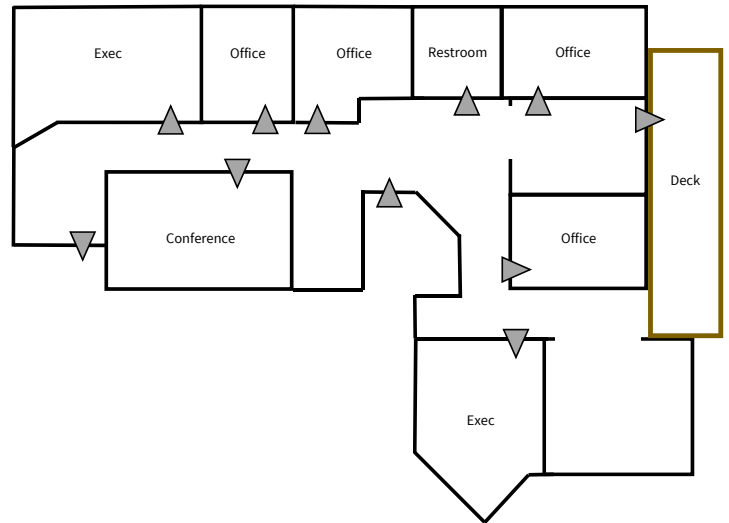

Building Highlights

- Two-story, wood frame, office building built in 1977
- Recently renovated interior
- Efficient mix of private offices and open work area
- Dramatic architecture with oversized windows and abundant natural light
- Mt. Tamalpais views
- 15 on-site parking spaces
- Additional street parking
- High-end finishes throughout building
- Interior glass
- Exposed wood beams



Gateway of Marin County



For More Information, Please Contact:

Chris Tewhill

+1 415 299 6865

RE License #: 02034376

chris.tewhill@am.jll.com

Jordan Lazor

+1 415 299 6859

RE License #: 02011117

jordan.lazor@am.jll.com

Glen Dowling

+1 415 299 6868

RE License #: 00890450

glen.dowling@am.jll.com



www.DBREA.com | www.JLL.com