

# JOIN THE COTERIE AT BAKER CENTER

**COTERIE:** (COAT·A·RE)

Intimate and exclusive group with common interest



**SUITE 830**

57 EMPLOYEES  
7,667 SF

**SUITE 820**

52 EMPLOYEES  
9,355 SF

**SUITE 840**

27 EMPLOYEES  
4,106 SF

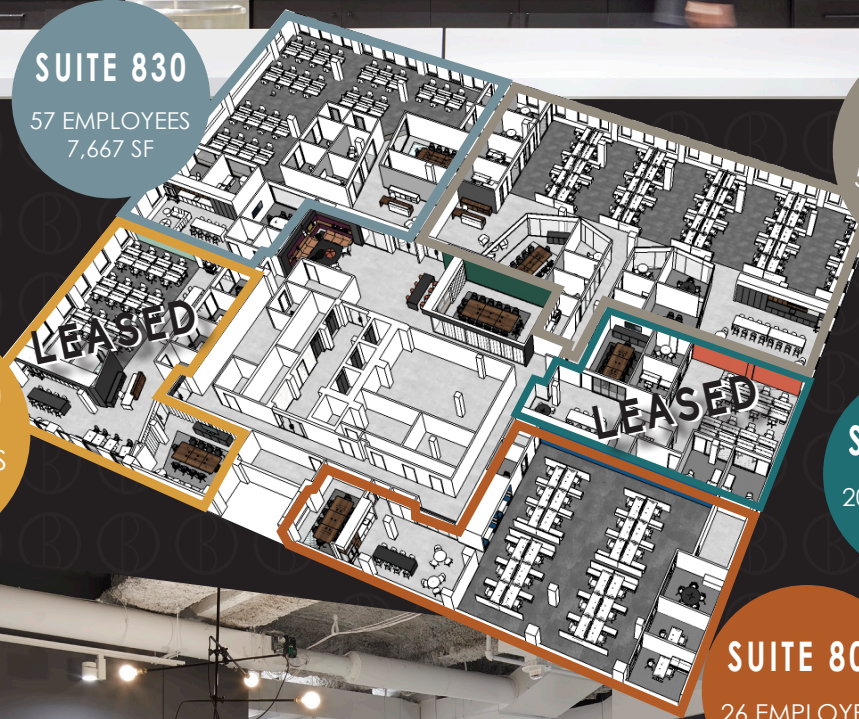

**SUITE 810**

20 EMPLOYEES  
2,882 SF

**SUITE 800**

26 EMPLOYEES  
4,512 SF



# AVAILABLE SPEC SUITES

## 730 - 8<sup>TH</sup> FLOOR EXCLUSIVE CONFERENCE ROOM, LOUNGE, AND SHUFFLE BOARD

### SUITE 830

57 EMPLOYEES  
7,667 SF  
6 OFFICES  
50 WORKSTATIONS  
4 CONFERENCE  
134 SF/EMPLOYEE

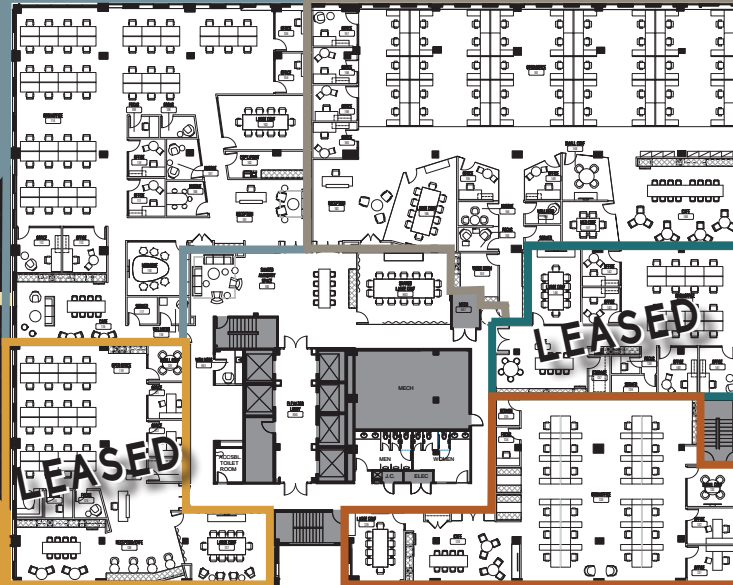

### SUITE 820

52 EMPLOYEES  
9,355 SF  
6 OFFICES  
45 WORKSTATIONS  
5 CONFERENCE  
179 SF/EMPLOYEE

### SUITE 810

20 EMPLOYEES  
2,882 SF  
4 OFFICES  
16 WORKSTATIONS  
1 CONFERENCE  
144 SF/EMPLOYEE

### SUITE 840

27 EMPLOYEES  
4,106 SF  
2 OFFICES  
24 WORKSTATIONS  
2 CONFERENCE  
152 SF/EMPLOYEE

### SUITE 800

26 EMPLOYEES  
4,512 SF  
2 OFFICES  
24 WORKSTATIONS  
2 CONFERENCE  
173 SF/EMPLOYEE

### SUITE 350

18 EMPLOYEES  
2,720 SF  
2 OFFICES  
16 WORKSTATIONS  
1 CONFERENCE  
151 SF/EMPLOYEE

## 706 - 3<sup>RD</sup> FLOOR

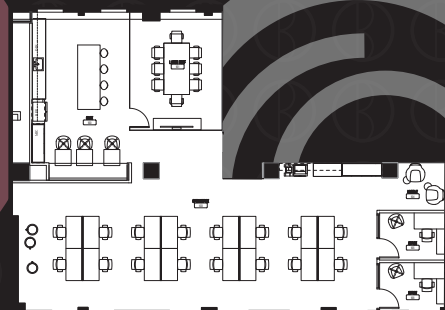

## FOR MORE INFORMATION CONTACT



**TERESA BORGEN**  
(612) 359-1621  
teresa.borgen@transwestern.com

**REED CHRISTIANSON, SIOR**  
(612) 359-1610  
reed.christianson@transwestern.com

**MIKE HONSA, SIOR**  
(612) 359-1631  
mike.honsa@transwestern.com