



MIDTOWN CORNERS

1401-1411

W. SAN CARLOS STREET
SAN JOSE, CALIFORNIA



2nd Floor Office/Retail Space w/ Patio For Lease at Prominent Corner



PROPERTY INFORMATION:

- Corner of Meridian and W. San Carlos Street
- 1,360 SF Office/Retail Space on 2nd Floor with Patio
- Co-Tenants: Venice Nails, Stocks & Blondes and Join Us Beauty Supply
- Across From The New Meridian@Midtown Luxury Apartments
- Excellent Visibility, Signage & Exposure Along West San Carlos Street
- Close Proximity To Local Amenities: Downtown San Jose, Willow Glen, Santana Row & Westfield Valley Fair
- \$2.25 PSF, NNN (\$1.00)

ESTIMATED DEMOGRAPHICS:

	<u>1 MILE</u>	<u>3 MILES</u>	<u>5 MILES</u>
POPULATION:	28,849	231,257	644,191
AVG. HH INCOME:	\$80,548	\$87,824	\$95,405

FOR MORE INFORMATION CONTACT:

David Taxin

Lic. # 00983163

dtaxin@moinc.net

(408) 477-2508 Direct

(408) 378-5900

Matt Perez

Lic. #02017798

mperez@moinc.net

(408) 477-2516 Direct

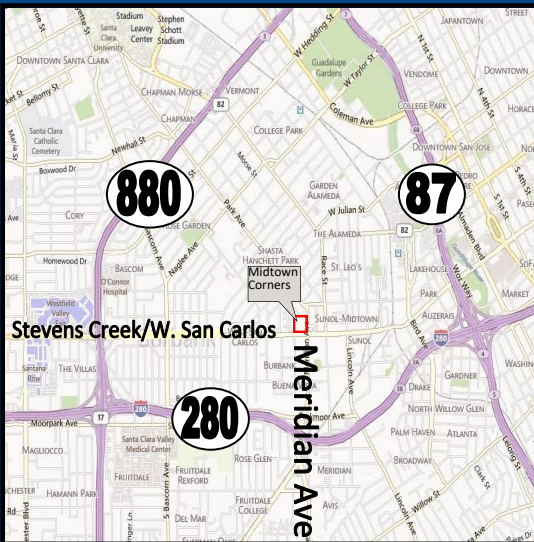

MEACHAM/OPPENHEIMER, INC.

CORFAC INTERNATIONAL

8 No. San Pedro St., Suite 300

San Jose, California 95110

Tel: 408.378.5900

Fax: 408.378.5903

www.moinc.net

Midtown Corners 1401-1411 W. San Carlos St. • San Jose, California

Second Floor

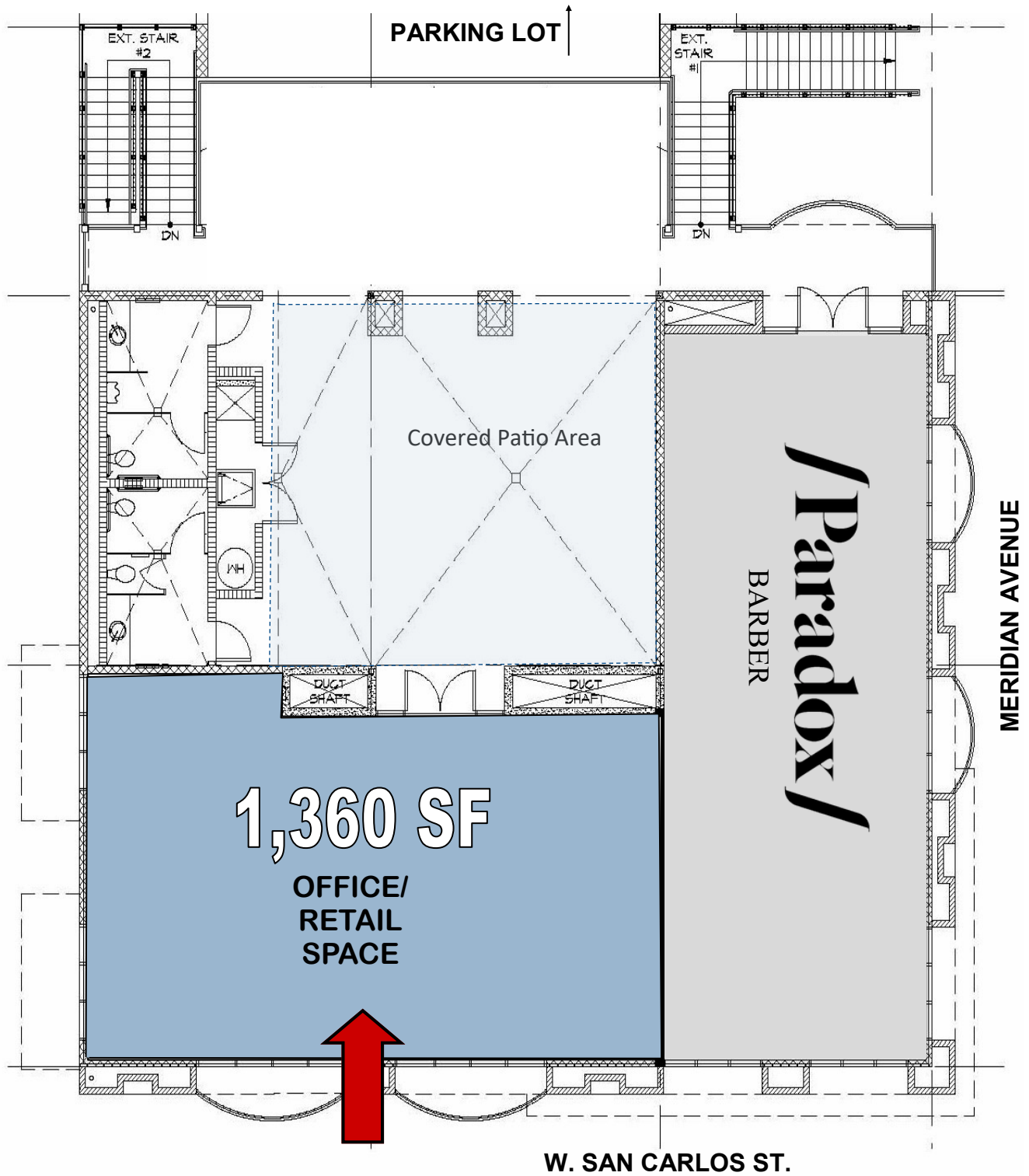

MEACHAM/OPPENHEIMER, INC.
CORFAC INTERNATIONAL
8 No. San Pedro St., Suite 300
San Jose, California 95110
Tel: 408.378.5900
www.moinc.net

David Taxin
Lic. # 00983163
dtaxin@moinc.net
(408) 477-2508 Direct

Matt Perez
Lic. #02017798
mperez@moinc.net
(408) 477-2516 Direct

Midtown Corners 1401-1411 W. San Carlos St. • San Jose, California

First Floor

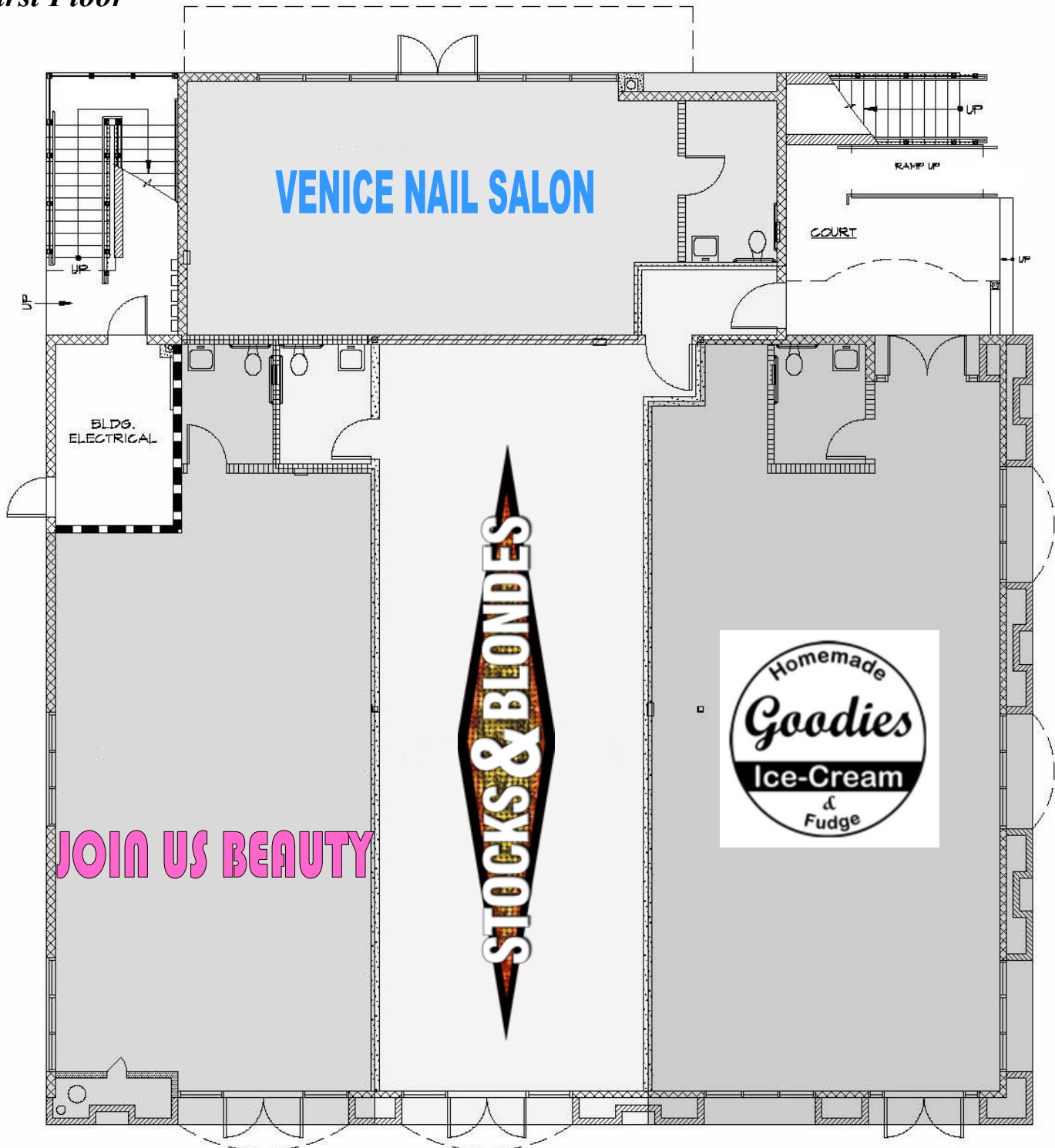

MEACHAM/OPPENHEIMER, INC.
CORFAC INTERNATIONAL
8 No. San Pedro St., Suite 300
San Jose, California 95110
Tel: 408.378.5900
www.moinc.net

David Taxin
Lic. # 00983163
dtaxin@moinc.net
(408) 477-2508 Direct

Matt Perez
Lic. #02017798
mperez@moinc.net
(408) 477-2516 Direct