



INDUSTRIAL BUILDING

±13,500 SF Available For Lease

1451 Grafton Street, Worcester, MA



Kelleher & Sadowsky Associates, Inc. is pleased to introduce 1451 Grafton Street in Worcester, MA as available for lease. The ±28,655 square foot industrial and manufacturing facility has ±13,500 square feet of space that will be available on January 1, 2019. Located less than three-minutes from Route 20 and an I-90 (Massachusetts Turnpike) entry/exit in Millbury, this space features vibrant natural lighting through an abundance of perimeter windows, a paved parking lot, great column spacing, and a high electrical capacity. Although currently operated as an industrial and manufacturing facility, this space is ideal to be repurposed as an educational, medical, or office use. Utilities include septic, gas, and electric.

LEASE RATE: \$5.25 / SF / NNN

Kelleher & Sadowsky
120 Front Street, Suite 210
Worcester, MA 01608
508.755.0707 Office
kellehersadowsky.com

Donald J. Mancini, SIOR
Principal
(508) 635-6786 Direct
(774) 696-8023 Cell
mancini@kellehersadowsky.com

Brian A. Johnson
Vice President
(508) 635-6783 Direct
(774) 272-1112 Cell
johnson@kellehersadowsky.com

This information has been obtained from sources believed reliable. We have not verified it and make no guarantee, warranty or representation about it. Any projections, opinions, assumptions or estimates used are for example only and do not represent the current or future performance of the property. You and your advisors should conduct an independent investigation of the property to determine to your own satisfaction the suitability of the property for your needs.



INDUSTRIAL BUILDING

±13,500 SF Available For Lease

1451 Grafton Street , Worcester, MA



Building Size:	±28,655 SF
Space Available:	±13,500 SF
Year Built:	Circa 1957
Land Area:	±7.11 Acres
Zoning:	MG-0.5
Construction:	Brick and Concrete Block
Roof:	Rubber Membrane
Loading:	Three (3) tailboard height docks
Utilities:	Septic, gas, electricity
Ceiling Height:	12' 8" clear
Column Spacing:	20' x 40"
Sprinkler:	Yes, wet system
Power:	Three-phase, 400 amps / 600 volts
Est. FY 2018 RE Taxes	\$0.81 / PSF

Kelleher & Sadowsky
120 Front Street, Suite 210
Worcester, MA 01608
508.755.0707 Office
kellehersadowsky.com

Donald J. Mancini, SIOR
Principal
(508) 635-6786 Direct
(774) 696-8023 Cell
mancini@kellehersadowsky.com

Brian A. Johnson
Vice President
(508) 635-6783 Direct
(774) 272-1112 Cell
johnson@kellehersadowsky.com

This information has been obtained from sources believed reliable. We have not verified it and make no guarantee, warranty or representation about it. Any projections, opinions, assumptions or estimates used are for example only and do not represent the current or future performance of the property. You and your advisors should conduct an independent investigation of the property to determine to your own satisfaction the suitability of the property for your needs.

INDUSTRIAL BUILDING

±13,500 SF Available For Lease

1451 Grafton Street , Worcester, MA

Building Plan

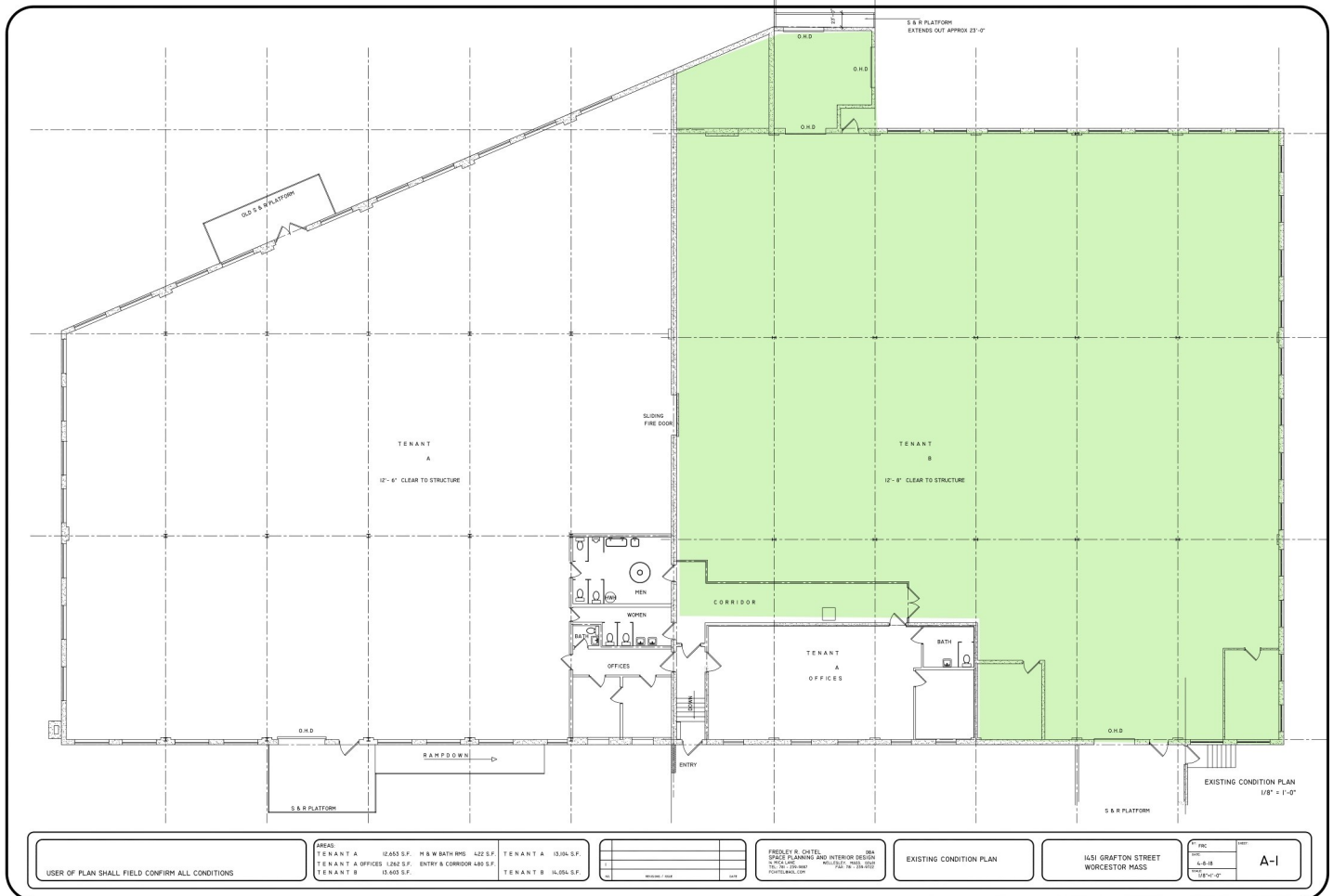

Kelleher & Sadowsky
120 Front Street, Suite 210
Worcester, MA 01608
508.755.0707 Office
kellehersadowsky.com

Donald J. Mancini, SIOR
Principal
(508) 635-6786 Direct
(774) 696-8023 Cell
mancini@kellehersadowsky.com

Brian A. Johnson
Vice President
(508) 635-6783 Direct
(774) 272-1112 Cell
johnson@kellehersadowsky.com

This information has been obtained from sources believed reliable. We have not verified it and make no guarantee, warranty or representation about it. Any projections, opinions, assumptions or estimates used are for example only and do not represent the current or future performance of the property. You and your advisors should conduct an independent investigation of the property to determine to your own satisfaction the suitability of the property for your needs.

INDUSTRIAL BUILDING

±13,500 SF Available For Lease

1451 Grafton Street, Worcester, MA

Floor Plan

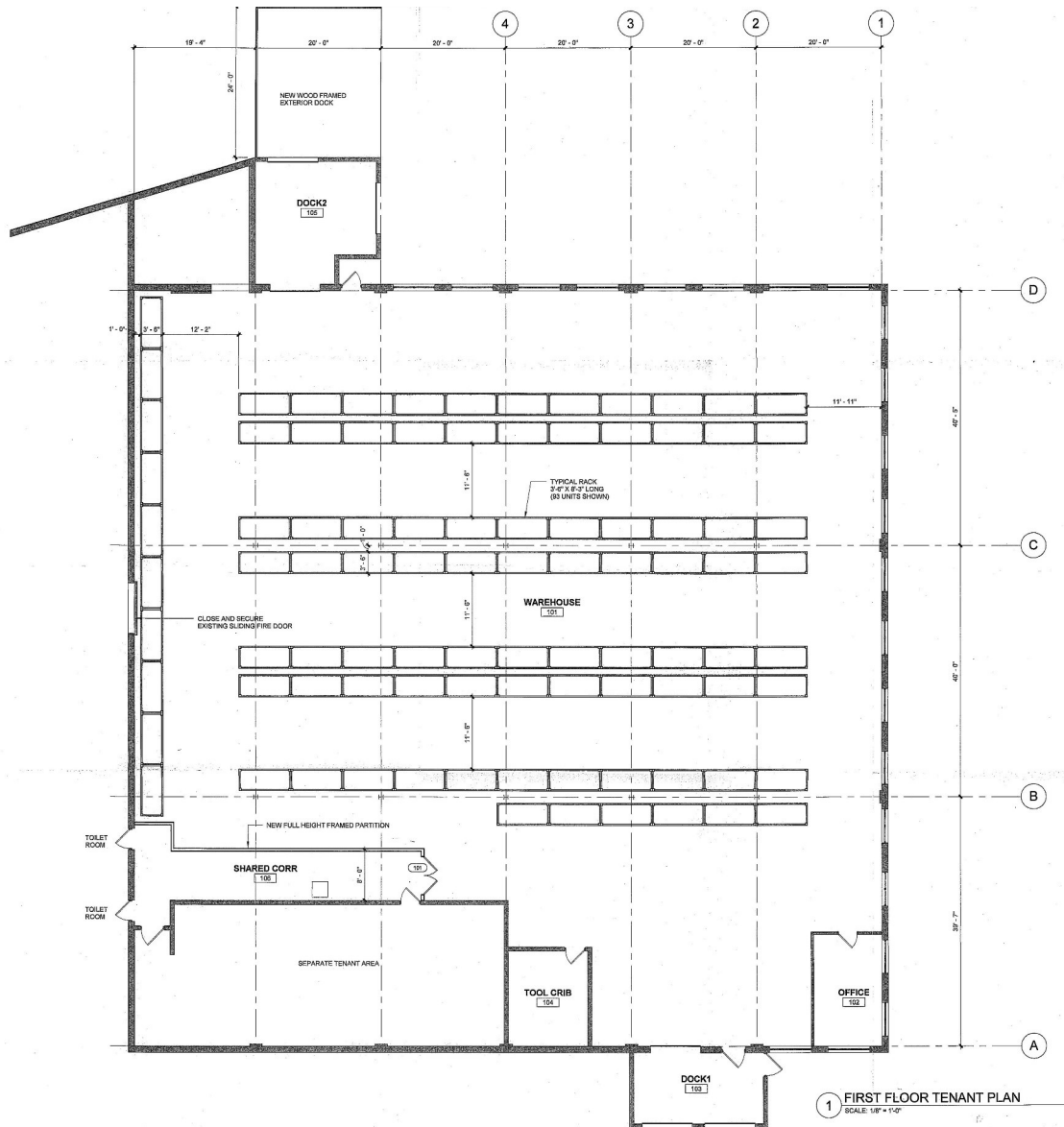

Kelleher & Sadowsky
120 Front Street, Suite 210
Worcester, MA 01608
508.755.0707 Office
kellehersadowsky.com

Donald J. Mancini, SIOR
Principal
(508) 635-6786 Direct
(774) 696-8023 Cell
mancini@kellehersadowsky.com

Brian A. Johnson
Vice President
(508) 635-6783 Direct
(774) 272-1112 Cell
johnson@kellehersadowsky.com

This information has been obtained from sources believed reliable. We have not verified it and make no guarantee, warranty or representation about it. Any projections, opinions, assumptions or estimates used are for example only and do not represent the current or future performance of the property. You and your advisors should conduct an independent investigation of the property to determine to your own satisfaction the suitability of the property for your needs.

INDUSTRIAL BUILDING

±13,500 SF Available For Lease

1451 Grafton Street , Worcester, MA

Interior Photographs



Kelleher & Sadowsky
120 Front Street, Suite 210
Worcester, MA 01608
508.755.0707 Office
kellehersadowsky.com

Donald J. Mancini, SIOR
Principal
(508) 635-6786 Direct
(774) 696-8023 Cell
mancini@kellehersadowsky.com

Brian A. Johnson
Vice President
(508) 635-6783 Direct
(774) 272-1112 Cell
johnson@kellehersadowsky.com

This information has been obtained from sources believed reliable. We have not verified it and make no guarantee, warranty or representation about it. Any projections, opinions, assumptions or estimates used are for example only and do not represent the current or future performance of the property. You and your advisors should conduct an independent investigation of the property to determine to your own satisfaction the suitability of the property for your needs.