



PierPont Commons | Office Condos

4838 E Baseline Road - Bldg 1, Mesa, AZ 85206

FOR SALE
FOR LEASE: SHORT-TERM
OFFICE SPACE AVAILABLE

RARE OPPORTUNITY FOR ASC OR LARGE CLINIC



Property Highlights

- ±9,769 SF Condo Office
- Call for sale price
- Parking Ratio: 4.00/1,000
- Zoning: PEP, Mesa
- Located adjacent to MD Anderson Cancer Center and Banner Gateway Hospital
- Well-maintained common area
- Extensive retail amenities nearby
- 1/2 mile south of US 60 at Highley Road
- APNs: 140-68-116, 140-68-117, 140-68-118
- Willing to do a short-term office space lease on the south side of the building

TOM WEINHOLD
Managing Director
+1 602 224 4428
tom.weinhold@cushwake.com

SHEILA BALE
Managing Director
+1 602 224 4454
sheila.bale@cushwake.com

KRISTINA CUTILLO
Associate
+1 602 224 4453
kristina.cutillo@cushwake.com

2555 E Camelback Road, Suite 400
Phoenix, Arizona 85016
main +1 602 954 9000 | fax +1 602 253 0528
cushmanwakefield.com



PierPont Commons | Office Condos

4838 E Baseline Road - Bldg 1, Mesa, AZ 85206

FOR SALE
 FOR LEASE: SHORT-TERM
 OFFICE SPACE AVAILABLE



Existing Medical in
 Portion of Property



TOM WEINHOLD
 Managing Director
 +1 602 224 4428
 tom.weinhold@cushwake.com

SHEILA BALE
 Managing Director
 +1 602 224 4454
 sheila.bale@cushwake.com

KRISTINA CUTILLO
 Associate
 +1 602 224 4453
 kristina.cutillo@cushwake.com

2555 E Camelback Road, Suite 400
 Phoenix, Arizona 85016
 main +1 602 954 9000 | fax +1 602 253 0528
 cushmanwakefield.com

Partial Floor Plan

Study for proposed
ambulatory surgery
facility

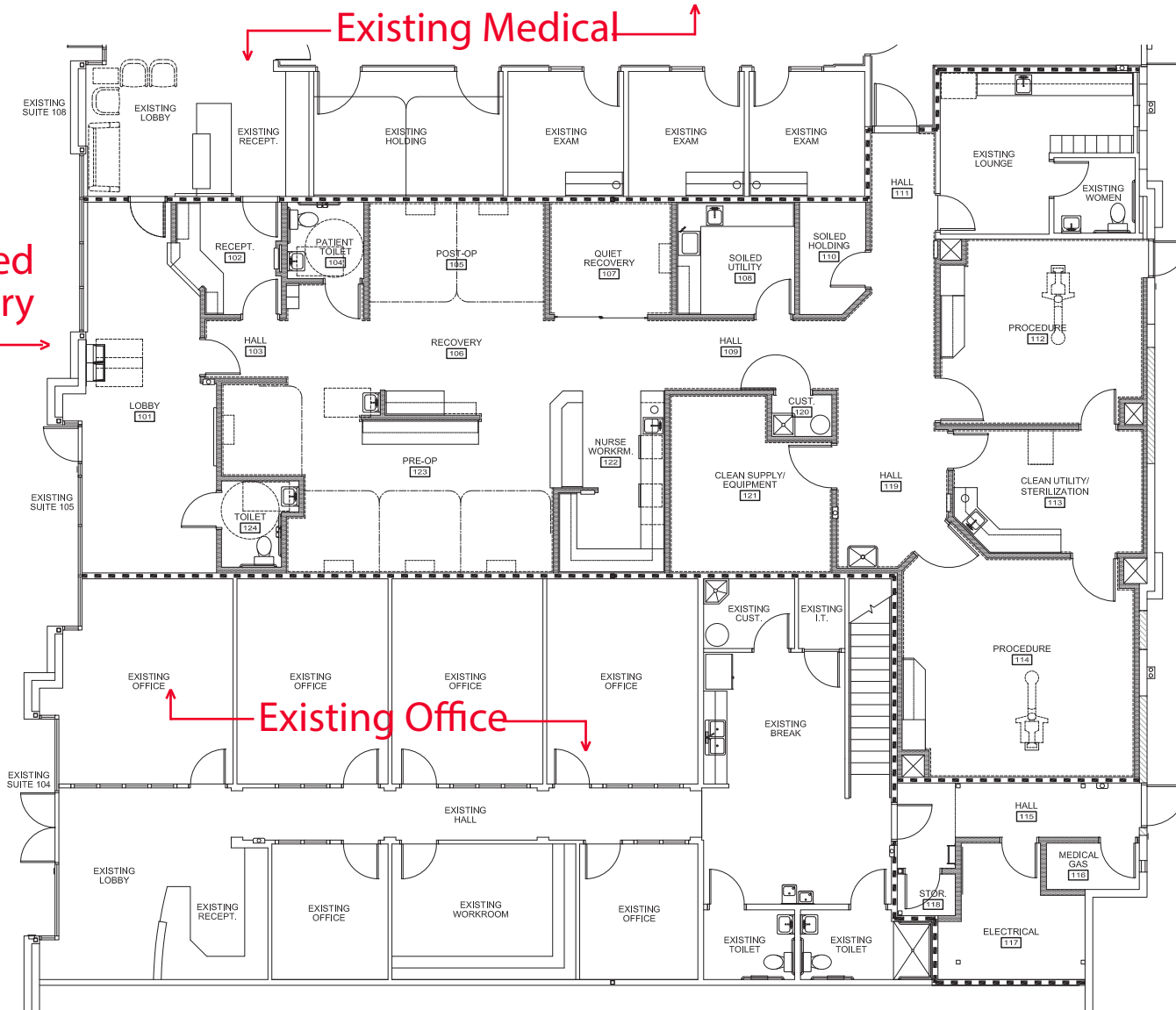

TOM WEINHOLD
Managing Director
+1 602 224 4428
tom.weinhold@cushwake.com

SHEILA BALE
Managing Director
+1 602 224 4454
sheila.bale@cushwake.com

KRISTINA CUTILLO
Associate
+1 602 224 4453
kristina.cutillo@cushwake.com

2555 E Camelback Road, Suite 400
Phoenix, Arizona 85016
main +1 602 954 9000 | fax +1 602 253 0528
cushmanwakefield.com



PierPont Commons | Office Condos

4838 E Baseline Road - Bldg 1, Mesa, AZ 85206

FOR SALE
 FOR LEASE: SHORT-TERM
 OFFICE SPACE AVAILABLE



TOM WEINHOLD
 Managing Director
 +1 602 224 4428
 tom.weinhold@cushwake.com

SHEILA BALE
 Managing Director
 +1 602 224 4454
 sheila.bale@cushwake.com

KRISTINA CUTILLO
 Associate
 +1 602 224 4453
 kristina.cutillo@cushwake.com

2555 E Camelback Road, Suite 400
 Phoenix, Arizona 85016
 main +1 602 954 9000 | fax +1 602 253 0528
 cushmanwakefield.com