

PRIME RETAIL SPACE ADJACENT TO KOHL'S

Stockbridge, GA 30281 | 5005 Mr. Zion Parkway | Mt. Zion Pkwy & Hwy 138 | #437



AVAILABLE SF:
24,700 SF

FRONTAGE:
97'7"

ZONING:
COMMERCIAL

RATES:
CALL FOR DETAILS

AREA ANCHORS



- 24,700 SF junior anchor end cap available fronting Mt. Zion Pkwy
- Area retailers include Brandsmart, At Home, Lowe's and Kroger
- Full access points via Mt. Zion Pkwy

DEMOGRAPHICS	1 MILE	3 MILES	5 MILES	TRAFFIC COUNTS	
2018 POPULATION	7,729	56,742	131,702	Mt. Zion Pkwy	13,100 AADT
2018 DAYTIME POPULATION	6,190	39,827	114,827	GA 138	19,900 AADT
2018 AVERAGE HH INCOME	60,133	68,410	68,090		
2018 MEDIAN HH INCOME	49,866	54,160	54,320		



FOR MORE INFORMATION, CONTACT EXCLUSIVE AGENT(S):
PATRICK BENTLEY • patrick.bentley@tscg.com • 770.955.2434

Demographics: Esri 2018 No warranty expressed or implied has been made as to the accuracy of the information provided herein, no liability assumed for error or omissions.



PRIME RETAIL SPACE ADJACENT TO KOHL'S

Stockbridge, GA 30281 | 5005 Mr. Zion Parkway | Mt. Zion Pkwy & Hwy 138 | #437



FOR MORE INFORMATION, CONTACT EXCLUSIVE AGENT(S):
 PATRICK BENTLEY • patrick.bentley@tscg.com • 770.955.2434



PRIME RETAIL SPACE ADJACENT TO KOHL'S

Stockbridge, GA 30281 | 5005 Mr. Zion Parkway | Mt. Zion Pkwy & Hwy 138 | #437



FOR MORE INFORMATION, CONTACT EXCLUSIVE AGENT(S):
 PATRICK BENTLEY • patrick.bentley@tscg.com • 770.955.2434



Demographics: Esri 2018 No warranty expressed or implied has been made as to the accuracy of the information provided herein, no liability assumed for error or omissions.

PRIME RETAIL SPACE ADJACENT TO KOHL'S

Stockbridge, GA 30281 | 5005 Mr. Zion Parkway | Mt. Zion Pkwy & Hwy 138 | #437

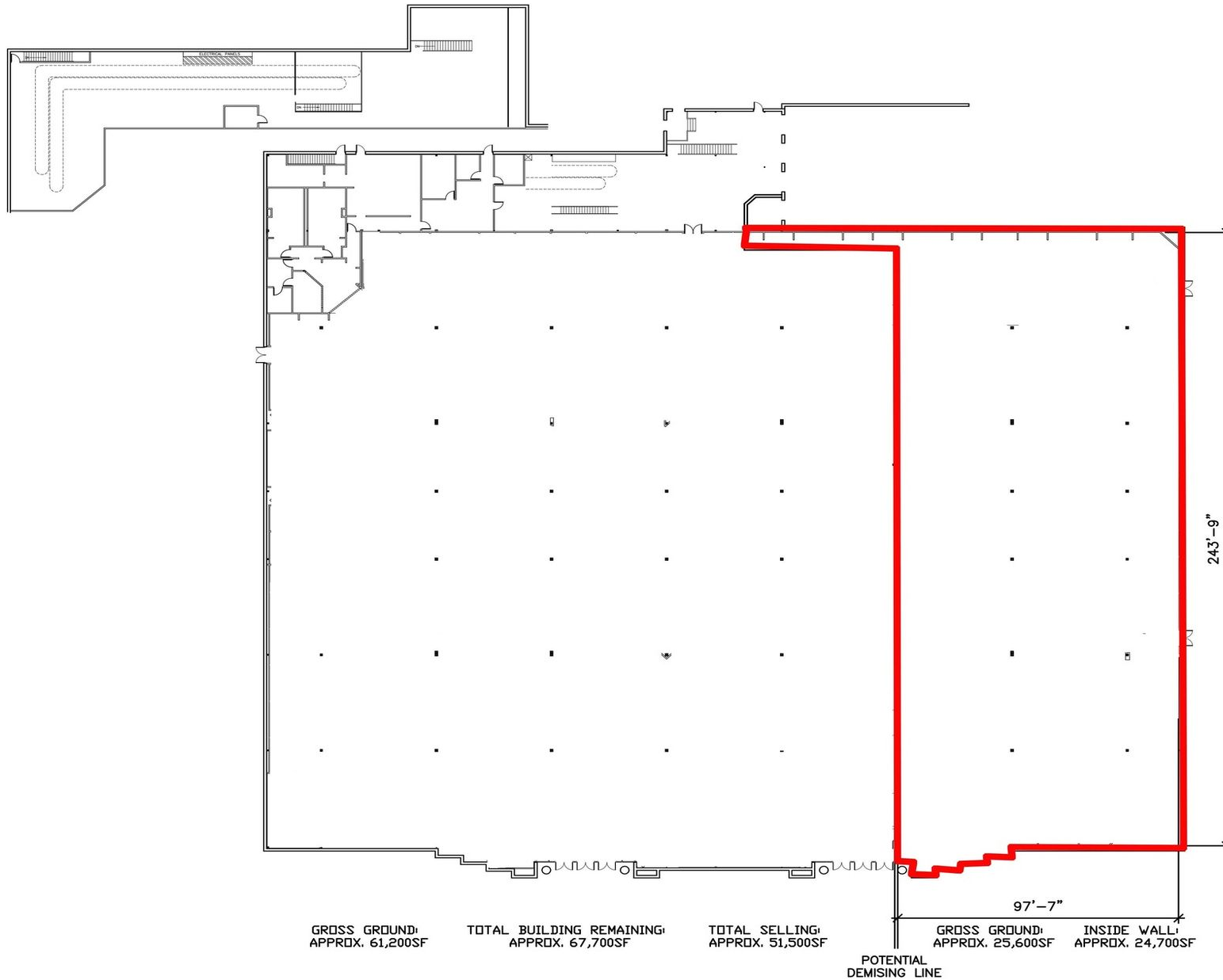

#10437 Stockbridge, GA
Updated: 3/6/18



FOR MORE INFORMATION, CONTACT EXCLUSIVE AGENT(S):
PATRICK BENTLEY • patrick.bentley@tscg.com • 770.955.2434

