

# 10 HANOVER PLACE

## HEART OF BROOKLYN TECH TRIANGLE

6,000- 18,725 RSF | \$35/RSF FOR LEASE

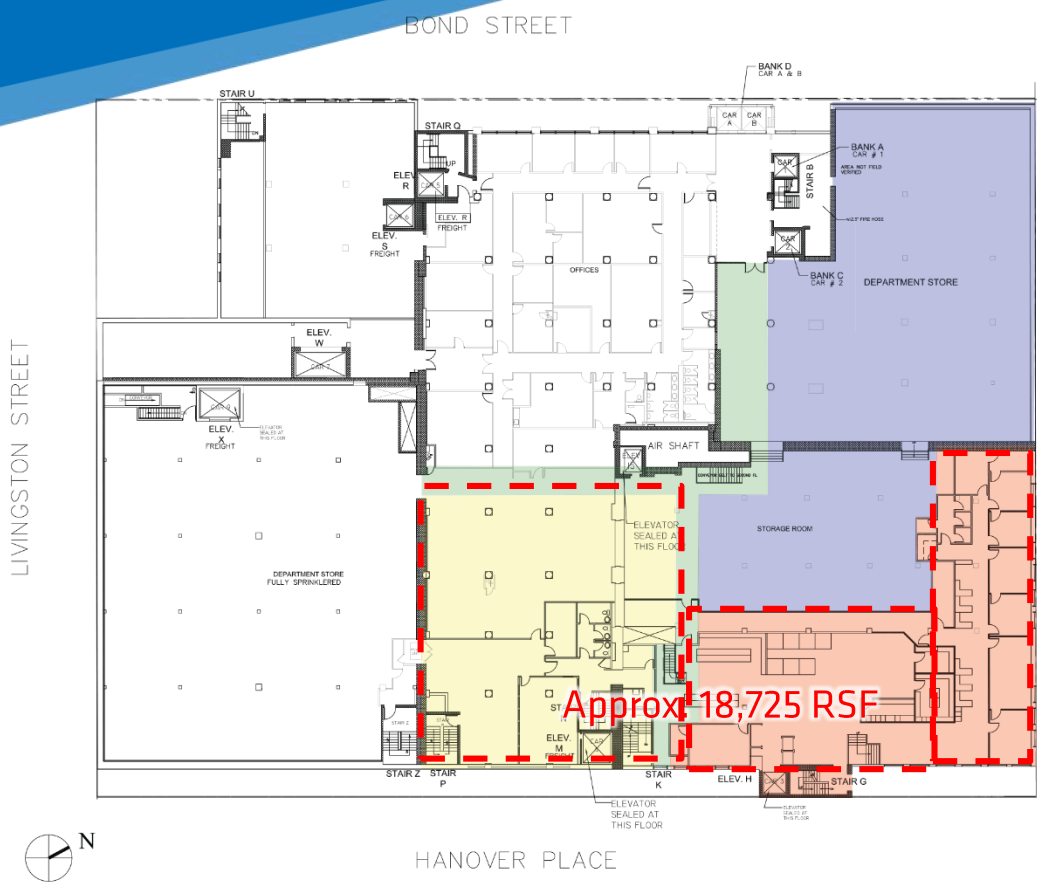

1 THIRD FLOOR PLAN  
FL-3 1/16" = 1'

### HIGHLIGHTS

- Flexible lease terms
- Boutique Offering
- As-Is Built Space
  - Conference Rooms
  - Private Offices
  - Private Bathrooms
- Exposed 10+ ceilings

### CROSS STREETS

Fulton St. and Hanover Pl.

### NEIGHBORING TENANTS

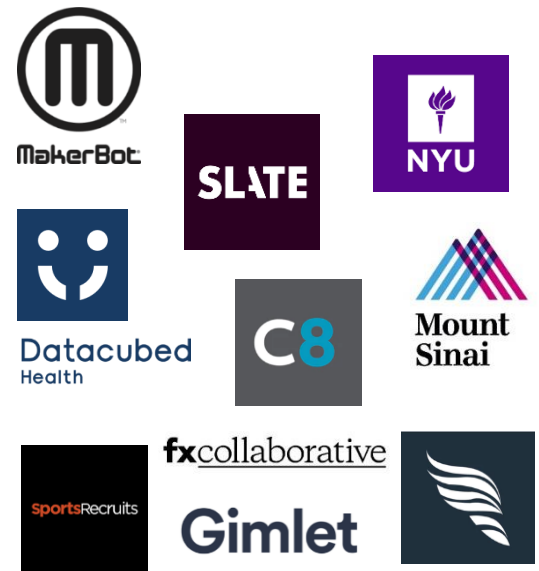

For more information, contact exclusive agents:

**Caroline Pardo**  
Managing Director, Office Leasing  
cpardo@terracrgr.com  
718-355-8942

**Christopher Havens**  
Managing Director, Office Leasing  
chavens@terracrgr.com  
718-489-0077

# 10 HANOVER PLACE

DOWNTOWN BROOKLYN

6,000-18,725 RSF | \$35/RSF FOR LEASE



### TRANSPORTATION

3 min walk to

**B Q R 2 3 4 5 A G**

B38, B52, B25, B26, B65, B37 Bus Routes

For more information, contact exclusive agents:

**Caroline Pardo**  
Managing Director, Office Leasing  
cpardo@terracr.com  
718-355-8942

**Christopher Havens**  
Managing Director, Office Leasing  
chavens@terracr.com  
718-489-0077

