

# SAND HILL COMMONS

Class A Office  
**AVAILABLE FOR LEASE**

2882-2884 SAND HILL ROAD, MENLO PARK, CA



**Newmark  
Knight Frank**

MIKE COURSON ♦ 650.688.8527

MARK COURSON ♦ 650.358.5272



# MARKET READY SUITE COMPLETE



**2882**  
Sand Hill Road

**SUITE 280**





# SAND HILL

COMMONS

## AVAILABLE SPACE

### 2882 SAND HILL ROAD

**First Floor**  
**LEASED**

### **Second Floor**

Suite 280: ±5,098 SF Available

### 2884 SAND HILL ROAD

Suite 110: ±2,311 SF Available

Suite 210: ±2,831 SF Available

## PROPERTY HIGHLIGHTS

Property Overview

- ◆ Premier Office Location Adjacent to Stanford University & Research Park
- ◆ Headquarters Locations for Globally Recognized Venture Capital & Private Equity Firms
- ◆ Exceptional Tenancy with Substantial Tenant Investment
- ◆ Direct Access to Executive Housing Corridor and Major Transportation Arteries
- ◆ Prominent Sand Hill Address
- ◆ High End Tenant Improvements Available
- ◆ Beautiful Courtyard Views
- ◆ Building Amenities include Café, Workout Facility with Lockers and Showers and Shared Conference Room
- ◆ Magnificently Manicured Landscaped Grounds
- ◆ Installing 4 EV Charging Stations





DOWNTOWN PALO ALTO

STANFORD MEDICAL CENTER

Stanford University

MOFFETT AIRFIELD

DOWNTOWN MOUNTAIN VIEW

DOWNTOWN SAN JOSE

EL CAMINO REAL

PAGE MILL ROAD

STANFORD SHOPPING CENTER

SLAC  
NATIONAL ACCELERATOR LABORATORY

SAND HILL ROAD

SAND HILL  
COMMONS

ROSEWOOD SAND HILL  
MENLO PARK, CALIFORNIA

SHARON HEIGHTS GOLF & COUNTRY CLUB

**AERIAL**  
Aerial Map



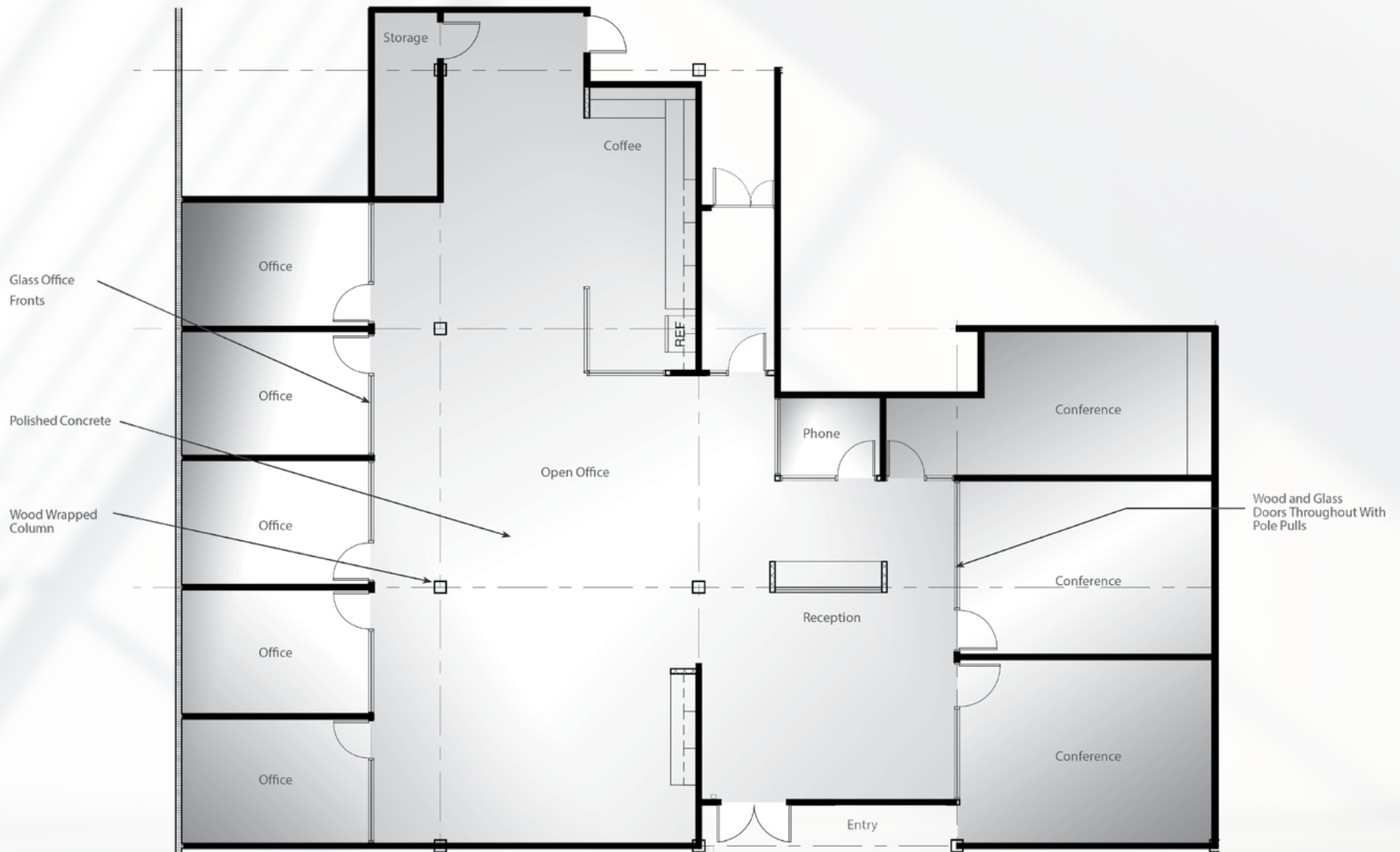

**SUITE 110: ±2,311 SF**

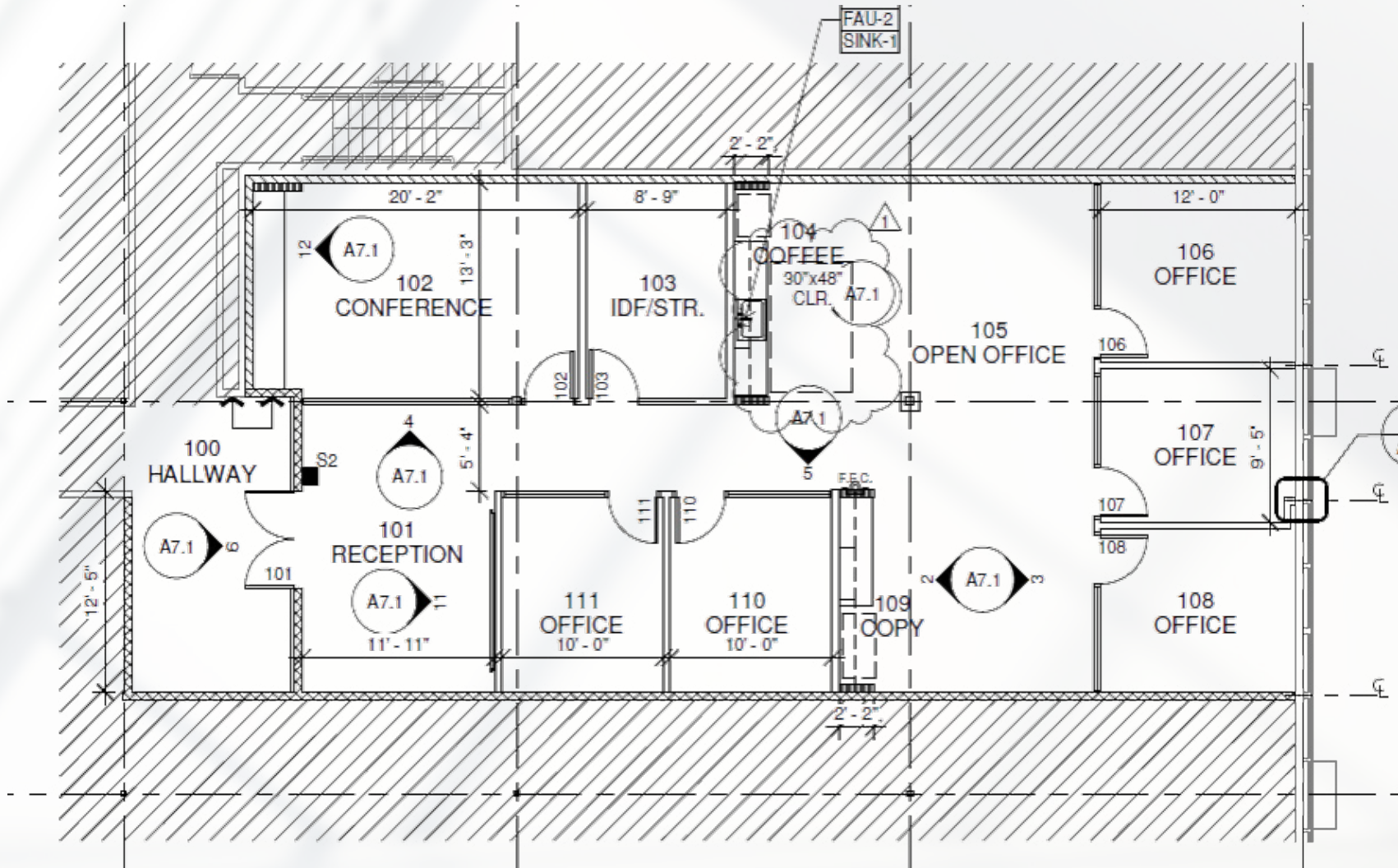

**SUITE 210: ±2,831 SF**

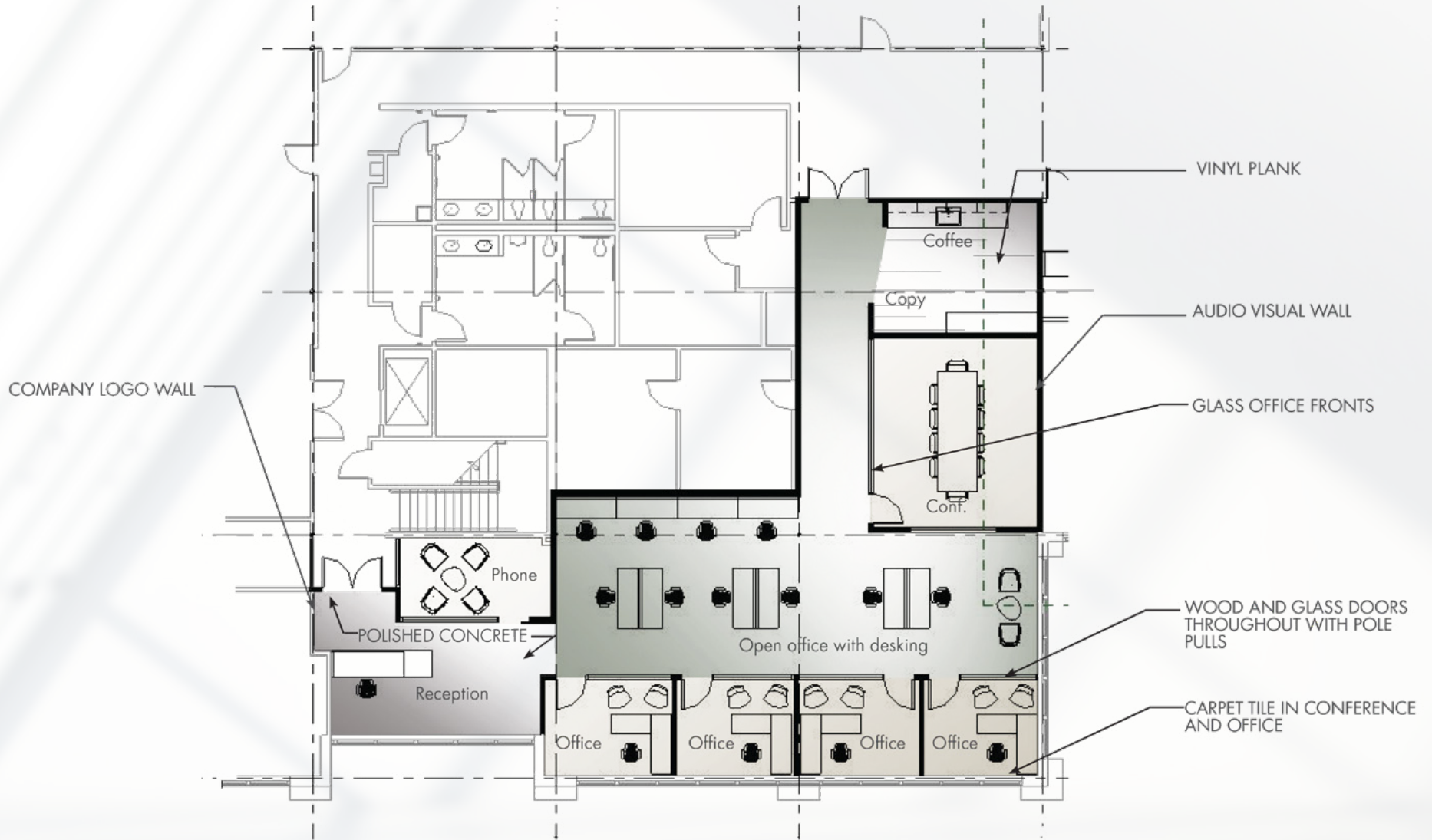





IMAGES OF COURTYARD



BACK LIT WOOD CEILING

BACK-LIT WOOD WALL

HYPOTHETICAL RENDERINGS OF LOBBY



BACK LIT WOOD CEILING

BACK LIT WOOD WALL

LOGO

WOOD & SOLID SURFACE RECEPTION



# SAND HILL COMMONS

2882-2884 SAND HILL ROAD, MENLO PARK, CA



Executive Managing Director

**Mike Courson**  
650.688.8527  
mcourson@ngkf.com  
CA RE License #01358961

Director

**Mark Courson**  
650.358.5272  
mtcourson@ngkf.com  
CA RE License #01704280



PALO ALTO OFFICE | 245 Lytton Avenue, Suite 150, Palo Alto ♦ SAN MATEO OFFICE | 2950 South Delaware Street, Suite 125, San Mateo | 15-1061.09/20

The distributor of this communication is performing acts for which a real estate license is required. The information contained herein has been obtained from sources deemed reliable but has not been verified and no guarantee, warranty or representation, either express or implied, is made with respect to such information. Terms of sale or lease and availability are subject to change or withdrawal without notice.