

SHELL SPECIFICATIONS AND ELEVATIONS ARE BY WAY OF EXAMPLE ONLY AND ARE SUBJECT TO CHANGE. SPECIFIC IMPROVEMENTS WILL BE NEGOTIATED WITH INDIVIDUAL PURCHASERS.

BUILDING GROSS S.F. (A, B, C, D, E, F, and G) AND TOTAL S.F. ARE PROJECTED/ESTIMATED ONLY.

Building	Gross S.F.
A	8,153
B	6,768
C	20,425
D	7,928
E	4,065
F	4,720
G	3,263
Total:	55,322

Fiducia Real Estate LLC

**Qualifying Broker/ Owner:**  
**Steven L. Howard**  
(505) 507-5551

**Las Cruces,  
New Mexico**

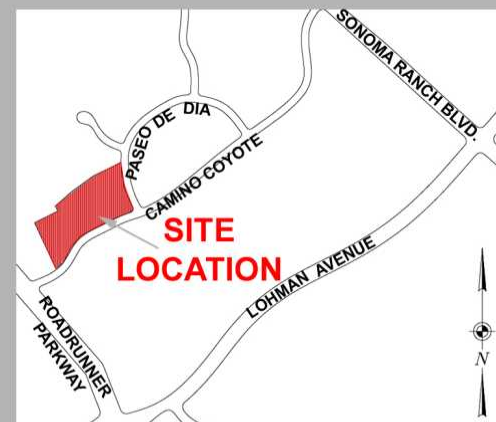

# South Fork Business Park

A Simon Properties LLC. (Office Building Project - for Sale/Lease)