



CATHEDRAL *Commons*

WASHINGTON, D.C.

Leasing by

HR
RETAIL

A MEMBER OF
CHAIN LINKS
RETAIL ADVISORS



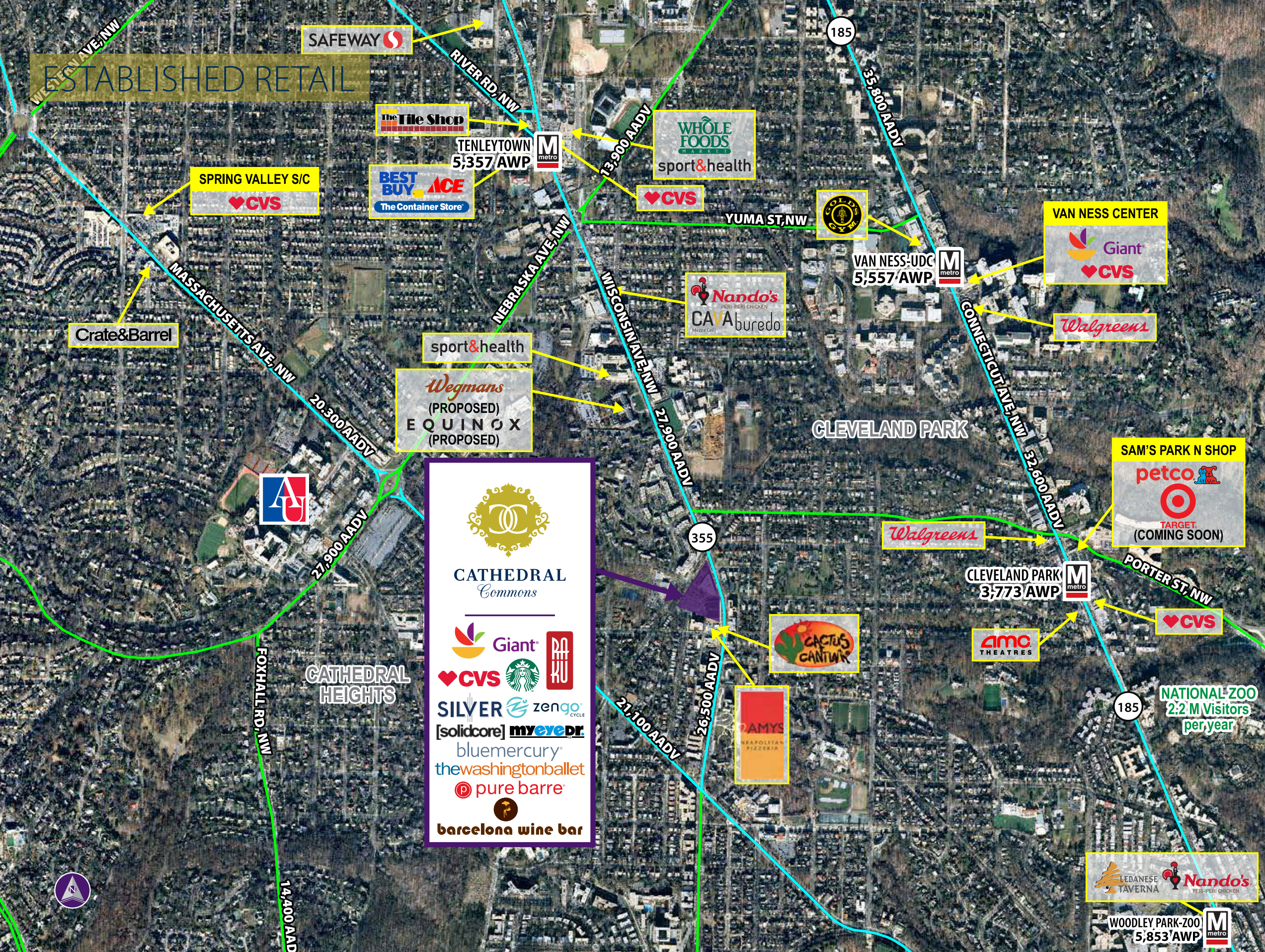

MASTER PLAN

4,528 SF of Street Front Retail

124 Apartments
19,373 SF of Street Front Retail

4,169 SF of Restaurant

8 Townhomes

13 Apartments

Newark Street, NW

13,852 SF of Street Front Retail

12,440 SF of Street Front Retail

13,898 SF of Second Level Retail/Office Space

 **Giant**
56,000 SF

26,500 AADV



CATHEDRAL
Commons

RETAIL LAYOUT



- Site Plan Key**
- OPEN
 - SIGNED LEASE
 - LEASE IN NEGOTIATIONS
 - AVAILABLE



Site Plan Key

- OPEN
- SIGNED LEASE
- LEASE IN NEGOTIATIONS
- AVAILABLE



NORTH PARCEL

SOUTH PARCEL GROUND LEVEL

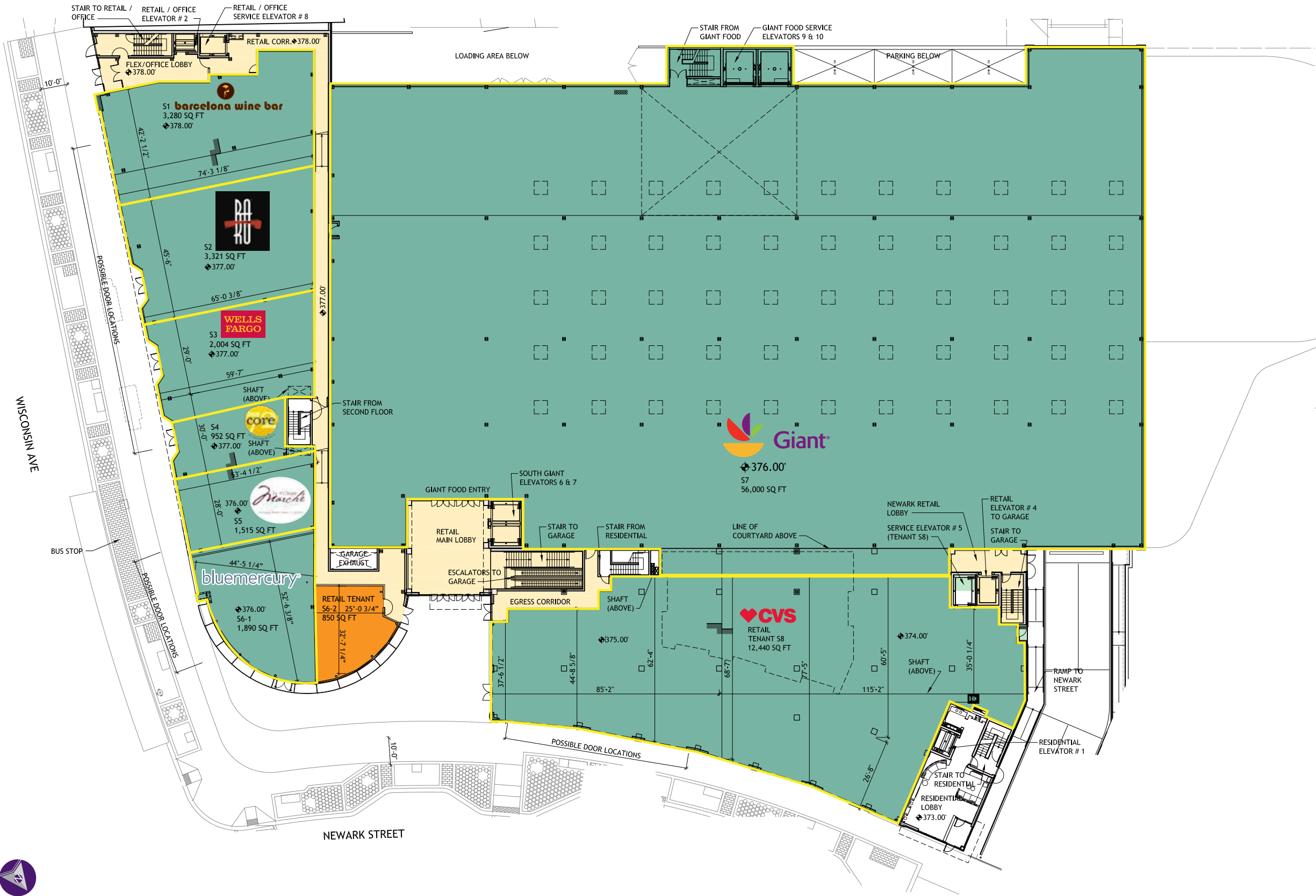



WISCONSIN AVENUE, NW



WISCONSIN AVENUE, NW

WASHINGTON, D.C.

www.hrretail.com



RAKU

WASHINGTON, D.C.

9

www.hrretail.com



BLUEMERCURY



LE VILLAGE MARCHÉ



SOLIDCORE



KRISER'S NATURAL PET

MARKET PROFILE (3 MILES)



KEY FACTS

316,611

Population

34.8

Median Age



2.0

Average Household Size

\$108,564

Median Household Income

Age Pyramid

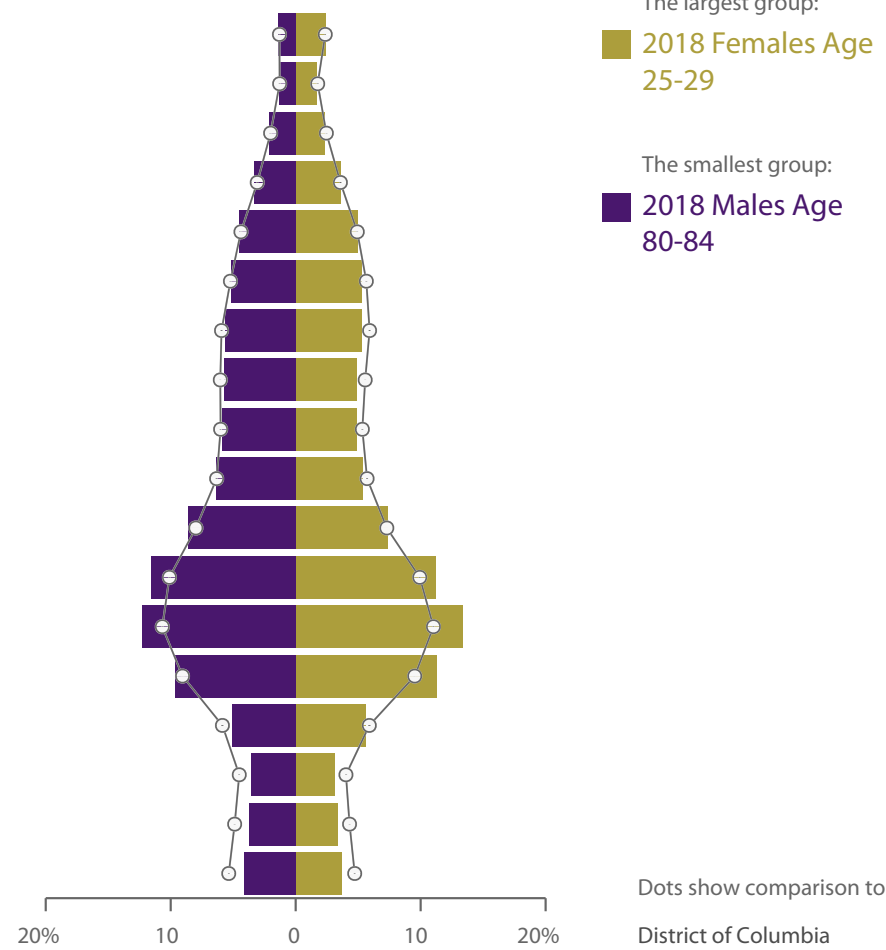

ANNUAL LIFESTYLE SPENDING

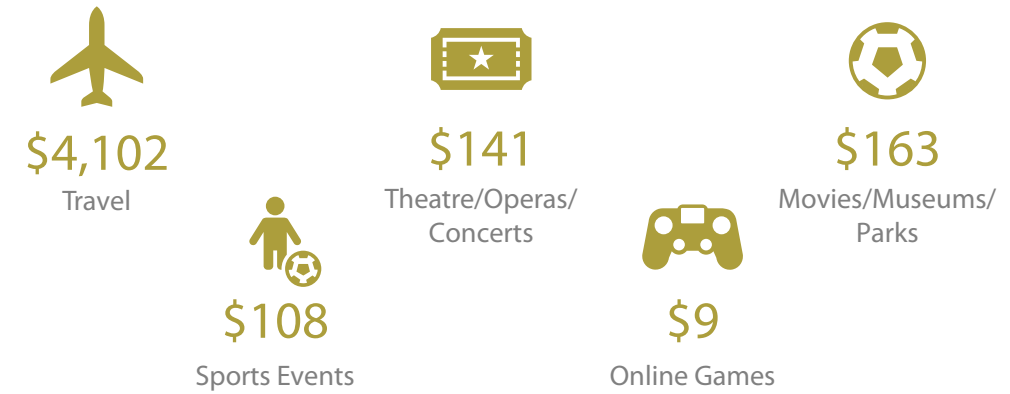

Tapestry Segments

	3A Laptops and Lattes 57,043 households	38.4% of Households
	3B Metro Renters 40,082 households	26.3% of Households
	3C Trendsetters 19,320 households	12.8% of Households

ANNUAL HOUSEHOLD SPENDING

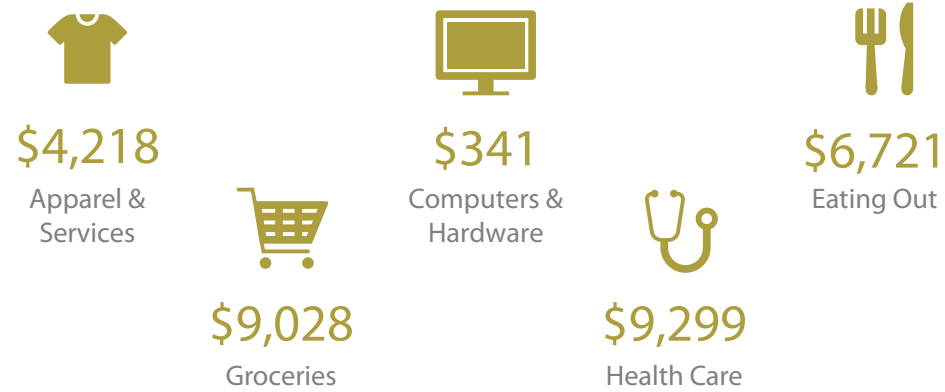

EDUCATION

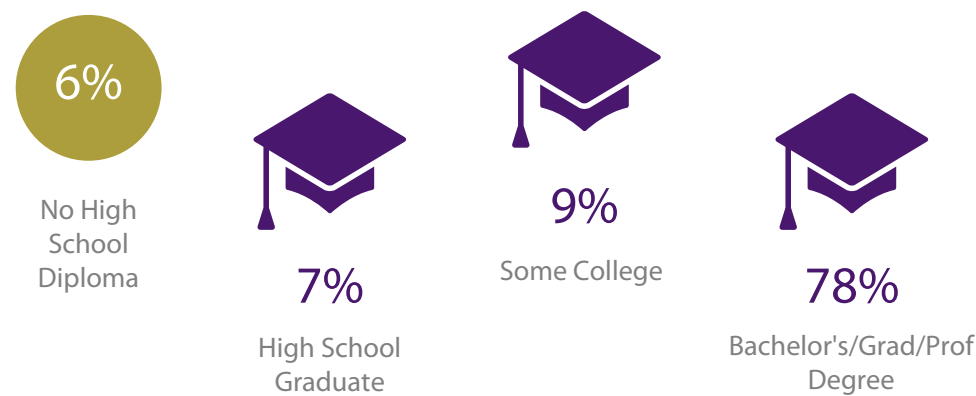



CATHEDRAL *Commons*

WASHINGTON, D.C.



Please Contact:

David A. Ward
240.482.3617
dward@hrretail.com

James P. Crilley
240.482.3605
jcrilley@hrretail.com

Spencer B. Ward
240.482.3614
sward@hrretail.com

WASHINGTON, DC
7201 Wisconsin Avenue
Suite 600
Bethesda, MD 20814
Telephone: 301.656.3030

BALTIMORE, MD
2800 Quarry Lake Drive
Suite 320
Baltimore, MD 21209
Telephone: 410.308.0800

Leasing by



Information herein has been obtained from sources believed to be reliable. While we do not doubt its accuracy, we have not verified it and make no guarantee, warranty or representation about it. Independent confirmation of its accuracy and completeness is your responsibility, H&R Retail, Inc.

110618

www.hrretail.com