

FOR LEASE > CLASS A OFFICE SPACE



Everett Mall Office Park III

906 EVERETT MALL WAY, EVERETT, WA 98208



Available Space

- > Suite 101: 1,165 RSF (Former Deli space)
- > Suite 120: 1,484 RSF
- > Suite 130: 1,483 RSF
- > Suite 2XX: 2,285 RSF
- > Suite 100: 2,500 RSF
- > Suite 140: 2,556 RSF
- > Suites 120/130/140: 5,523 RSF
- > Suite 210: 6,527 RSF
- > Suite 200: 13,420 RSF
- > Suites 200/210/2XX: 22,052 RSF
- > Suite 300: 22,500 RSF

Features

- > Prime location with excellent access to I-5
- > Available immediately
- > Four parking stalls/1,000 SF

Rate

- > \$14.50/SF, NNN



DEREK HEED
425 453 3133
BELLEVUE, WA
derek.heed@colliers.com

GREGG RIVA
425 453 3132
BELLEVUE, WA
gregg.riva@colliers.com

COLLIERS INTERNATIONAL
11225 SE 6th Street, Suite 240
Bellevue, WA 98004
www.colliers.com

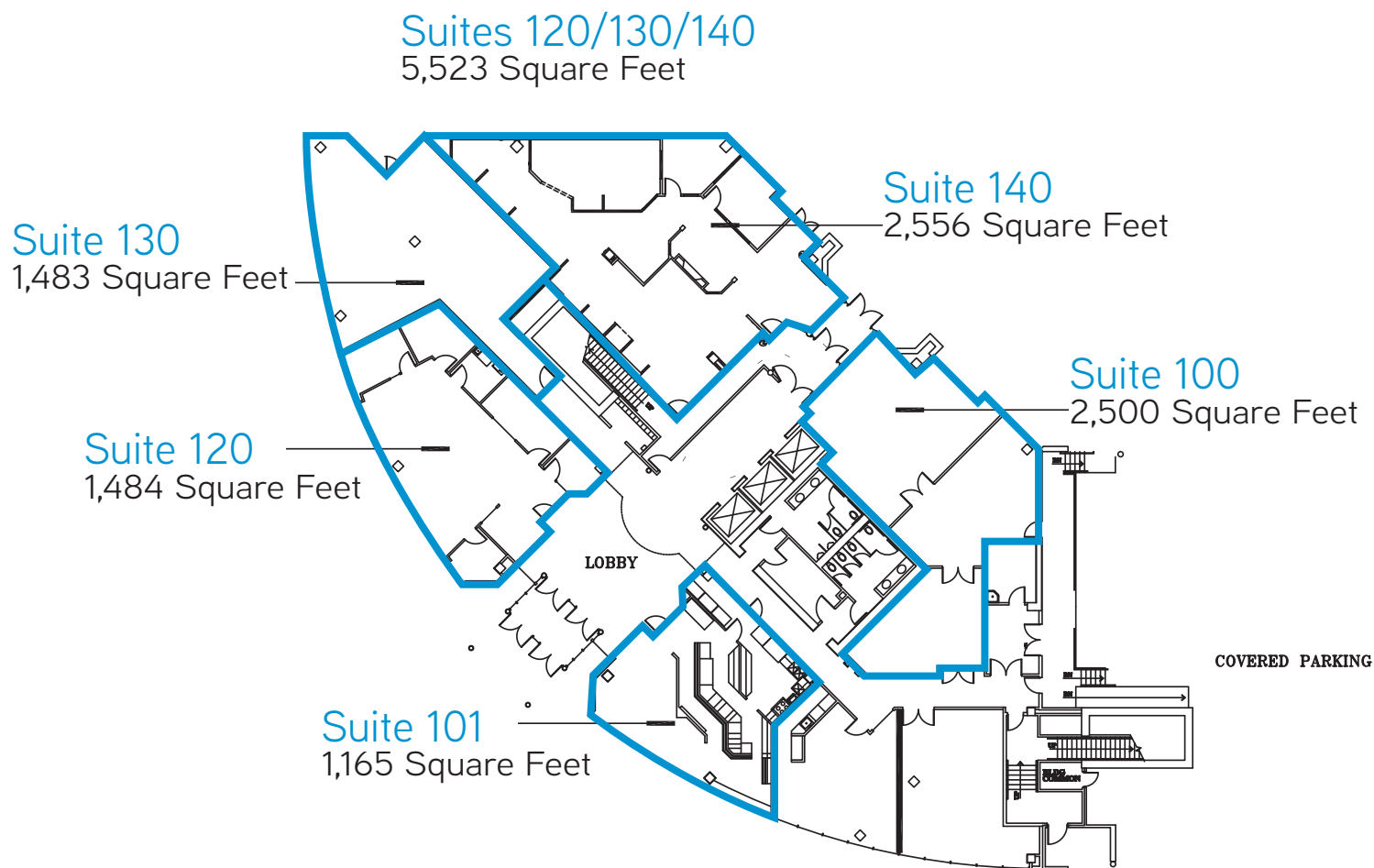

FOR LEASE > EVERETT MALL OFFICE PARK III

Entire 2nd Floor
22,052 Square Feet

Suite 200
13,420 Square Feet

Suite 210
6,527 Square Feet

Suite 2XX
2,285 Square Feet

Suite 300
22,500 Square Feet

DEREK HEED
425 453 3133
BELLEVUE, WA
derek.heed@colliers.com

GREGG RIVA
425 453 3132
BELLEVUE, WA
gregg.riva@colliers.com

COLLIERS INTERNATIONAL
11225 SE 6th Street, Suite 240
Bellevue, WA 98004
www.colliers.com

This document has been prepared by Colliers International for advertising and general information only. Colliers International makes no guarantees, representations or warranties of any kind, expressed or implied, regarding the information including, but not limited to, warranties of content, accuracy and reliability. Any interested party should undertake their own inquiries as to the accuracy of the information. Colliers International excludes unequivocally all inferred or implied terms, conditions and warranties arising out of this document and excludes all liability for loss and damages arising there from. This publication is the copyrighted property of Colliers International and /or its licensor(s). © 2016. All rights reserved.

