

# For Sale or Lease

## Guild's Lake Manufacturing/Warehouse Facility

3033 NW Yeon Avenue • Portland, OR 97210

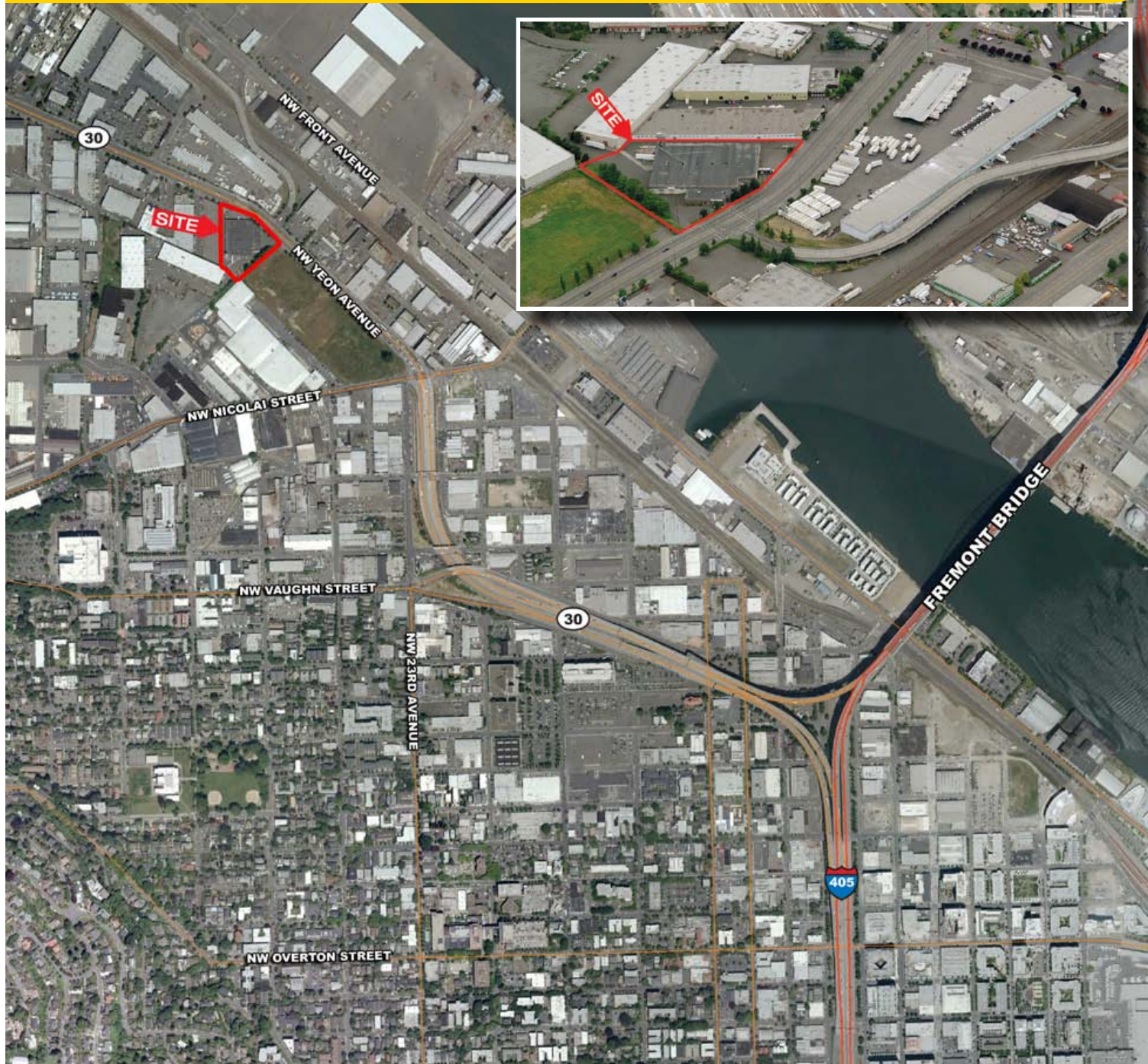

- Premier close-in NW Portland location
- Located within close proximity to Portland CBD and Pearl District
- Large residential and retail base nearby
- Significant support services and amenities in close proximity

**Grubb & Ellis Company**  
 1120 NW Couch Street • Suite 350  
 Portland Oregon 97209  
[www.grubb-ellis.com](http://www.grubb-ellis.com)



The information contained herein was obtained from sources believed reliable; however, Grubb & Ellis Company makes no guarantees, warranties, or representations as to the completeness or accuracy thereof. The presentation of this property is submitted subject to errors, omissions, change of price or conditions prior to sale or lease, or withdrawal without notice.

# For Sale or Lease

## Guild's Lake Manufacturing/Warehouse Facility

3033 NW Yeon Avenue • Portland, OR 97210



- Gross Building Area: 55,163 SF
- Divisible down to ±15,000 SF
- Office Area: 6,808 SF (attached/divisible)
- 2.68 acre parcel
- Truck Loading: 6 dock-high; 2 grade level
- Clear Height: 15 feet
- Year Built: 1954/2011 updated
- Warehouse Features: Wet sprinklers, heavy power and power drops throughout
- Zoning: Heavy Industrial
- Located with 1/2 mile of I-405 access

**LEASE RATE: \$.32/SF/Mo. Shell - \$.65/SF/Mo. Office - NNN**  
**SALE PRICE: \$3,250,000 (\$58.87/SF)**

To learn more, please contact:

**David Hill**  
 Senior Vice President  
 503.972.5510  
[david.hill@grubb-ellis.com](mailto:david.hill@grubb-ellis.com)



1120 NW Couch Street • Suite 350, Portland, Oregon 97209 • [www.grubb-ellis.com](http://www.grubb-ellis.com)

# For Sale or Lease

## Guild's Lake Manufacturing/Warehouse Facility

3033 NW Yeon Avenue • Portland, OR 97210



Existing Site Plan

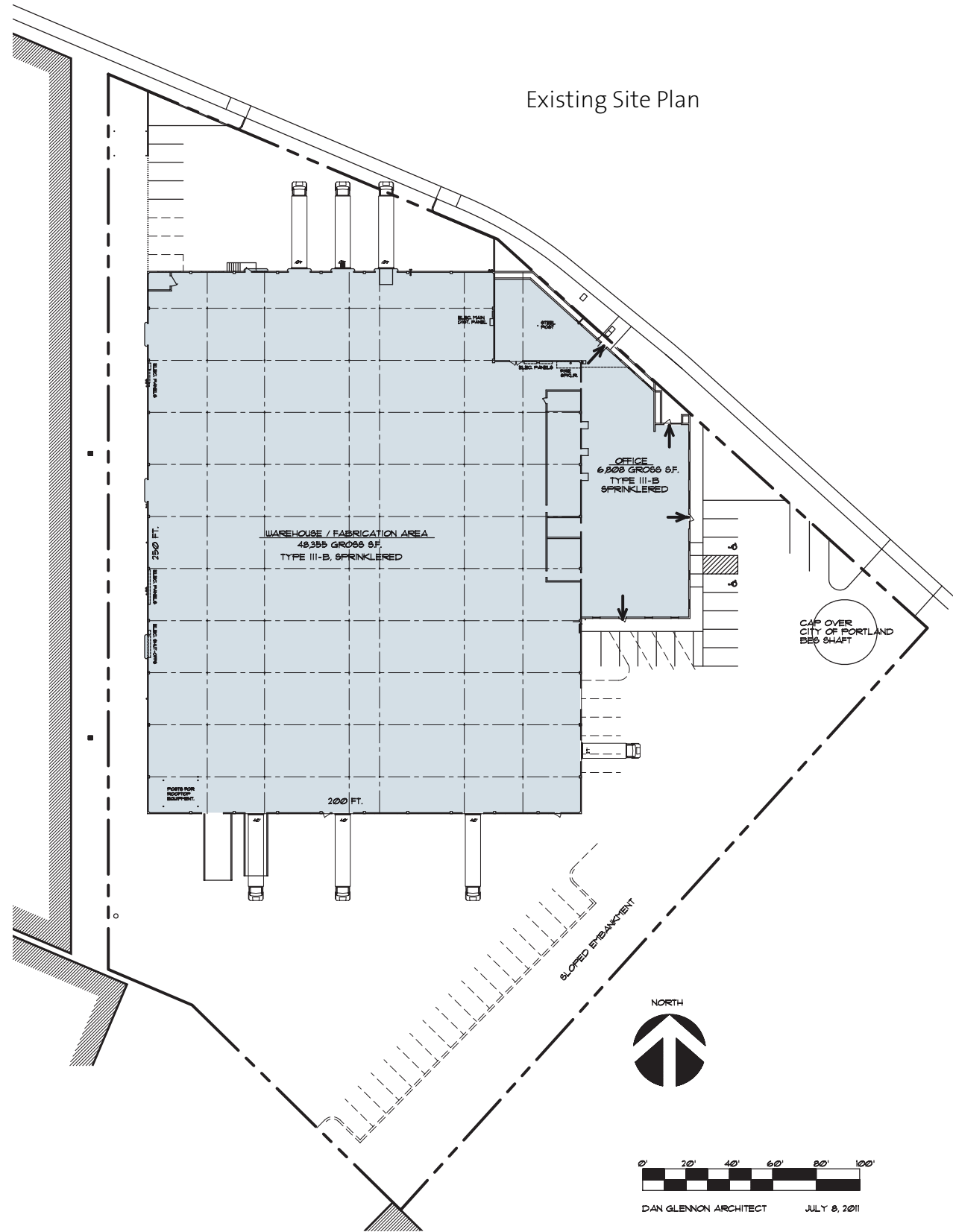

Two Tenant Scenario

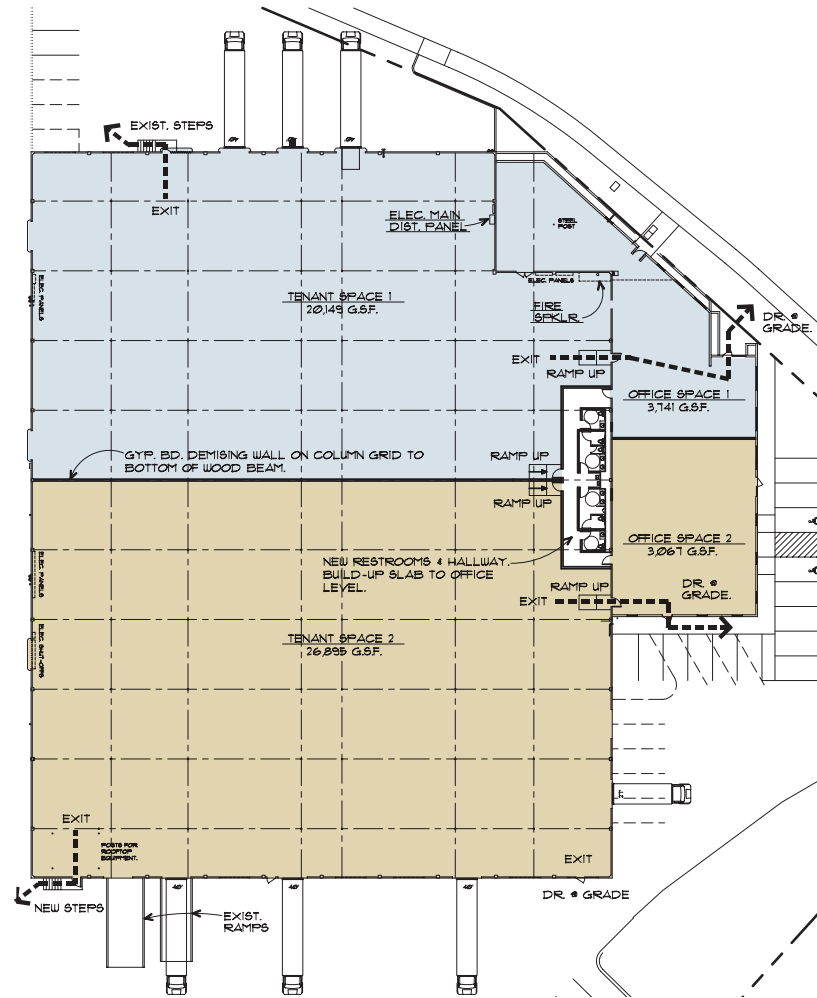

Three Tenant Scenario

