



**CUSHMAN &
WAKEFIELD**
Commerce

FOR SALE OR LEASE

10600 South 1000 East
Sandy, Utah



APPROXIMATELY 1 ACRE

Property Highlights

- Rare east side Sandy
- Anchored by Big 5
- Hard corner available for sale or lease

Approximately 1 Acre

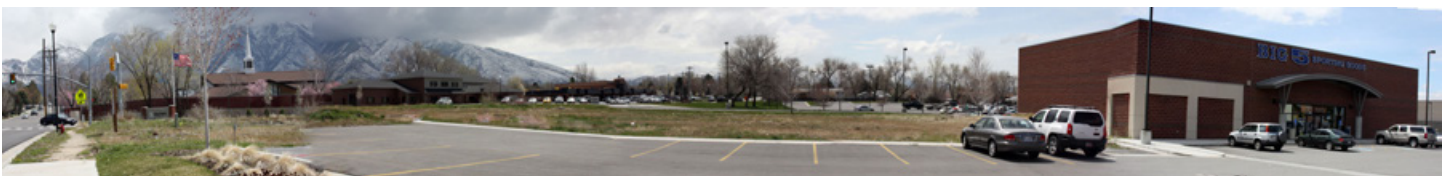

Nick Clark
Senior Director
+1 801 303 5430
nclark@comre.com

170 South Main Street
Suite 1600
Salt Lake City, UT 84101
Main +1 801 322 2000
Fax +1 801 322 2040
comre.com

Independently Owned and Operated / A Member of the Cushman & Wakefield Alliance

Cushman & Wakefield Copyright 2015. No warranty or representation, express or implied, is made to the accuracy or completeness of the information contained herein, and same is submitted subject to errors, omissions, change of price, rental or other conditions, withdrawal without notice, and to any special listing conditions imposed by the property owner(s). As applicable, we make no representation as to the condition of the property (or properties) in question.
(path: G:\1 - Projects\Clark, Nick\1 - Flyers\10600 S 1000 E)



**CUSHMAN &
WAKEFIELD**
Commerce

FOR SALE OR LEASE

10600 South 1000 East
Sandy, Utah

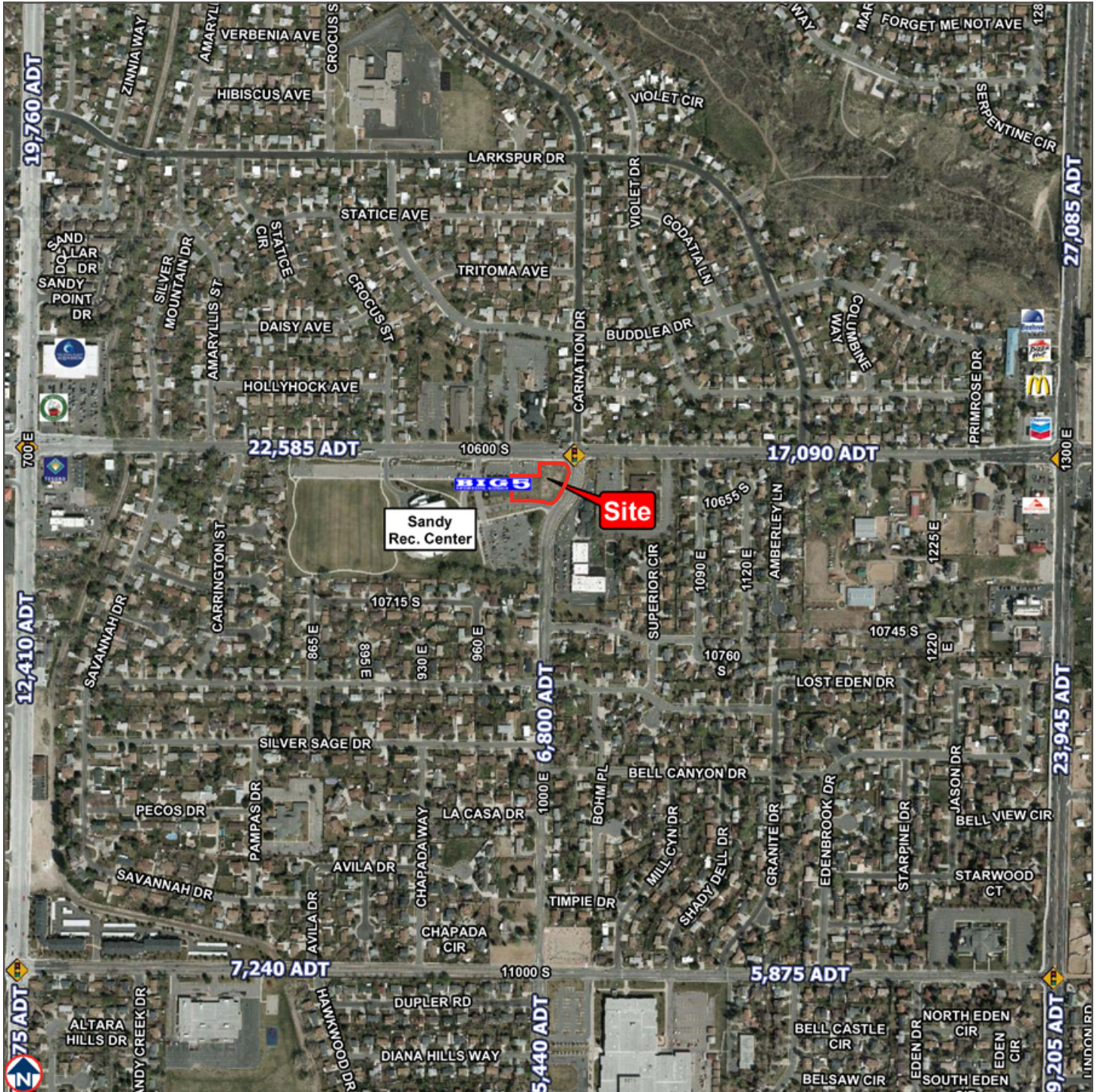

Nick Clark
Senior Director
+1 801 303 5430
nclark@comre.com

170 South Main Street
Suite 1600
Salt Lake City, UT 84101
Main +1 801 322 2000
Fax +1 801 322 2040
comre.com

Independently Owned and Operated / A Member of the Cushman & Wakefield Alliance

Cushman & Wakefield Copyright 2015. No warranty or representation, express or implied, is made to the accuracy or completeness of the information contained herein, and same is submitted subject to errors, omissions, change of price, rental or other conditions, withdrawal without notice, and to any special listing conditions imposed by the property owner(s). As applicable, we make no representation as to the condition of the property (or properties) in question.
(path: G:\1 - Projects\Clark, Nick\1 - Flyers\10600 S 1000 E)