

Last Remaining Space at 59th Street and Lexington Avenue by Bloomingdale's

127 EAST 59TH STREET
NEW YORK, NY



BLOOMINGDALE'S CORRIDOR

Ground Floor

127 East 59th Street

Location

North block between Park and Lexington Avenues

Approximate Size

Ground Floor 4,260 SF

Ceiling Height

Ground Floor 17 FT

Frontage

33 FT on East 59th Street

Possession

Immediate

Neighbors

Bloomingdale's, Sephora, Muji, FedEx (coming soon), ZARA, Starbucks, Amazon Go, Sherry Lehman, Bernardaud and Salons by JC

Comments

Fantastic retail or restaurant opportunity at the base of a newly redeveloped retail building

High-traffic retail location with an average of 40,000 pedestrians daily

Multiple signage opportunities including a highly visible shared 25-SF blade sign

Dense and affluent residential population with over 32,000 residential units within a half mile

At the entrance to the eighth busiest subway station in NYC servicing the **4 5 6 N R** and **W** lines with over 22 million annual subway riders

There is over three million SF of office space on this block of East 59th Street from Park to Lexington Avenues with office tenants including Estee Lauder Companies, Jimmy Choo and Bloomberg

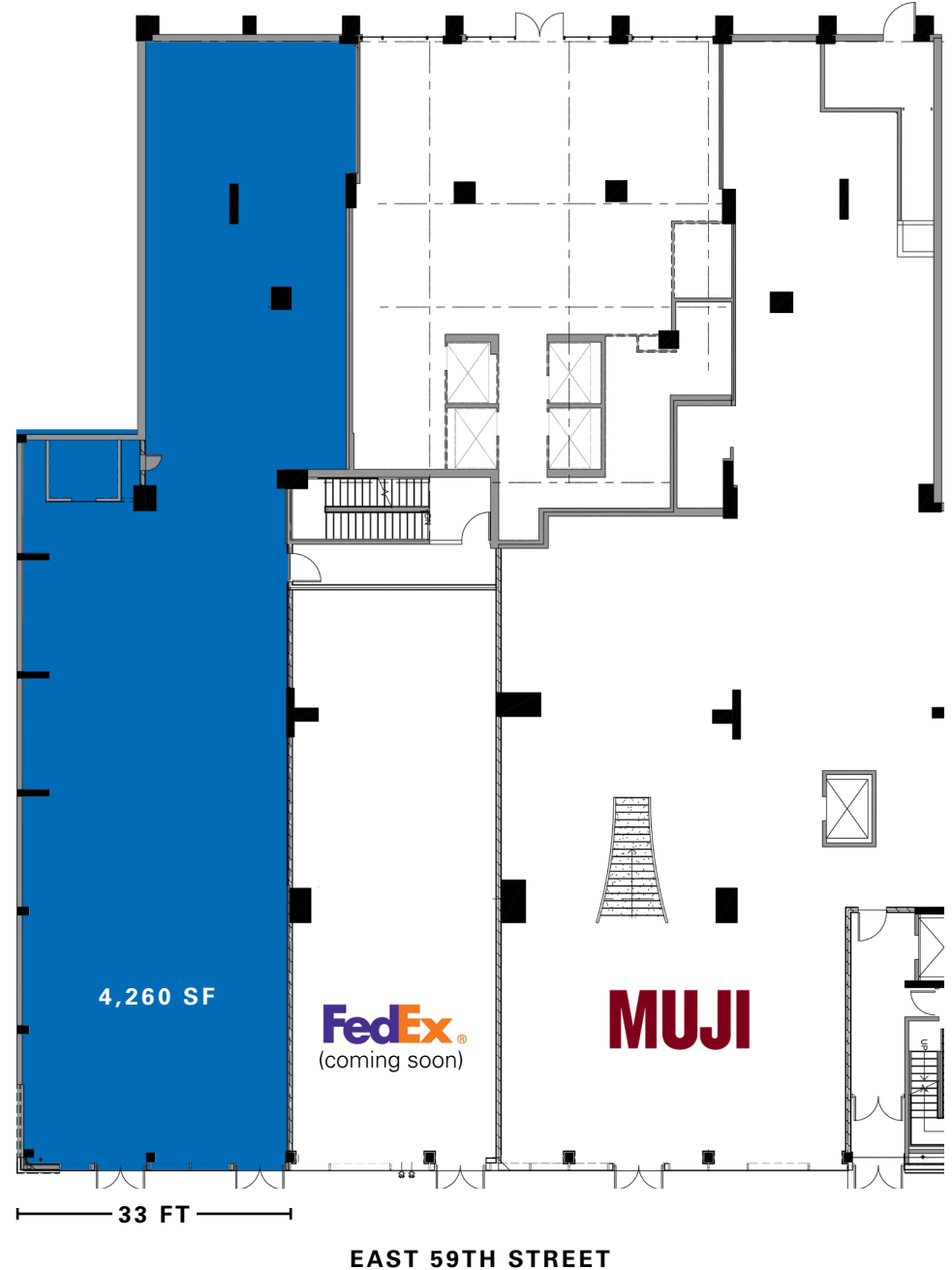

AREA MAP

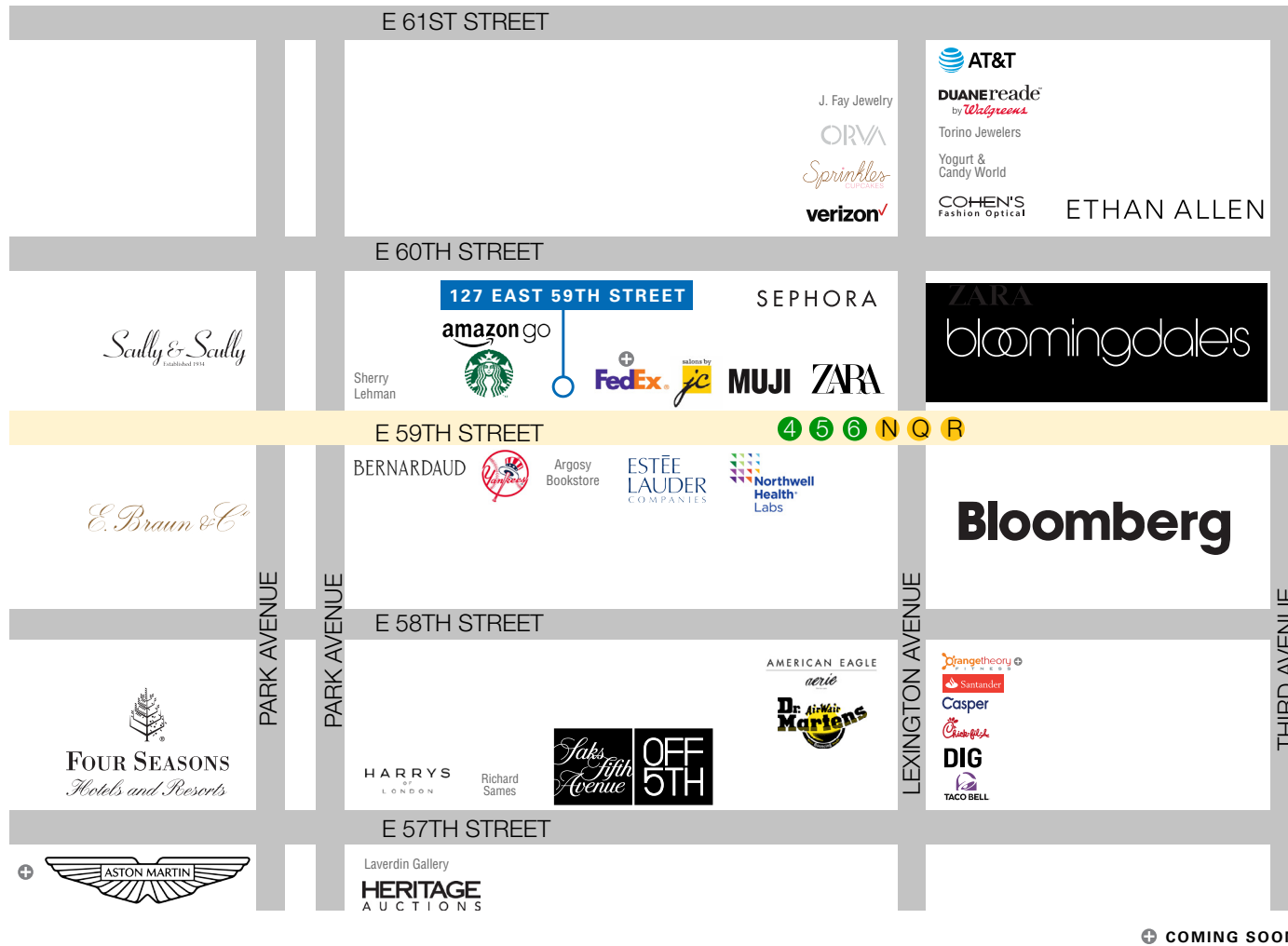

Daytime Population (1/4 mile)

Office SF	14 million
Employees	96,000

Residential Population (1/4 mile)

Residential Units	6,802
Total Residents	12,000
Average Household Income	\$184,609

CONTACT

Jeffrey D Roseman
 t 212-372-2430
 jeffrey.roseman@nrmk.com

Drew Weiss
 t 212-372-2473
 drew.weiss@nrmk.com

nrmk.com