

FOR LEASE

ALASKAN COPPER & BRASS COMPLEX

3301

6TH AVENUE S

Seattle, WA 98134



WAREHOUSE FEATURES

Location is one of the great assets of this complex. It is one block from Interstate-5, which traverses the West Coast states from Canada to Mexico. Six blocks from the Port of Seattle, which is the closest U.S. Port to the Asian marketplace, it is just two miles to Downtown Seattle and in between is Safeco Field and CenturyLink Field, Seattle's two major sports facilities.

Site Specifics	
Warehouse	9,686 SF
Office	0 SF
Doors	1 Drive-in (16'h x 23'w)
Clear Height	30' + ceiling, 24' to bottom of rail, 21' under hook
Fire Safety	Dry sprinkler system
Power	800 Amps

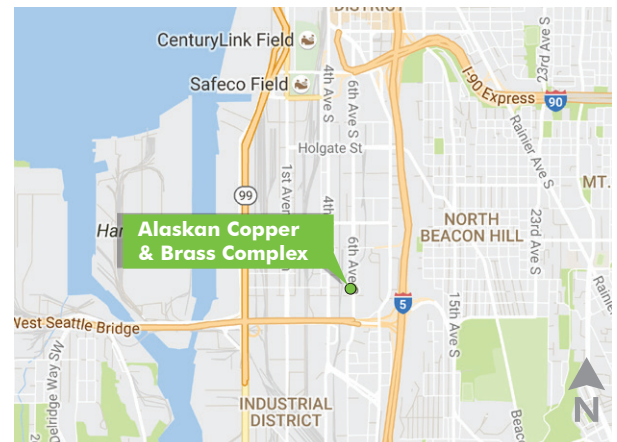

CONTACT US

MILT REIMERS

First Vice President
+1 206 442 2712
milt.reimers@cbre.com

GARY VOLCHOK

First Vice President
+1 206 442 2720
gary.volchok@cbre.com

CBRE, Inc.
1420 Fifth Avenue
Suite 1700
Seattle, WA 98101

www.cbre.com/seattle

CBRE

FOR LEASE
**ALASKAN COPPER &
BRASS COMPLEX**

**3301
6TH AVENUE S**
Seattle, WA 98134



FLOOR PLAN

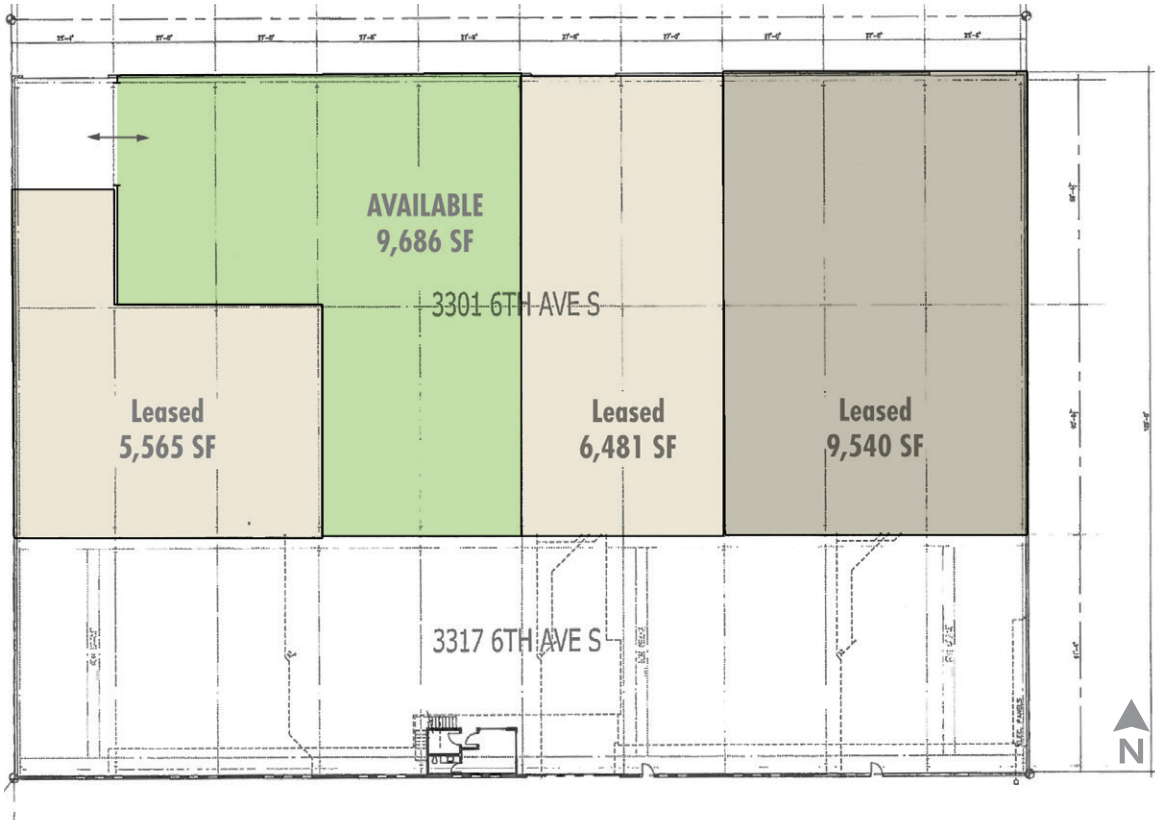

© 2016 CBRE, Inc. This information has been obtained from sources believed reliable. We have not verified it and make no guarantee, warranty or representation about it. Any projections, opinions, assumptions or estimates used are for example only and do not represent the current or future performance of the property. You and your advisors should conduct a careful, independent investigation of the property to determine to your satisfaction the suitability of the property for your needs. scs 8.15.16

Photos herein are the property of their respective owners and use of these images without the express written consent of the owner is prohibited.

www.cbre.com/seattle

CBRE