



# 735 CERAMIC PL

Westerville, OH 43081

LEASE



**LEASE RATE**      **\$12.00 SF/YR**

### OFFERING SUMMARY

Available SF:	460 - 4,256 SF
Lease Rate:	\$12.00 SF/yr (NNN)
Lot Size:	2.3 Acres
Year Built:	1991
Building Size:	34,000 SF
Renovated:	2004
Zoning:	PID-Planned Industrial Dist

### LOCATION OVERVIEW

The property is located in a primarily office area with some retail along W Schrock Road. It is located in close proximity to Mount Carmel St. Ann’s hospital. There is easy access to I-270. The elevation is at street level and the terrain is flat. The traffic is normal and multiple public utilities are available.

### PROPERTY HIGHLIGHTS

- 4,200 SF available 1st floor
- 500 SF available 1st floor
- 2,500 SF can be made available on 2nd floor
- Flexible floor plans

### PROPERTY WEBSITE

[bit.ly/735CeramicPl](http://bit.ly/735CeramicPl)

CBC-ASPIRE.COM

Bill Davis  
614 588 7561  
bdavis@cbc-aspire.com

©2021 Coldwell Banker. All Rights Reserved. Coldwell Banker and the Coldwell Banker Commercial logos are trademarks of Coldwell Banker Real Estate LLC. The Coldwell Banker® System is comprised of company owned offices which are owned by a subsidiary of Realty Brokerage Group LLC and franchised offices which are independently owned and operated. The Coldwell Banker System fully supports the principles of the Equal Opportunity Act.



ASPIRE REALTY SERVICES



# 735 CERAMIC PL

Westerville, OH 43081

LEASE

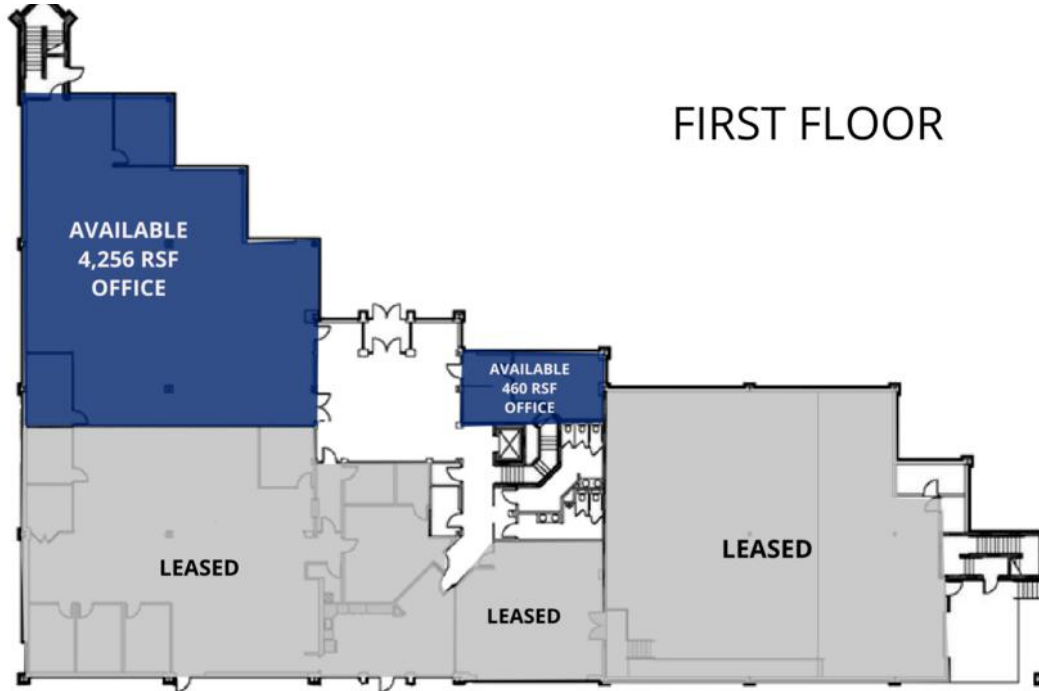

All sizes are based on approximate RSF using a 1.107 Common Area Factor

## AVAILABLE SPACES

SUITE	TENANT	SIZE (SF)	LEASE TYPE	LEASE RATE	DESCRIPTION
First Floor Office 1	Available	4,256 SF	NNN	\$12.00 SF/yr	4,256 RSF Office
First Floor Office 2	Available	460 SF	NNN	\$12.00 SF/yr	460 RSF Office

CBC-ASPIRE.COM

Bill Davis  
 614 588 7561  
 bdavis@cbc-aspire.com

©2021 Coldwell Banker. All Rights Reserved. Coldwell Banker and the Coldwell Banker Commercial logos are trademarks of Coldwell Banker Real Estate LLC. The Coldwell Banker® System is comprised of company owned offices which are owned by a subsidiary of Realty Brokerage Group LLC and franchised offices which are independently owned and operated. The Coldwell Banker System fully supports the principles of the Equal Opportunity Act.



ASPIRE REALTY SERVICES



# 735 CERAMIC PL

Westerville, OH 43081

LEASE

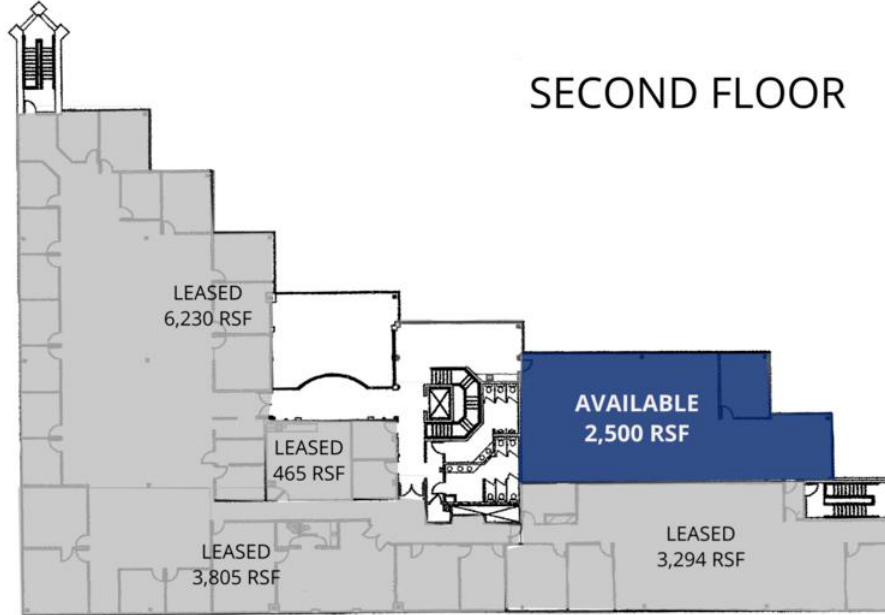

All sizes are based on approximate RSF using a 1.107 Common Area Factor

## AVAILABLE SPACES

SUITE	TENANT	SIZE (SF)	LEASE TYPE	LEASE RATE	DESCRIPTION
Second Floor Office 1	Available	2,500 SF	NNN	\$12.00 SF/yr	2,500 RSF Office

CBC-ASPIRE.COM

Bill Davis  
 614 588 7561  
 bdavis@cbc-aspire.com

©2021 Coldwell Banker. All Rights Reserved. Coldwell Banker and the Coldwell Banker Commercial logos are trademarks of Coldwell Banker Real Estate LLC. The Coldwell Banker® System is comprised of company owned offices which are owned by a subsidiary of Realty Brokerage Group LLC and franchised offices which are independently owned and operated. The Coldwell Banker System fully supports the principles of the Equal Opportunity Act.



ASPIRE REALTY SERVICES



## 735 CERAMIC PL

Westerville, OH 43081

LEASE



CBC-ASPIRE.COM

Bill Davis  
614 588 7561  
bdavis@cbc-aspire.com

©2021 Coldwell Banker. All Rights Reserved. Coldwell Banker and the Coldwell Banker Commercial logos are trademarks of Coldwell Banker Real Estate LLC. The Coldwell Banker® System is comprised of company owned offices which are owned by a subsidiary of Realty Brokerage Group LLC and franchised offices which are independently owned and operated. The Coldwell Banker System fully supports the principles of the Equal Opportunity Act.



ASPIRE REALTY SERVICES



# 735 CERAMIC PL

Westerville, OH 43081

LEASE

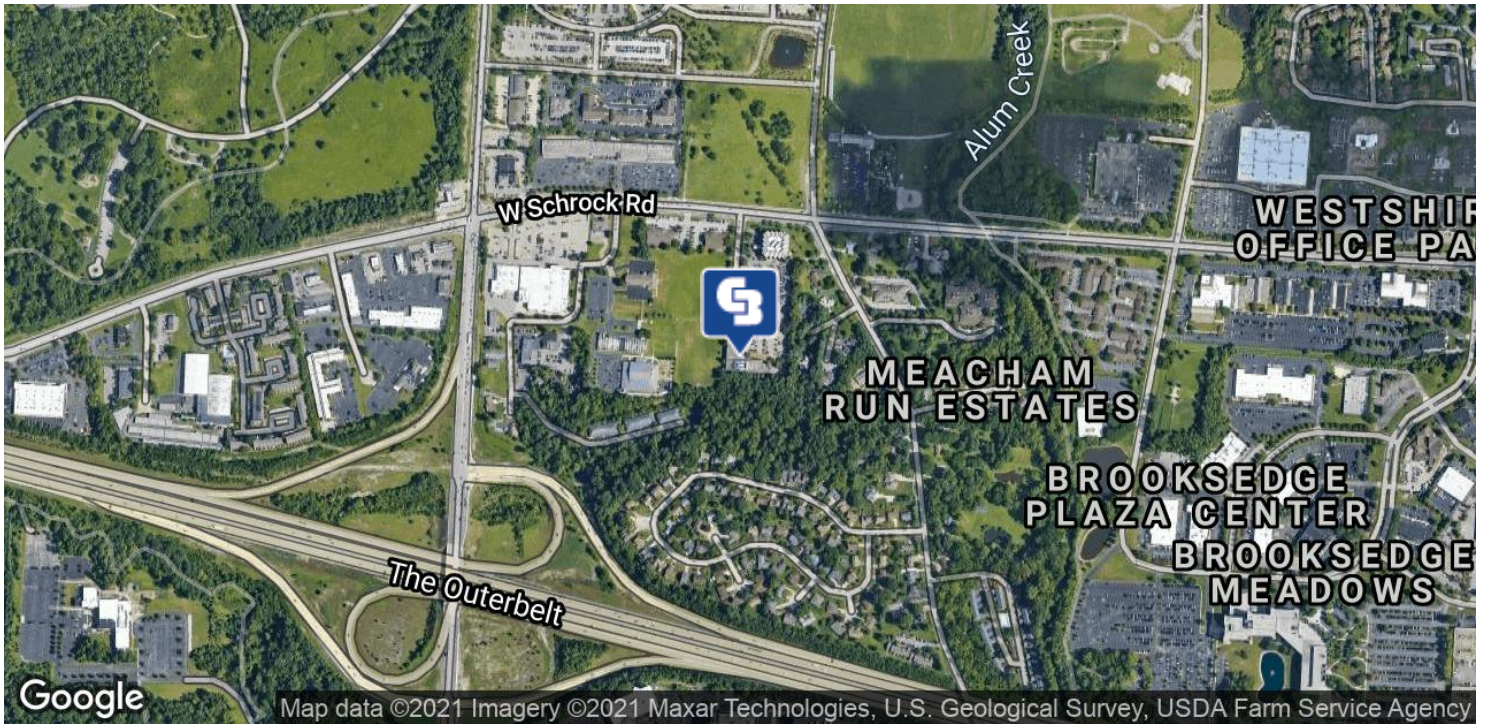

CBC-ASPIRE.COM

Bill Davis  
 614 588 7561  
 bdavis@cbc-aspire.com



ASPIRE REALTY  
 SERVICES

©2021 Coldwell Banker. All Rights Reserved. Coldwell Banker and the Coldwell Banker Commercial logos are trademarks of Coldwell Banker Real Estate LLC. The Coldwell Banker® System is comprised of company owned offices which are owned by a subsidiary of Realty Brokerage Group LLC and franchised offices which are independently owned and operated. The Coldwell Banker System fully supports the principles of the Equal Opportunity Act.



# 735 CERAMIC PL

Westerville, OH 43081

LEASE

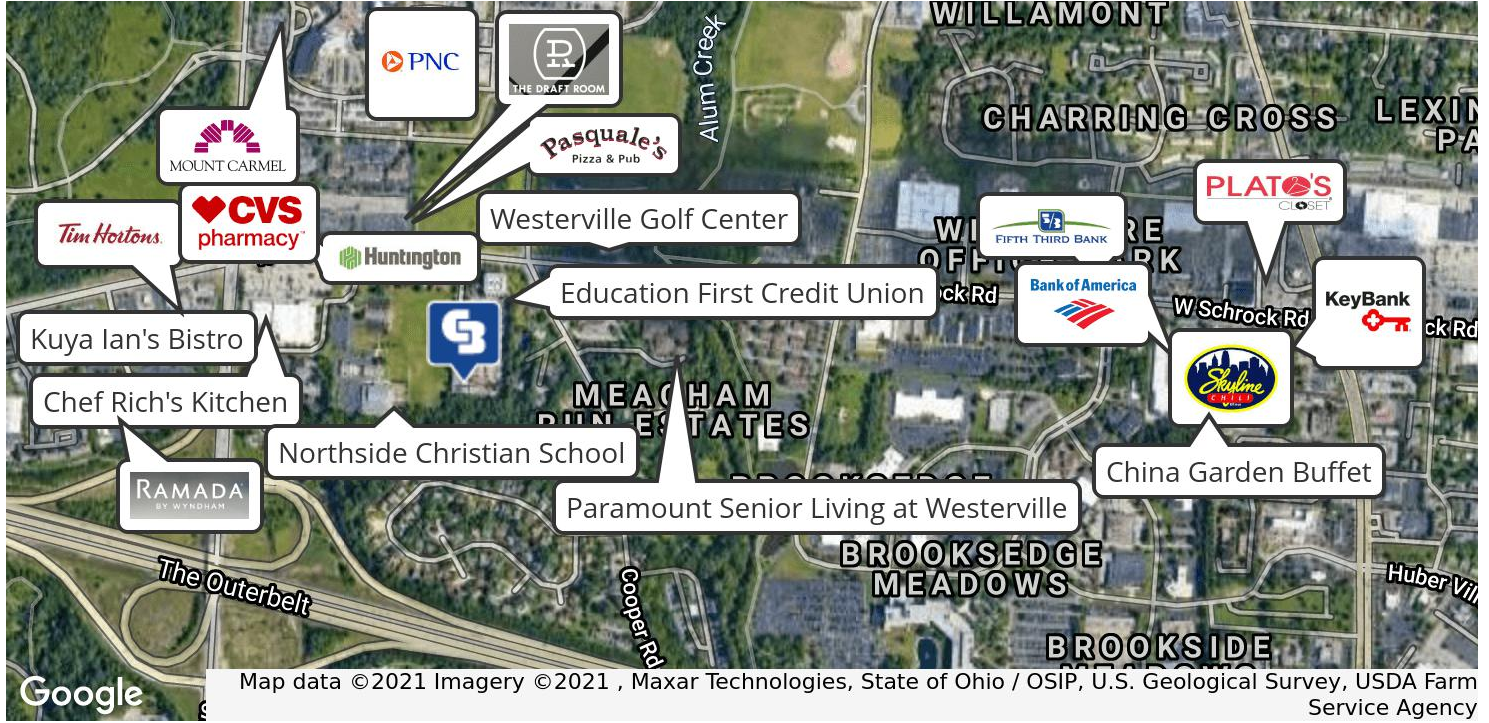

Map data ©2021 Imagery ©2021, Maxar Technologies, State of Ohio / OSIP, U.S. Geological Survey, USDA Farm Service Agency

POPULATION	1 MILE	3 MILES	5 MILES
Total Population	8,889	103,473	238,339
Average age	34.3	35.0	35.1
HOUSEHOLDS & INCOME	1 MILE	3 MILES	5 MILES
Total households	3,837	40,847	94,961
# of persons per HH	2.3	2.5	2.5
Average HH income	\$60,011	\$64,087	\$68,655
Average house value	\$166,321	\$174,722	\$199,169

\* Demographic data derived from 2010 US Census

CROSS STREETS	DIR	YEAR	COUNTS
Cleveland Ave & W Schrock Rd	N	2010	47,880 ADT
W Schrock Rd & Lauffer Rd	E	2012	21,670 ADT

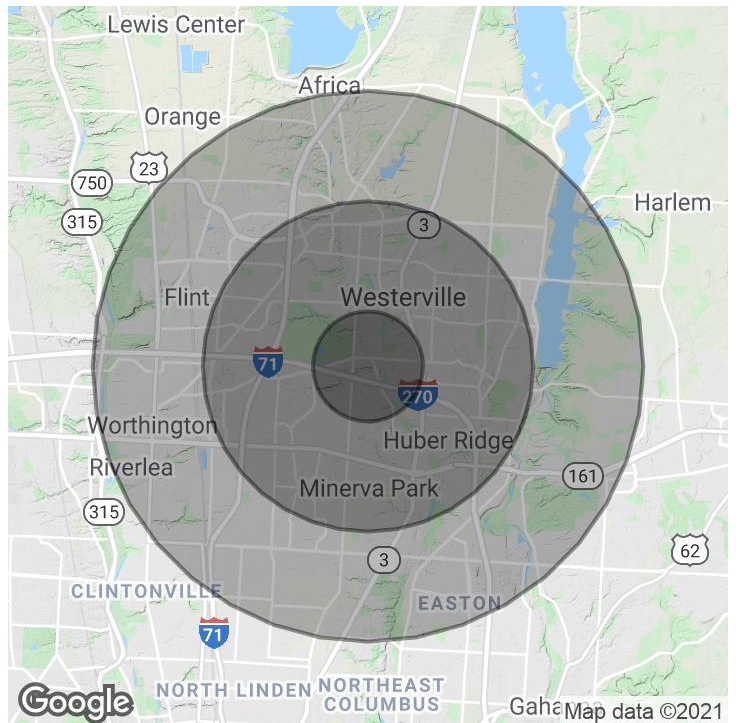

Map data ©2021

CBC-ASPIRE.COM

Bill Davis  
 614 588 7561  
 bdavis@cbc-aspire.com



ASPIRE REALTY SERVICES

©2021 Coldwell Banker. All Rights Reserved. Coldwell Banker and the Coldwell Banker Commercial logos are trademarks of Coldwell Banker Real Estate LLC. The Coldwell Banker® System is comprised of company owned offices which are owned by a subsidiary of Realty Brokerage Group LLC and franchised offices which are independently owned and operated. The Coldwell Banker System fully supports the principles of the Equal Opportunity Act.