

32-35 48TH AVENUE

THE REDSTONE ROCKET BUILDING

Long Island City



FOR LEASE
35,560-106,623 SF

POSSESSION: Immediate

LEASE: Long Term

ASKING RENT: Upon Request

PROPERTY FEATURES:

Spectacular space with 23' ceilings and 25'x35' column spacing. Private loading docks, heavy floor loads and electric capacity.



For Information, please contact:

John Peters
212 841-7510
john.peters@cushwake.com

Mitchell Arkin
212 841 7522
mitchell.arkin@cushwake.com

Cushman & Wakefield
1290 Avenue of the Americas, 7th Fl
New York, NY 10104

A full commission computed and earned in accordance with the rates and conditions of our agency agreement with our principal, when received from our principal, will be paid to the cooperating broker who consummates a lease which is unconditionally executed and delivered by and between lessor and lessee (a copy of the rates and conditions referred to above is available upon request)

32-35 48TH AVENUE

Long Island City



FLOOR PLANS

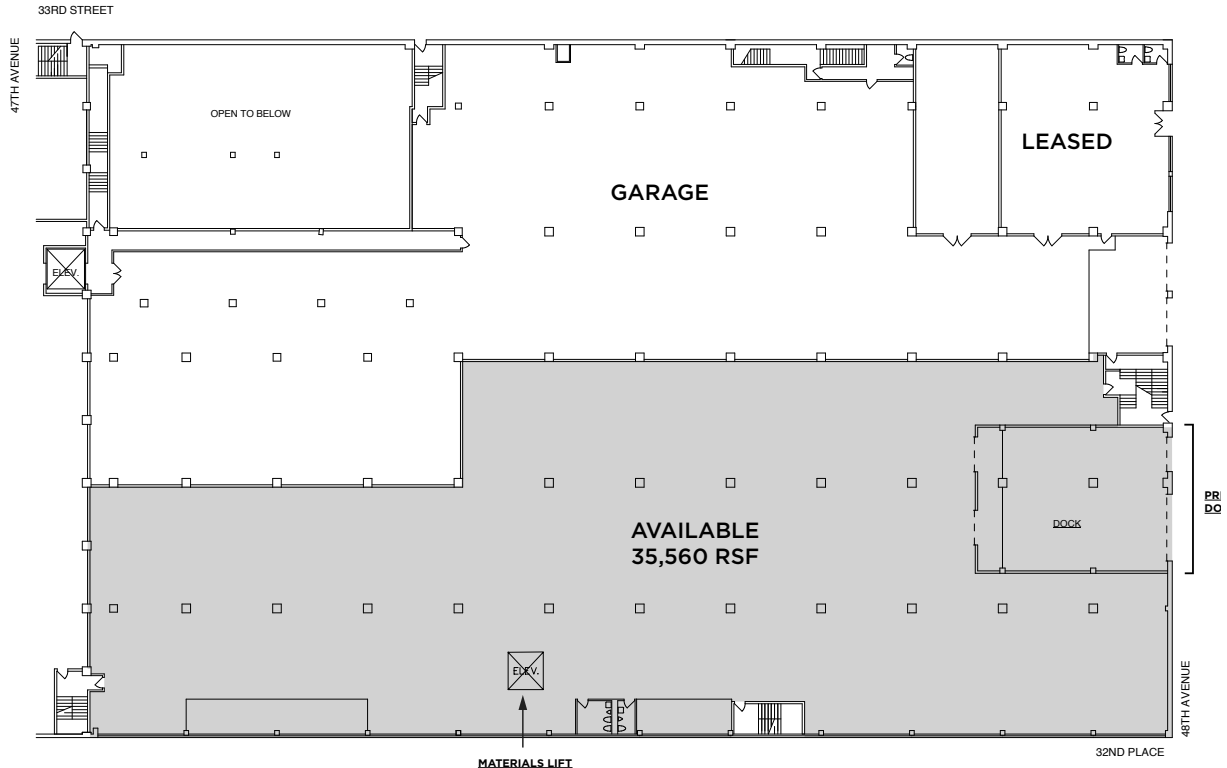

PORTION 2ND FLOOR

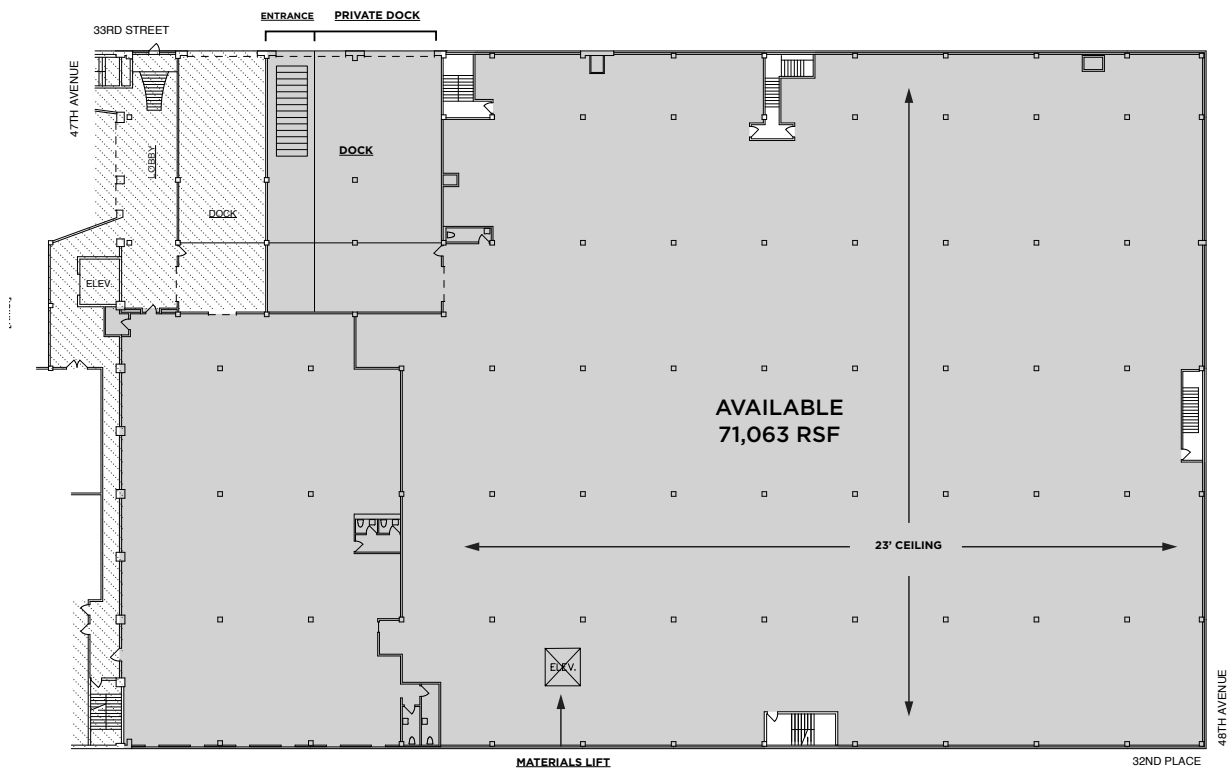

ENTIRE 3RD FLOOR