

SILVERDALE ±38.55 ACRES

EXCLUSIVE LISTING | PINAL COUNTY, ARIZONA

LOCATION S/SEC Gary Road and Judd Road in Pinal County, Arizona

SIZE ±38.55 acres

PARCEL 210-28-007

PRICE Submit

ZONING SH - Suburban Homestead

PINAL COUNTY LAND USE PLAN Ranchette Residential (0-0.3 du/ac)

TAXES \$5,145.18 (2019)

UTILITIES

Power - Salt River Project (SRP)

Water/Sewer - Johnson Utilities (both water & sewer lines run along southern boundary of the property)

Gas - Southwest Gas

COMMENTS

- Previously planned for 18 two acre lots.
- Neighboring San Tan Foothills High School and ±3.2 miles from San Tan Elementary School.
- ±6.9 miles from Central Arizona College's San Tan Campus.
- ±6.8 miles from Banner Health's new Ironwood Medical Center.
- ±3.1 miles from Pavilions at San Tan Heights (Super Walmart Center).
- ±2 miles from San Tan Mountain Regional Park.

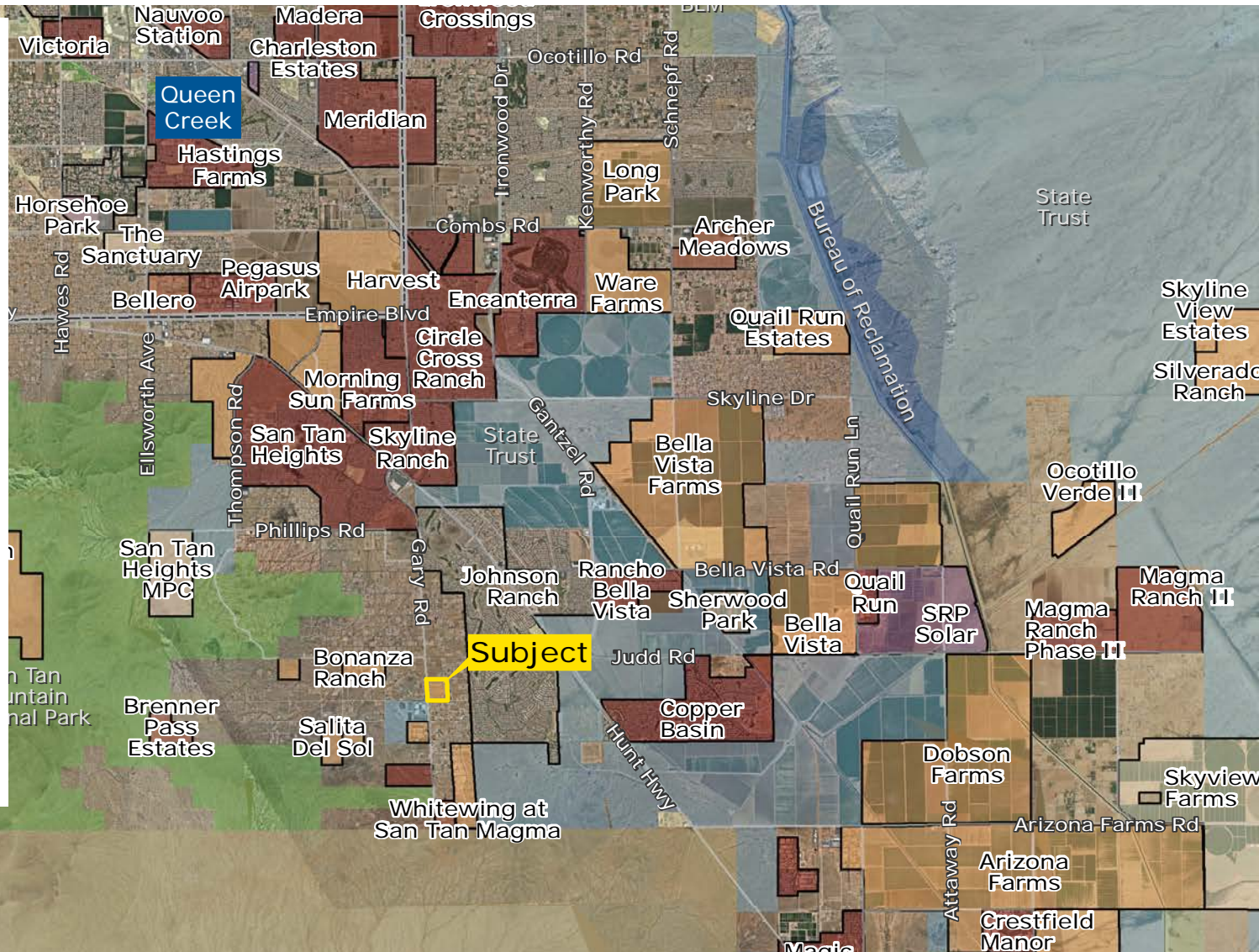

Ryan Semro | rsemro@landadvisors.com Bret Rinehart | brinehart@landadvisors.com Ben Heglie | bheglie@landadvisors.com
4900 North Scottsdale Road, Suite 3000, Scottsdale, Arizona 85251 ph. 480.483.8100 | www.landadvisors.com

The information contained herein is from sources deemed reliable. We have no reason to doubt its accuracy but do not guarantee it. It is the responsibility of the person reviewing this information to independently verify it. This package is subject to change, prior sale or complete withdrawal. AZPL08605 - 8.28.19



REGIONAL MAP

Ryan Semro | Bret Rinehart | Ben Heglie | 480.483.8100 | www.landadvisors.com

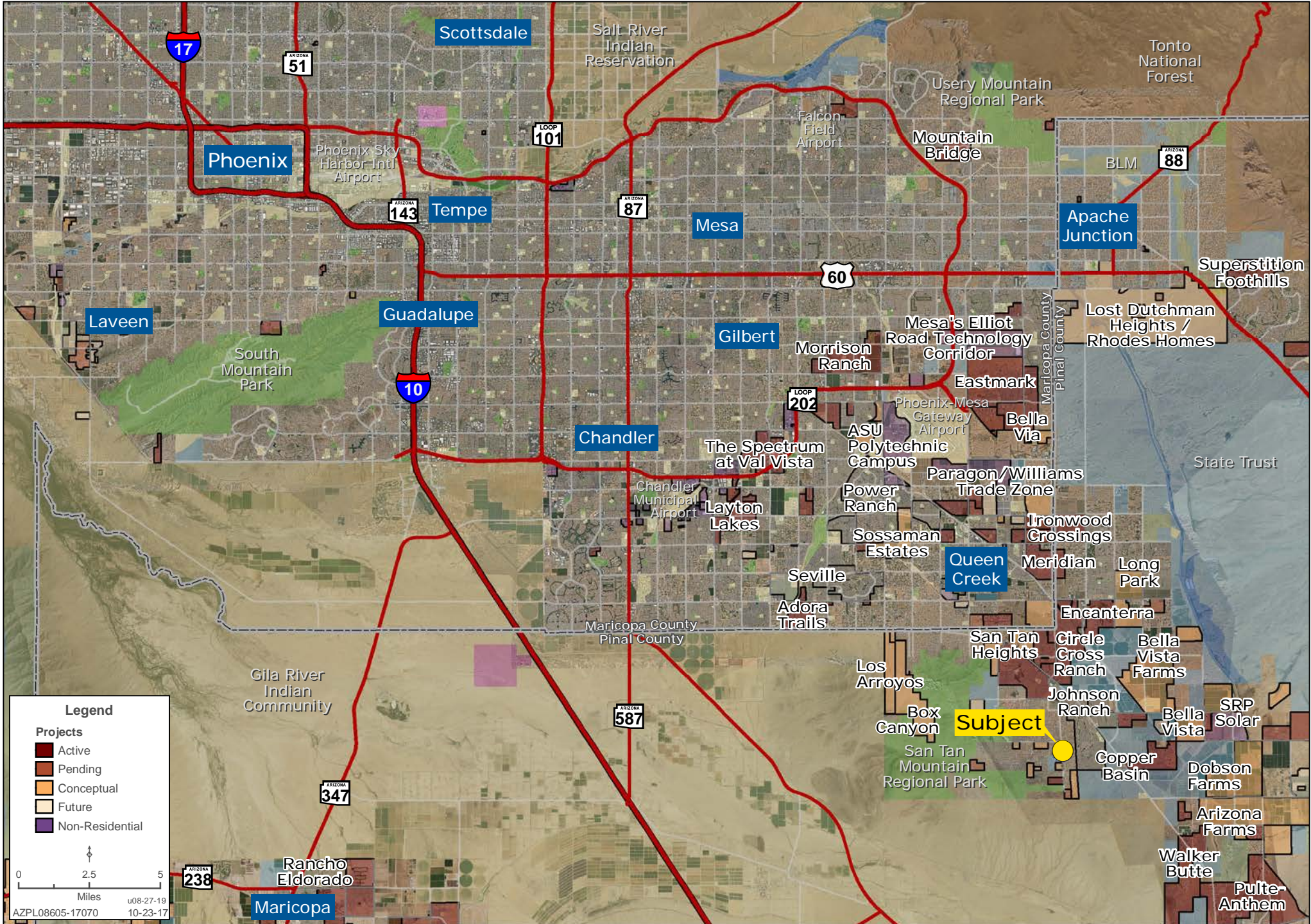

SURROUNDING DEVELOPMENT MAP

Ryan Semro | Bret Rinehart | Ben Heglie | 480.483.8100 | www.landadvisors.com

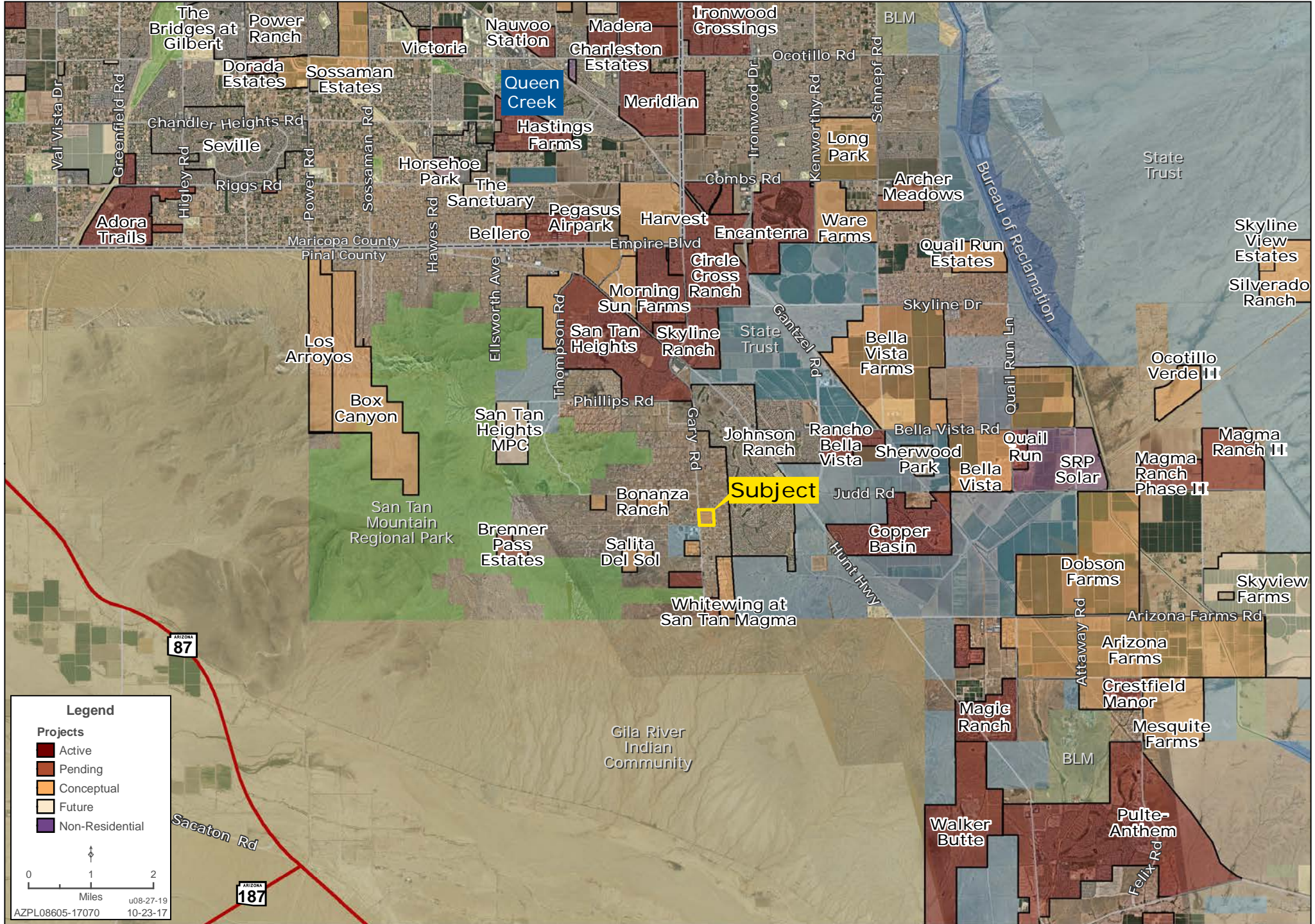

SURROUNDING AREA MAP

Ryan Semro | Bret Rinehart | Ben Heglie | 480.483.8100 | www.landadvisors.com

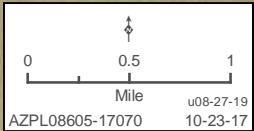
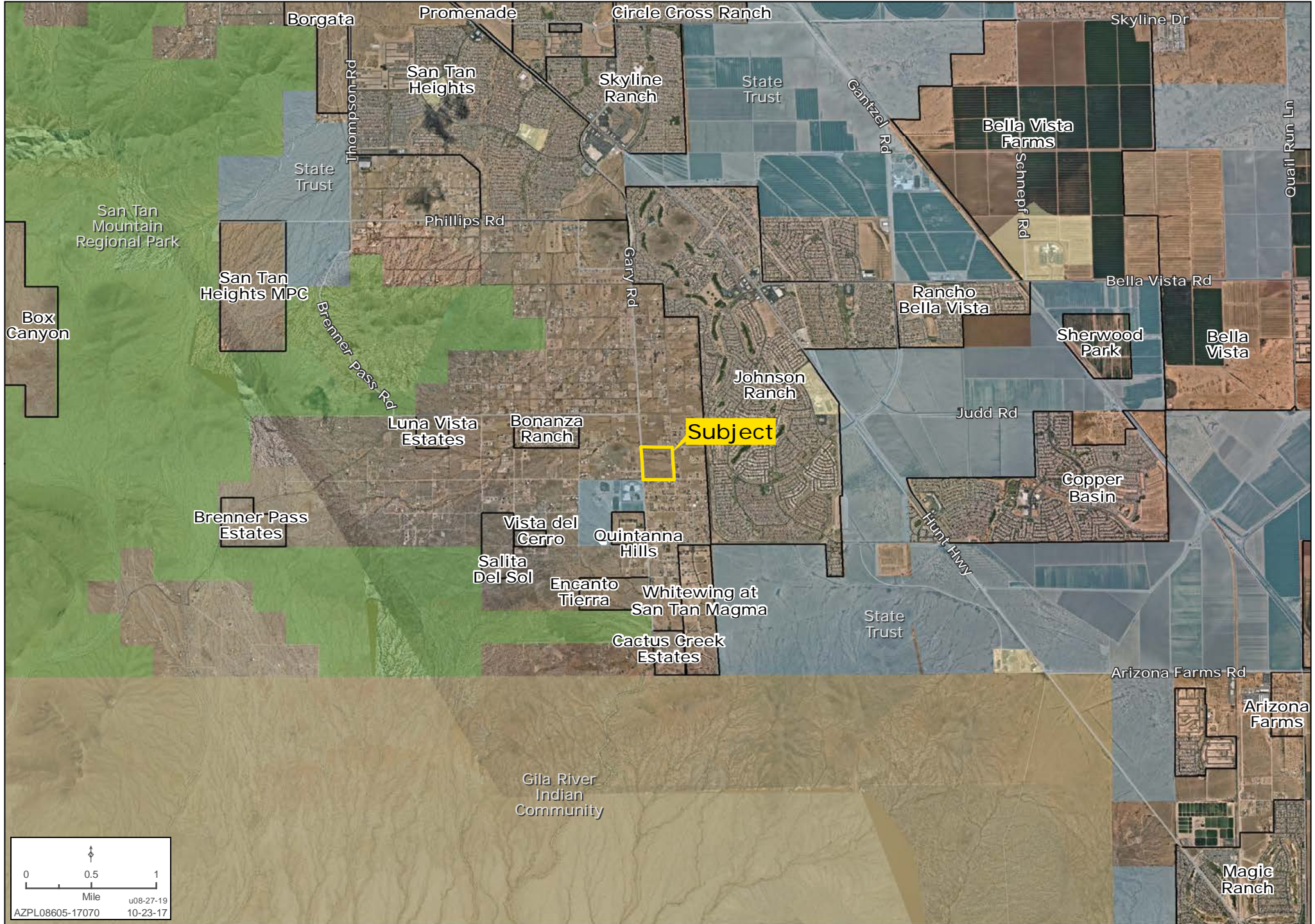

PROPERTY DETAIL MAP

Ryan Semro | Bret Rinehart | Ben Heglie | 480.483.8100 | www.landadvisors.com

