

# For Lease

## 12600 N Featherwood

Houston, TX 77034

*New Ownership & Management/Leasing*



### Property Highlights

#### AVAILABILITIES

- SUITE 101 - 1,720 SF
- SUITE 107 - 698 SF
- SUITE 205 - 1,446 SF
- SUITE 240 - 3,025 SF

#### BUILDING SIZE

- 75,166 SF
- Four (4) stories

#### YEAR BUILT

1987

#### PARKING

- 3.7/1,000 SF; 112 Garage/Reserved
- 2 Story Structured Garage & Surface

**LEASE RATE: \$21.00/SF**

**FULL SERVICE**

#### BUILDING FEATURES

- 100% Sprinklered
- On-site Management and Engineer
- Updated Level 2 Restrooms
- New Entrance Canopy
- New Exterior Landscaping
- Updated Monument Sign
- Restaurants and Banking across Featherwood
- Close proximity to Port of Houston, Hobby Airport, Texas Medical Center and NASA
- Convenient access to I-45 and Sam Houston Parkway

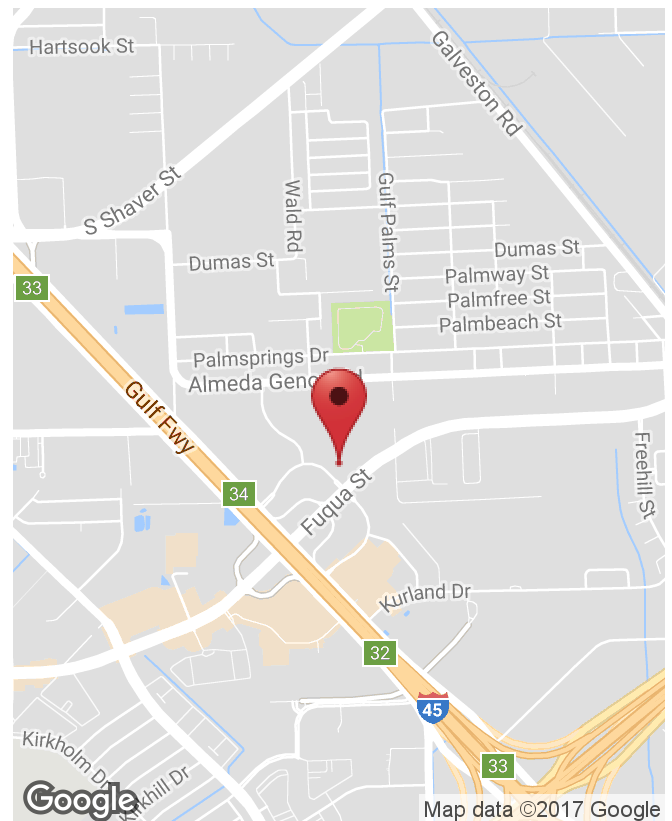

#### Zach Leger

tel 713 275 9605

fax 713 275 9659

zach.leger@naipartners.com

#### Jacob Aldridge

tel 713 275 9654

fax 713 629 0504

jacob.aldridge@naipartners.com

#### NAI Partners

tel 713 629 0500

fax 713 629 0504

www.naipartners.com

**NAI**Partners

HOUSTON | AUSTIN | SAN ANTONIO

The information contained herein has been given to us by the owner of the property or other sources we deem reliable, we have no reason to doubt its accuracy, but we do not guarantee it. All information should be verified prior to purchase or lease. © 2017 NAI Partners. All rights reserved.

# For Lease



## 12600 N Featherwood

Houston, TX 77034

*New Ownership & Management/Leasing*



### Zach Leger

tel 713 275 9605

fax 713 275 9659

[zach.leger@naipartners.com](mailto:zach.leger@naipartners.com)

### Jacob Aldridge

tel 713 275 9654

fax 713 629 0504

[jacob.aldridge@naipartners.com](mailto:jacob.aldridge@naipartners.com)

### NAI Partners

tel 713 629 0500

fax 713 629 0504

[www.naipartners.com](http://www.naipartners.com)

**NAI**Partners

HOUSTON | AUSTIN | SAN ANTONIO

The information contained herein has been given to us by the owner of the property or other sources we deem reliable, we have no reason to doubt its accuracy, but we do not guarantee it. All information should be verified prior to purchase or lease. © 2017 NAI Partners. All rights reserved.

# For Lease

# 12600 N Featherwood

Houston, TX 77034

**New Ownership & Management/Leasing**

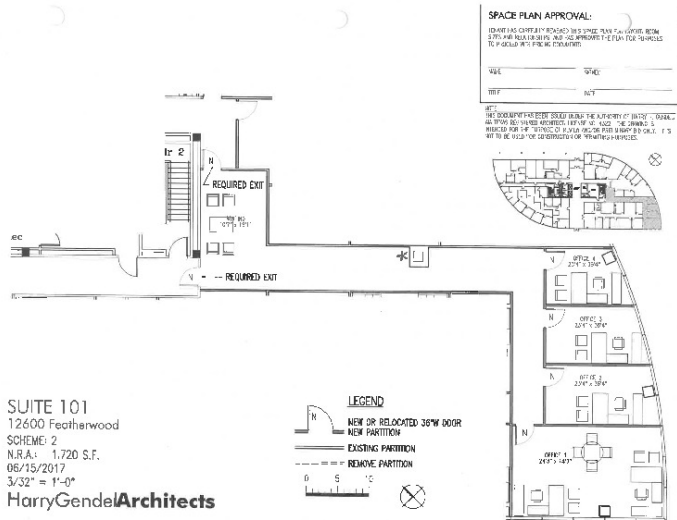

12600 Featherwood

Suite 107  
623 S.F. NRA

**NAI Houston**  
Commercial Real Estate, Consulting, & Services  
HarryGendelArchitects

**Suite 240 Remodel**  
12600 Featherwood, Suite 240  
SCHEME: SPACE PLAN 2  
N.R.A.: 3,025 S.F.  
08/10/2016  
3/32" = 1'-0"

HarryGendelArchitects

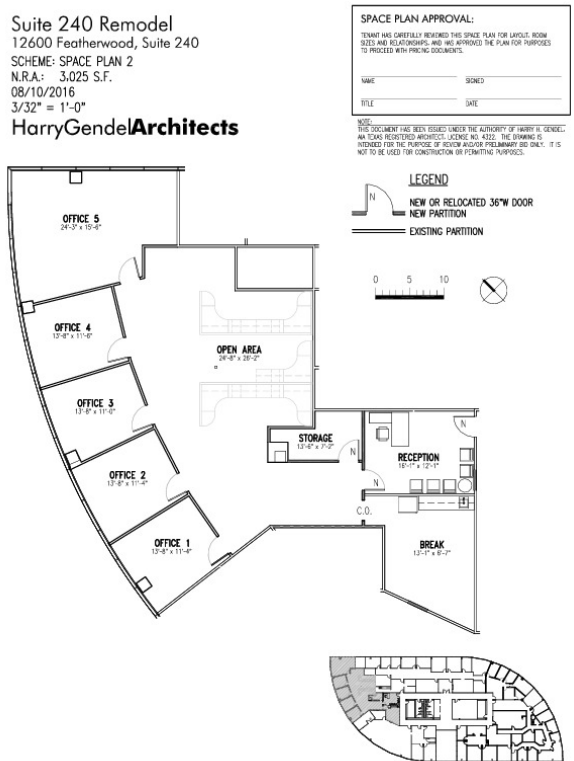

12600 Featherwood

Suite 205  
1,423 S.F. NRA

**NAI Houston**  
Commercial Real Estate, Consulting, & Services  
HarryGendelArchitects

**Zach Leger**

tel 713 275 9605

fax 713 275 9659

zach.leger@naipartners.com

**Jacob Aldridge**

tel 713 275 9654

fax 713 629 0504

jacob.aldridge@naipartners.com

**NAI Partners**

tel 713 629 0500

fax 713 629 0504

www.naipartners.com

**NAIPartners**

HOUSTON | AUSTIN | SAN ANTONIO

The information contained herein has been given to us by the owner of the property or other sources we deem reliable, we have no reason to doubt its accuracy, but we do not guarantee it. All information should be verified prior to purchase or lease. © 2017 NAI Partners. All rights reserved.

# For Lease

## 12600 N Featherwood

Houston, TX 77034

*New Ownership & Management/Leasing*



**Zach Leger**

tel 713 275 9605

fax 713 275 9659

[zach.leger@naipartners.com](mailto:zach.leger@naipartners.com)

**Jacob Aldridge**

tel 713 275 9654

fax 713 629 0504

[jacob.aldridge@naipartners.com](mailto:jacob.aldridge@naipartners.com)

**NAI Partners**

tel 713 629 0500

fax 713 629 0504

[www.naipartners.com](http://www.naipartners.com)

**NAI Partners**

HOUSTON | AUSTIN | SAN ANTONIO

The information contained herein has been given to us by the owner of the property or other sources we deem reliable, we have no reason to doubt its accuracy, but we do not guarantee it. All information should be verified prior to purchase or lease. © 2017 NAI Partners. All rights reserved.