



6 Route 70 West

Marlton, New Jersey

Property Description

- 0.80± acre site for lease
- 216± ft frontage on Route 70
- Curb cut on Route 70
- Traffic Count - 34,012 VPD
- Public water & sewer
- Block 4.02; Lots 6-8
- Taxes (2016): \$20,917
- Zoned C-3



Location Information

- Located on heavily traveled Route 70 approximately .5 miles from Route 73 intersection
- Easy access to I-295 and the New Jersey Turnpike
- Surrounded by area retail, restaurants and offices

Demographics

	1 mi	3 mi	5 mi
Population	10,536	70,131	162,880
Households	4,146	26,609	63,556
Median Household Income	\$73,322	\$98,130	\$93,580

For more information:

Julie Kronfeld, SIOR

+1 856 802 6516

julie.kronfeld@naimertz.com

Rebecca Ting, SIOR

+1 856 234 9600

rebecca.ting@naimertz.com

21 Roland Avenue
Mount Laurel, New Jersey
+1 856 234 9600

naimertz.com



For more information:

Julie Kronfeld, SIOR

+1 856 802 6516
 julie.kronfeld@naimertz.com

Rebecca Ting, SIOR

+1 856 234 9600
 rebecca.ting@naimertz.com

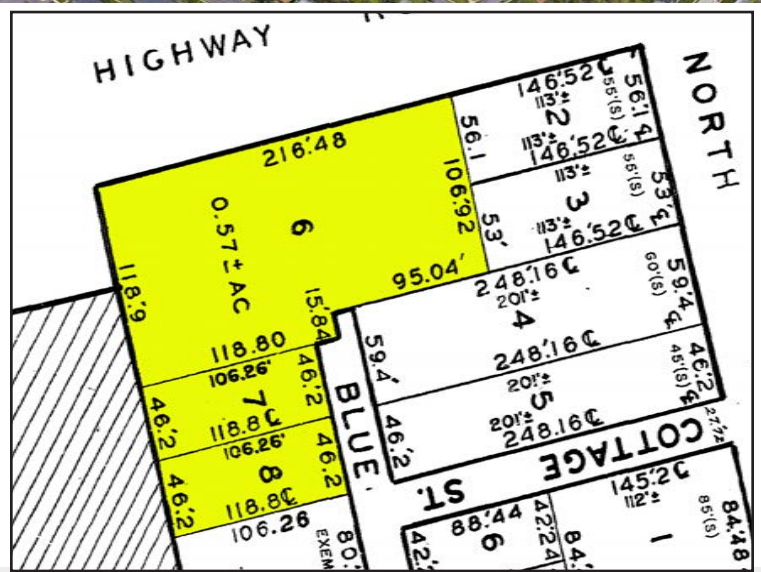

NO WARRANTY OR REPRESENTATION, EXPRESS OR IMPLIED, IS MADE AS TO THE ACCURACY OF THE INFORMATION CONTAINED HEREIN, AND THE SAME IS SUBMITTED SUBJECT TO ERRORS, OMISSIONS, CHANGE OF PRICE, RENTAL OR OTHER CONDITIONS, PRIOR SALE, LEASE OR FINANCING, OR WITHDRAWAL WITHOUT NOTICE, AND OF ANY SPECIAL LISTING CONDITIONS IMPOSED BY OUR PRINCIPALS NO WARRANTIES OR REPRESENTATIONS ARE MADE AS TO THE CONDITION OF THE PROPERTY OR ANY HAZARDS CONTAINED THEREIN ARE ANY TO BE IMPLIED.

21 Roland Avenue
 Mount Laurel, New Jersey
 +1 856 234 9600

naimertz.com