

FOR SALE

±4,805 SF INDUSTRIAL BUILDING

26520 ADAMS AVENUE | MURRIETA, CA

LEE & ASSOCIATES
COMMERCIAL REAL ESTATE SERVICES



PROPERTY HIGHLIGHTS:

- Fenced yard
- Corner location
- 2 offices, reception, conference room, 2 restrooms
- 12' x 12' ground level roll up door
- Low Association Dues: \$214/mo.
- 400 amp, 120/208v phase electric

ASKING PRICE:
\$939,975

Charley Black
951.445.4507
cblack@leetemecula.com
Lic.#01000597

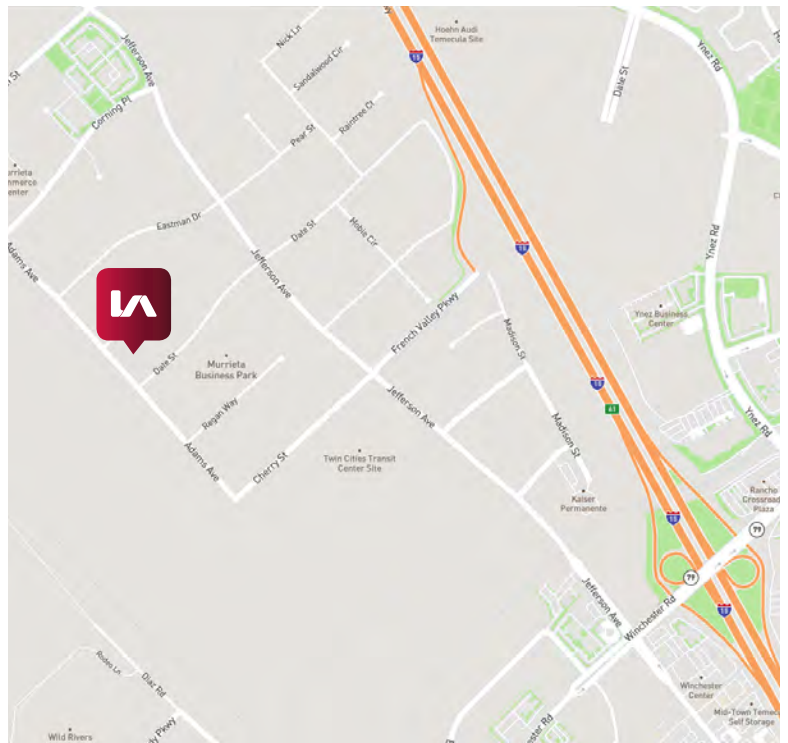

No warranty or representation has been made to the accuracy of the foregoing information. Terms of sale or lease and availability are subject to change or withdrawal without notice. Lee & Associates Commercial Real Estate Services, Inc. - Riverside, 25240 Hancock Avenue, Suite 100 - Murrieta, CA 92562 Corporate ID# 01048055

FOR SALE

±4,805 SF INDUSTRIAL BUILDING

26520 ADAMS AVENUE | MURRIETA, CA

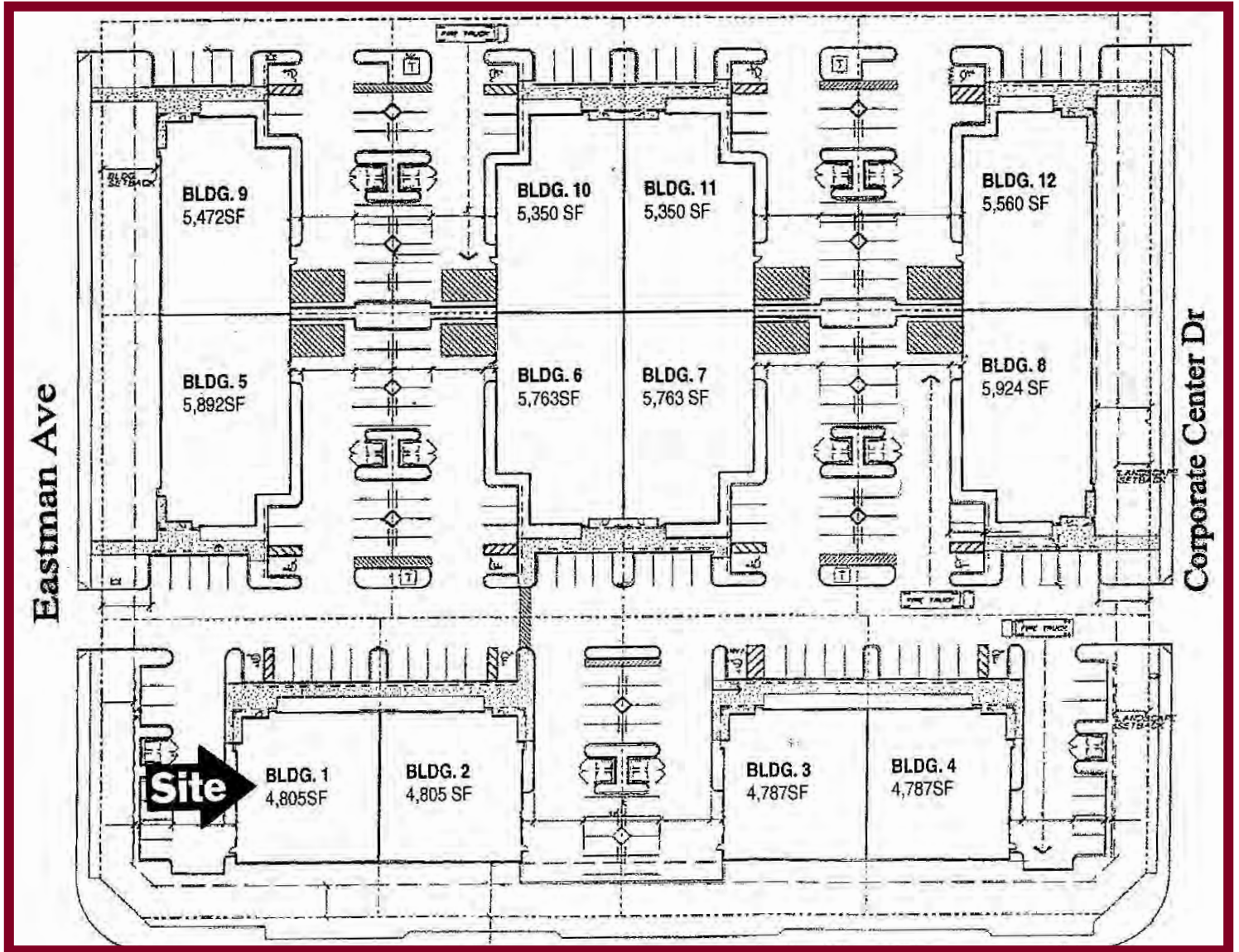

Charley Black
951.445.4507
cblack@leetemecula.com
Lic.#01000597

No warranty or representation has been made to the accuracy of the foregoing information. Terms of sale or lease and availability are subject to change or withdrawal without notice. Lee & Associates Commercial Real Estate Services, Inc. - Riverside, 25240 Hancock Avenue, Suite 100 - Murrieta, CA 92562 Corporate ID# 01048055