



COURTHOUSE PLACE

11524 BUSY STREET | RICHMOND, VIRGINIA 23236

FEATURES

- **1,323 SF Retail Space Available For Lease.**
- Center is shadow-anchored by *Kohl's* and *Target*.
- Join our newest Tenants *Inter China* and *Simply Nails*.
- Over 37,000 employees within three miles.
- Located near the intersection of Courthouse Rd. and Midlothian Tpke.
- Less than 1,000' from *Chesterfield Towne Center*.

DEMOGRAPHICS*

	1 mile	3 miles	5 miles
2017 Population	2,652	57,919	125,011
Avg HH Income	\$104,088	\$102,913	\$103,708
Daytime Employment	19,808	39,493	83,769
Traffic Count	66,425 VPD on Midlothian Tnpk. 38,000 VPD on Courthouse Road		

* Detailed demographics upon request



Ellen Long: 804.864.9788 EXT. 101
 ellenlong@taylorlongproperties.com

Vania Farnsworth: 804.864.9788 EXT. 108
 vaniafarnsworth@taylorlongproperties.com

CoStar
POWER BROKER
 2016 Top Firm Award



Taylor Long
PROPERTIES
 Commercial Real Estate



SITE PLAN

RETAIL			
Unit	Street #	SF	Tenant
A	11556	1,854 SF	Dunkin' Donuts
B	11552	1,416 SF	Virginia BBQ
C	11548	1,323 SF	AVAILABLE
D	11544	1,347 SF	Sport Clips
E	11540	1,323 SF	Cartridge World
F-H	11532	4,200 SF	Master Cho's
I	11524	1,322 SF	Simply Nails
J	11520	1,348 SF	C&C Hair Co.
K	11516	1,323 SF	Small Cakes
L	11512	2,240 SF	Inter China
M-N	11500	3,900 SF	Plaza Azteca

BUILDING INFORMATION	
Total Building Area	21,660 SF
Maximum Building Height	27' - 6"
Total Parking Provided	110 Spaces

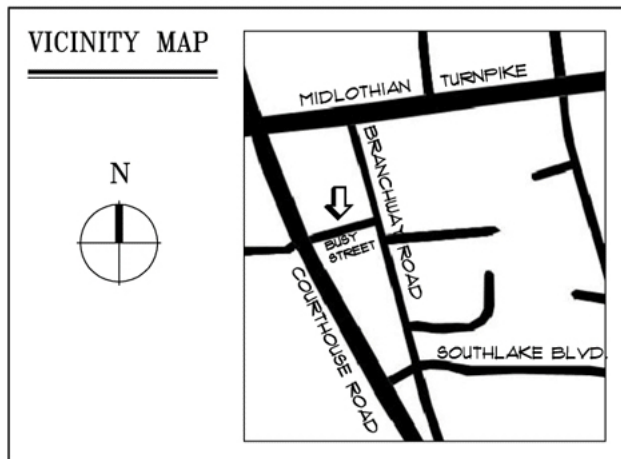
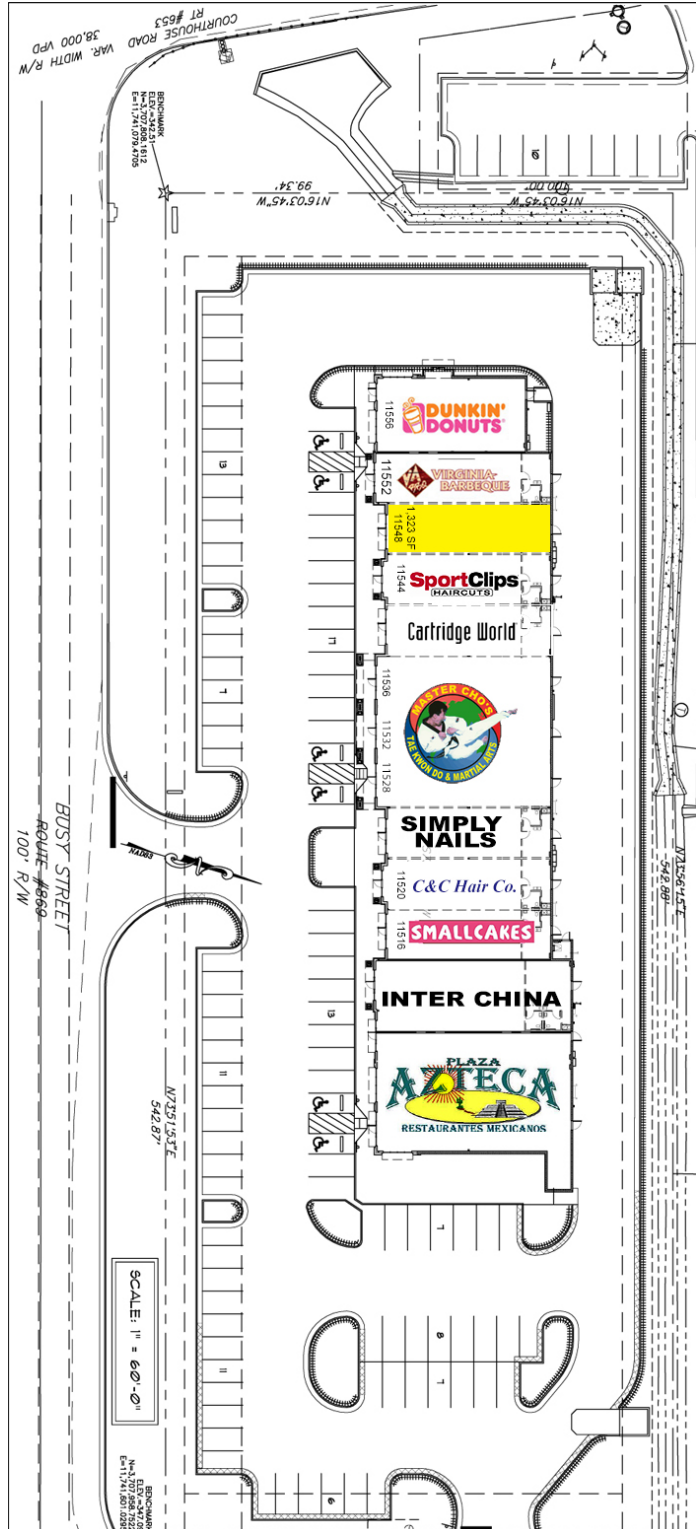

Information contained herein was provided by sources believed to be reliable. Taylor Long Properties makes no representation, expressed or implied, as to its accuracy and said information is subject to errors, omissions or changes.

AERIAL



AVAILABLE
 Taylor Long
 PROPERTIES
 Commercial Real Estate
804.864.9788
www.taylorlongproperties.com