



Building Features

- ±205,878 SF
- 60' Speed Bays
- 52' x 54' Bays
- ESFR Sprinklers
- Foreign Trade Zone #84
- 32' Clear Height
- 185' Truck Courts
- Fenced Truck Court
- Onsite Truck and Trailer Storage
- Abundant Parking (see site plan)
- 48 - 9' x 10' Overhead Doors
- 2 - 12' x 14' Ramp Doors
- **Lease Rate: Contact Broker**

Location



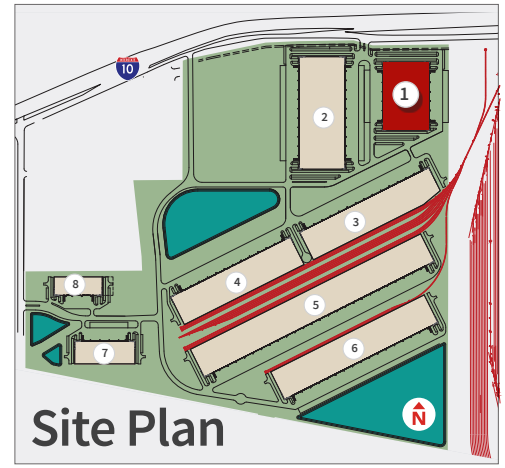

Building 1

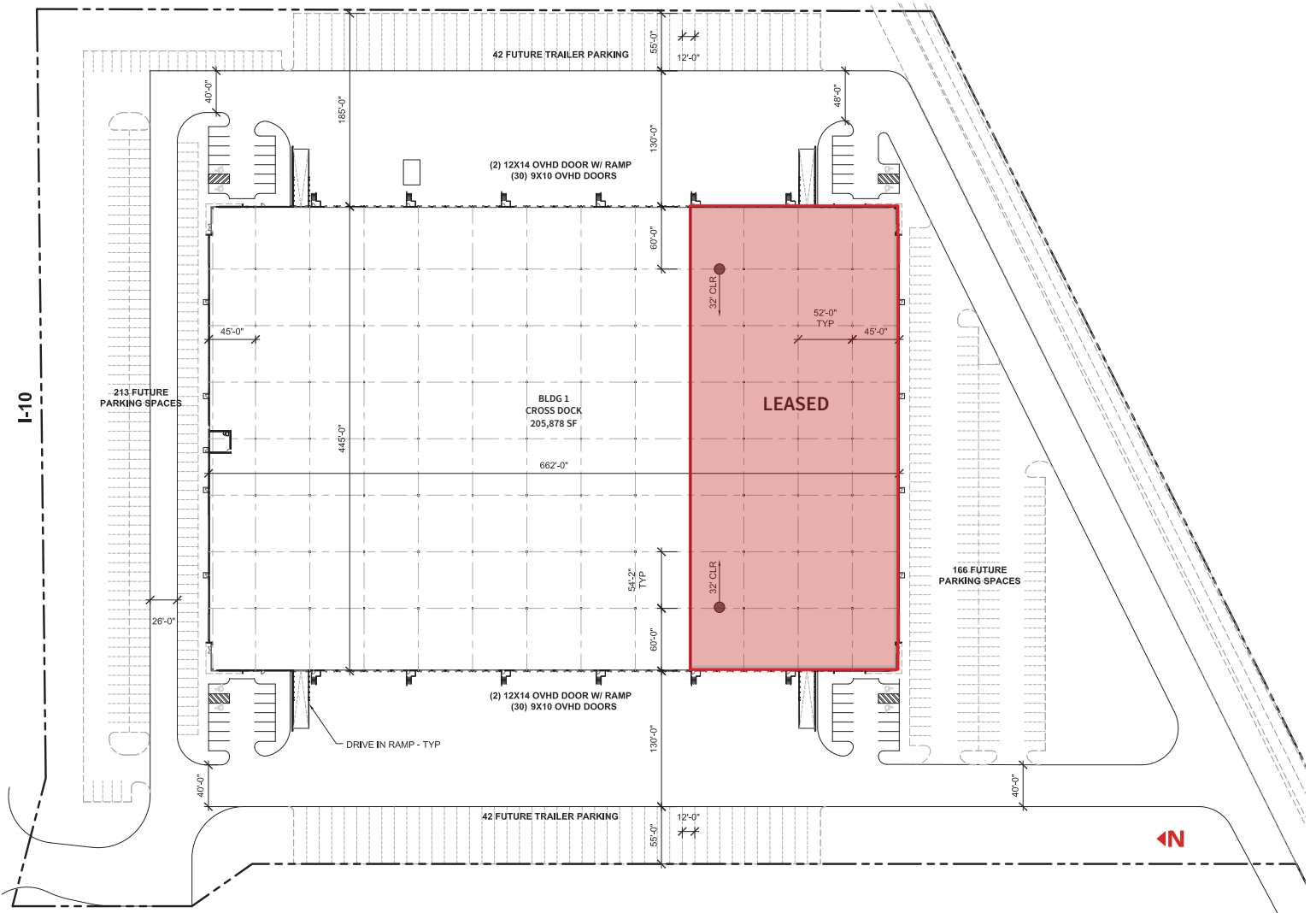

Port10LogisticsCenter.com



John M. Talhelm
Senior Vice President
+1 713 888 4058
john.talhelm@am.jll.com

Kevin A. Erck, SIOR
Vice President
+1 713 888 4067
kevin.erck@am.jll.com



PORT 10 LOGISTICS CENTER

BUILDING 1

2700 EAST FREEWAY
BAYTOWN, TX 77521
SHELL COMPLETE

