

# Hualapai Pavillion Center

3700 S. Hualapai Way Las Vegas, NV 89147  
SEC S. Hualapai Way & W. Twain Ave



## FOR LEASE 1,450 - 2,412 SF

- Serving high household incomes of the Summerlin community
- Excellent visibility with frontage along Hualapai Way
- Near I-215 freeway
- Pylon signage available
- Year Built: 2007
- APN: 163-18-314-005
- Zoning: General Commercial (C-2)

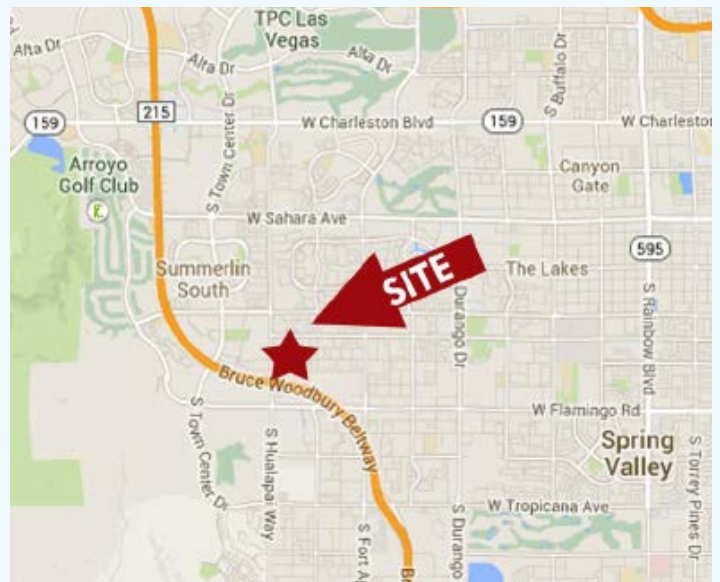

	1 mi	3 mi	5 mi
POPULATION	17,311	139,104	297,686
HOUSEHOLDS	7,401	59,507	124,033
AVG HOUSEHOLD INCOME	\$109,274	\$101,242	\$101,698

Source: SitesUSA 2020

JOIN THESE EXISTING  
**TENANTS**



**RE/MAX**  
**ROMA COFFEE**



## LEASING CONTACT DERON CONWAY

702.550.4918 | dc@roicre.com  
Lic. # BS.0144094.PC

9121 W Russell Rd Suite 111  
Las Vegas, NV 89148  
(P) 702.363.3100 (F) 702.363.0450  
roicre.com

# Hualapai Pavillion Center

3700 S. Hualapai Way Las Vegas, NV 89147  
 SEC S. Hualapai Way & W. Twain Ave

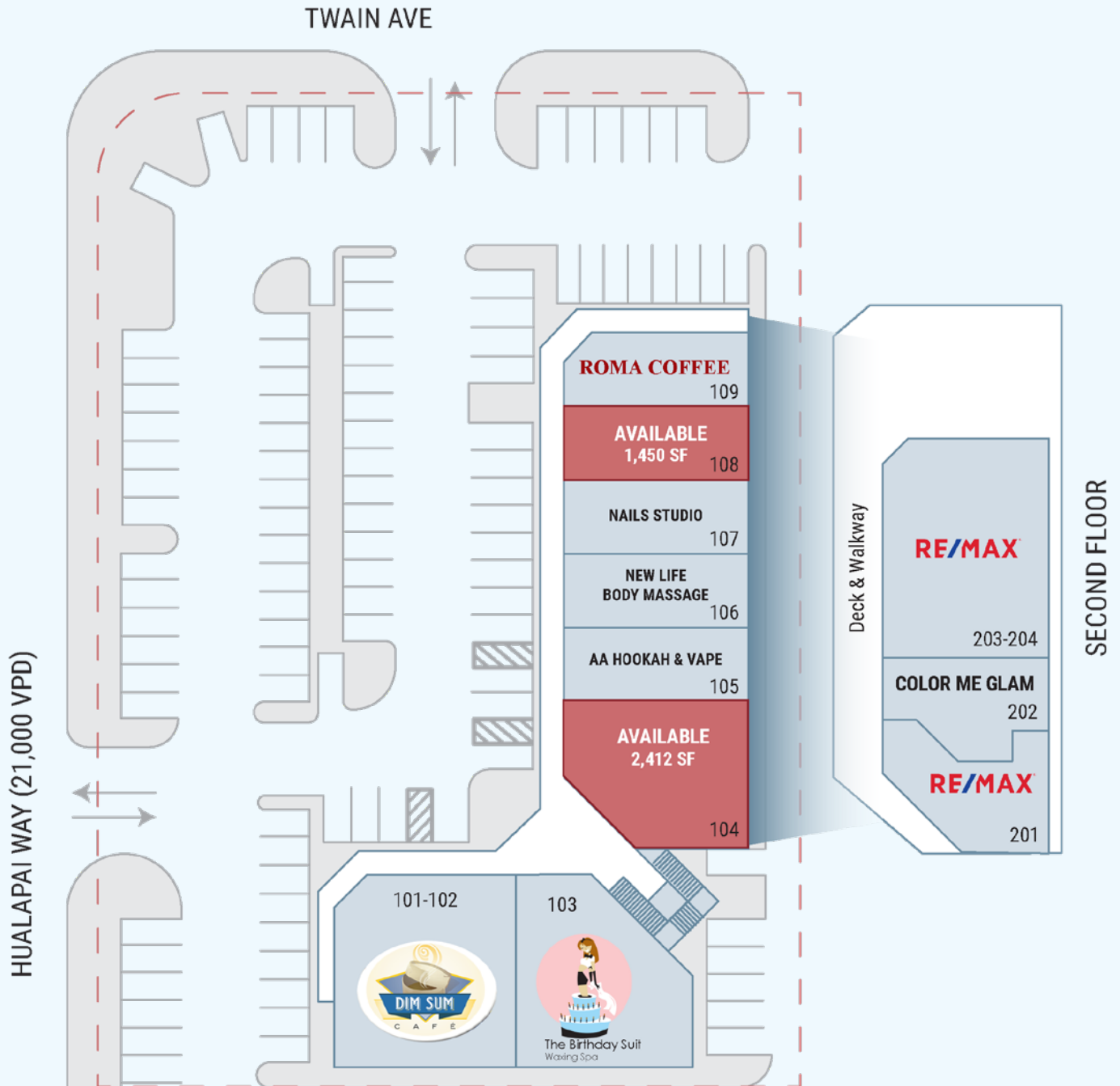

## LEASING CONTACT

**DERON CONWAY**

702.550.4918 | dc@roicre.com

Lic. # BS.0144094.PC

9121 W Russell Rd Suite 111

Las Vegas, NV 89148

(P) 702.363.3100 (F) 702.363.0450

roicre.com



# Hualapai Pavillion Center

3700 S. Hualapai Way Las Vegas, NV 89147  
SEC S. Hualapai Way & W. Twain Ave

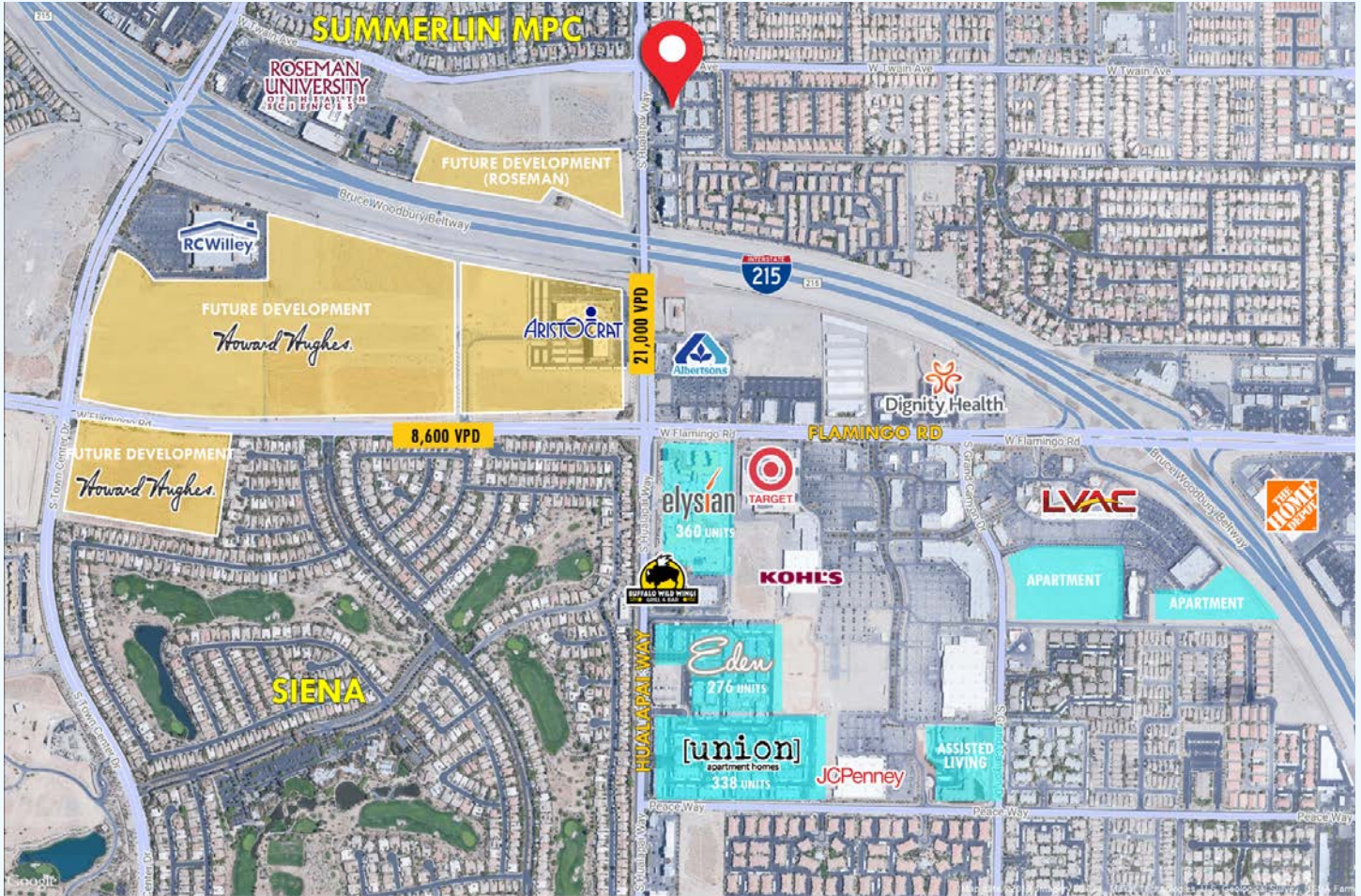

## TRAFFIC COUNTS

Hualapai Way - 21,000 VPD

Flamingo Rd - 8,600 VPD

Source: Trina, NV DOT 2019

## LEASING CONTACT

**DERON CONWAY**

702.550.4918 | dc@roicre.com

Lic. # BS.0144094.PC

9121 W Russell Rd Suite 111

Las Vegas, NV 89148

(P) 702.363.3100 (F) 702.363.0450

roicre.com