

# THE ARROYO MARKET SQUARE

**FOR LEASE | RETAIL**

6920 - 7350 Arroyo Crossing Pkwy  
Las Vegas, NV 89113





# NOW LEASING



The Arroyo Market Square is a 940,000 square foot retail power center, which is located adjacent to the Arroyo Corporate Center, a partially developed 1.5 million square foot Class "A" office development. The Arroyo Market Square is now home to many national big-box tenants, as well as in-line shop tenants, and features a variety of casual dining selections. This power center provides excellent visibility to people on their Beltway commute. With the excellent freeway accessibility offered by this center, retailers will draw customers from the southwest, and from the Summerlin area as well.

### Zoning

General Commercial (C-2)

### Population (1/3/5 mi)

4,868 / 134,834 / 354,940

### Avg HH Income (1/3/5 mi)

\$98,183 / \$82,443 / \$82,858

### TRAFFIC COUNTS:

Rainbow Blvd., 0.3 N of Warm Springs: **53,000 cpd**

I-215: **199,000 cpd**



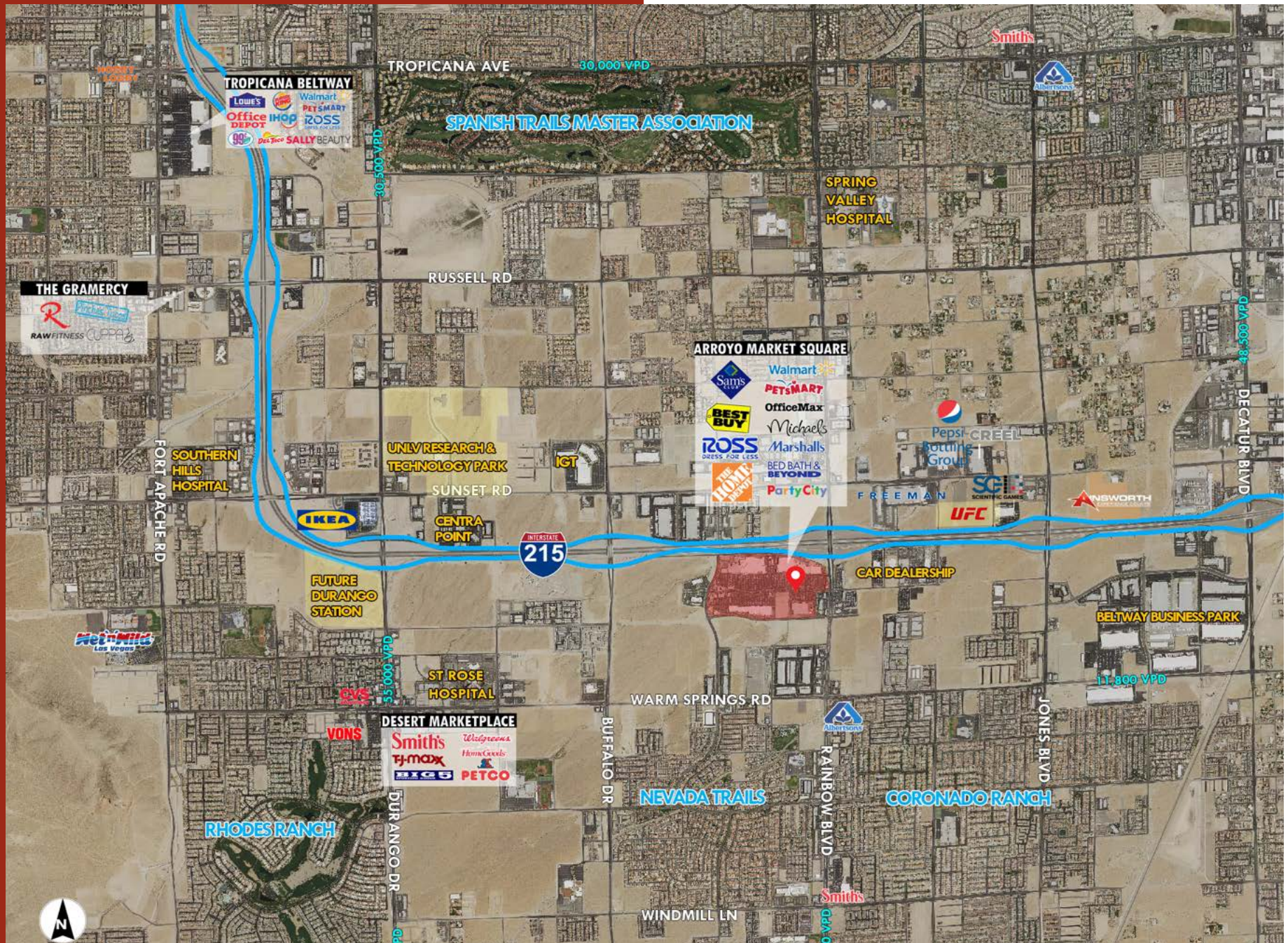



# SITE PLAN



## AVAILABLE

SUITE	SQUARE FEET	ASKING RATE
7020	35,328 SF	\$18.00 sf/yr
7265	7,000 SF	\$20.00 sf/yr
7285-120	7,200 SF	\$20.00 sf/yr
7290-100	2,210 SF	\$36.00 sf/yr
7285-125	6,000 SF	\$20.00 sf/yr
7345-105	1,500 SF	\$36.00 sf/yr
PAD 12	7,200 SF	\$130,000/yr

CAMs, Taxes & Insurance Est: \$0.55 sf/mo

### KIT GRASKI DIRECTOR

Lic #BS.0015934.LLC  
702.363.3100 ext.114  
kgraski@roicre.com

### MAUREEN WATERS SENIOR ASSOCIATE

Lic #S.0169395  
702.363.3100 ext.116  
mwaters@roicre.com

### GEORGE OKINAKA EXECUTIVE VICE PRESIDENT

Lic #S.0045747  
702.363.3100 ext.115  
gokinaka@roicre.com

### JONATHAN SERRANO ASSOCIATE

Lic #S.0183243  
702.363.3100 ext.117  
jonathan@roicre.com



The information contained herein has been obtained from sources we deem reliable. While we have no reason to doubt its accuracy, we do not guarantee it. R.O.I Commercial Real Estate, Inc. All Rights Reserved.

ROI COMMERCIAL REAL ESTATE, INC.  
9121 W Russell Rd., Suite 111, Las Vegas, NV 89148 | 702.363.3100 | FAX: 702.363.0450