

Wentzville Estate

712 W. Pearce Blvd.
Wentzville, Missouri

FOR LEASE:

Lloyd Jones
lloyd@rljonesproperties.com
314.574.9412



Available:

- ▶ 6,515 +/- SF subdividable space available for lease

Specifications

Zoning: C-3 Commercial
Traffic Count: 17,283 VPD

Features:

- ▶ Excellent Visibility
- ▶ Close access to Highway 40 & Highway 70
- ▶ Growing Community
- ▶ Up to 16,000 SF Available for lease, will subdivide

| Demographics | 1 mile | 3 mile | 5 mile |
|-------------------------|----------|----------|----------|
| Total Population | 3,141 | 31,458 | 46,973 |
| Households | 1,219 | 10,699 | 16,551 |
| Median Household Income | \$58,873 | \$71,984 | \$72,139 |



RL Jones Properties

17195 New College Ave.
Wildwood, MO 63040
Phone| 636.287.2700
Fax| 636.287.2703
www.rljonesproperties.com

The information contained herein is not warranted, although it has been obtained from the owner/landlord of the subject property or from other sources that RL Jones Properties, L.L.C. deemed reliable, and is subject to change without notice. Owner/landlord and RL Jones Properties, L.L.C. make no representations as to the environmental condition of the subject property and recommend tenant's independent investigation. All information should be verified prior to purchase or lease.

Wentzville Estate

712 W. Pearce Blvd.
Wentzville, Missouri

FOR LEASE:

Lloyd Jones
lloyd@rljonesproperties.com
314.574.9412

Site Plan

| SPACE | TENANT | SF |
|-------|----------------|--------|
| 1 | Dollar General | 8,715 |
| 2 | AVAILABLE | 16,000 |

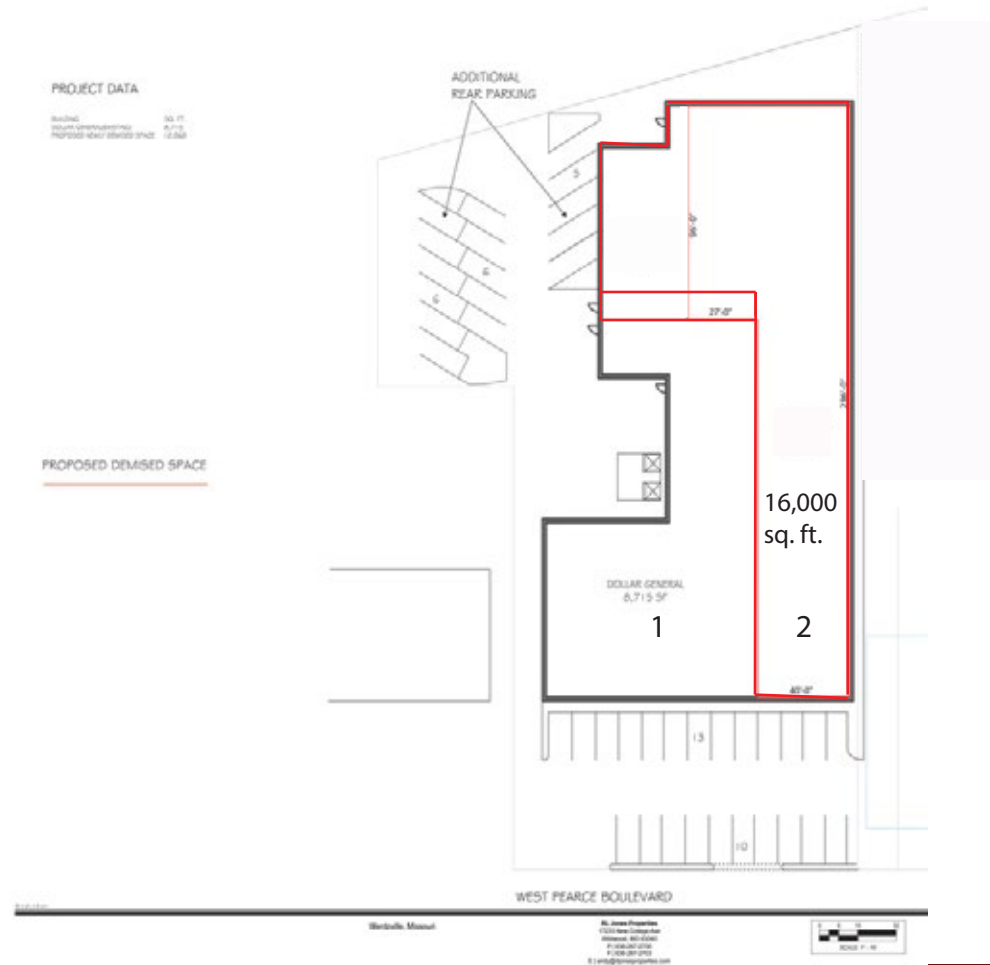

RL Jones Properties

17195 New College Ave.
Wilwood, MO 63040
Phone| 636.287.2700
Fax| 636.287.2703
www.rljonesproperties.com