

EMERYVILLE MANUFACTURING SPACE FOR LEASE: 1266 45th Street – Emeryville, CA

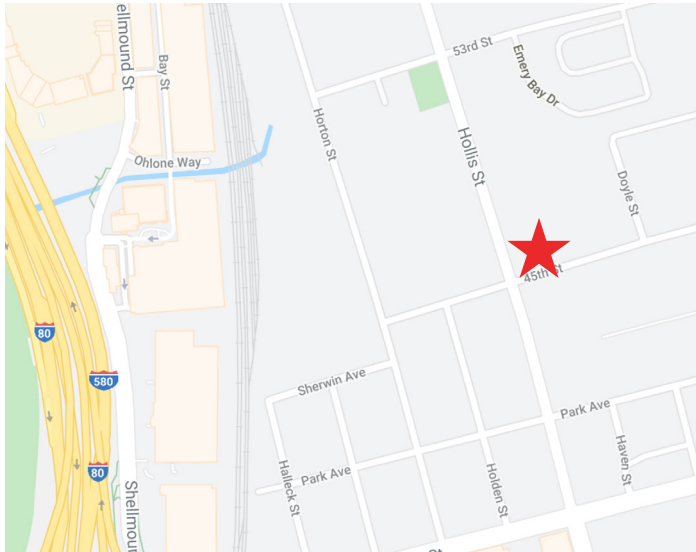

Property Size: ±12,370 SF Available

As exclusive agents, we are pleased to offer the following space:



PROPERTY HIGHLIGHTS:

- 2 Private Offices - First Floor
- 1 Private Office - Mezzanine
- Large Open Office Area
- 1 Restroom
- Spray Booth (Permitted)
- 2 Grade Level Doors
- 1 Low Boy Door
- Skylights
- Sprinklered
- 16'-18' Clear Height
- Heavy Power

COMMENTS:

- Past use - Woodworking
- Walk to Emery-Go-Round and Restaurants
- Short Drive from Powell I-80 Exit
- Zoning: MUR
- Saw-Tooth Roof Line
- Excellent Manufacturing Space

AVAILABLE Jan 1, 2020
Asking: \$1.10 IG



Jim Clark 510.923.6247 jim.clark@ngkf.com CA RE Lic. #00926308
Jeff Lahr 510.923.6208 jlahr@ngkf.com CA RE Lic. #01296493

1111 Broadway, Suite 100, Oakland, CA 94607

www.ngkf.com

EMERYVILLE MANUFACTURING SPACE FOR LEASE: 1266 45th Street – Emeryville, CA

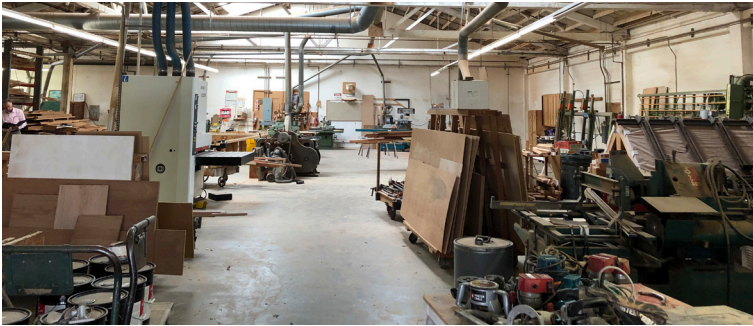
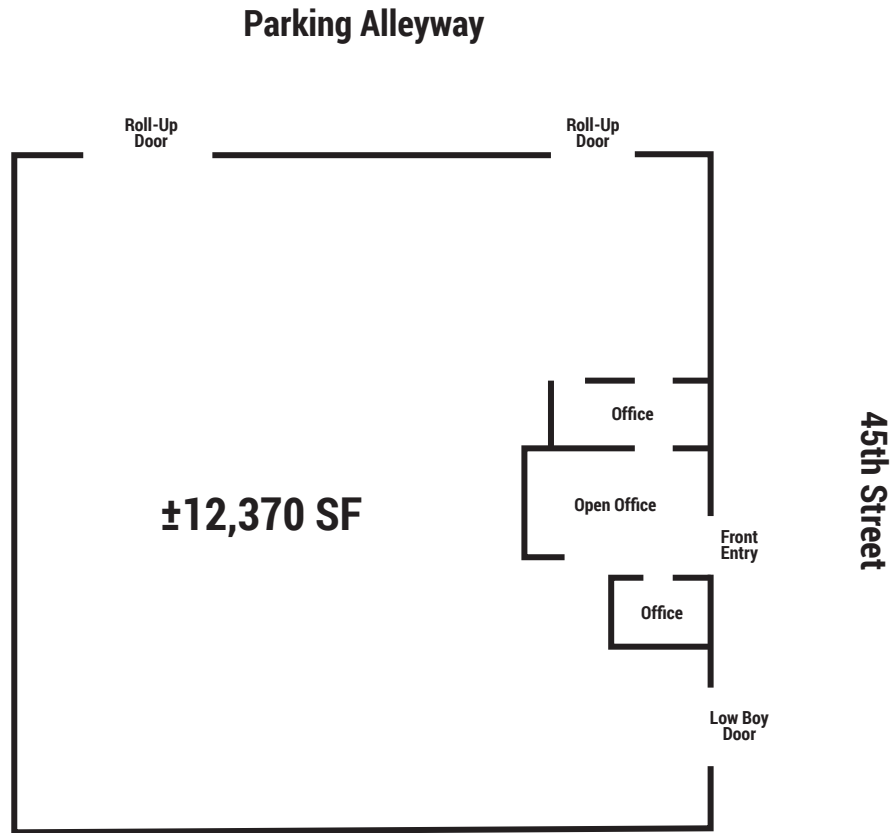

Jim Clark 510.923.6247 jim.clark@ngkf.com CA RE Lic. #00926308
Jeff Lahr 510.923.6208 jlahr@ngkf.com CA RE Lic. #01296493



1111 Broadway, Suite 100, Oakland, CA 94607

www.ngkf.com

The distributor of this communication is performing acts for which a real estate license is required. The information contained herein has been obtained from sources deemed reliable but has not been verified and no guarantee, warranty or representation, either express or implied, is made with respect to such information. Terms of sale or lease and availability are subject to change or withdrawal without notice.