

COMMERCIAL CORNER PARCEL 0.99 ACRES FOR DEVELOPMENT

for sale

Old Nashville Highway, Smyrna, TN



OVERVIEW

ADDRESS	11600 Old Nashville Hwy, Smyrna, TN 37167
LOT SIZE	0.99 Acres
ZONING	C-2
POSSIBLE USES	Medical, Retail, Gas Station, Restaurant, Strip Center, etc.

- Prime Corner Lot at Old Nashville Hwy & Davis Park Drive
- Rutherford County is the fastest growing county in Nashville MSA.
- Traffic Count: 13,745 CPD on Old Nashville Hwy and 10,135 CPD on Hazelwood Drive
- Located across from Walgreens, CVS Pharmacy, and Food Lion.

POSSIBLE DEVELOPMENT PLAN

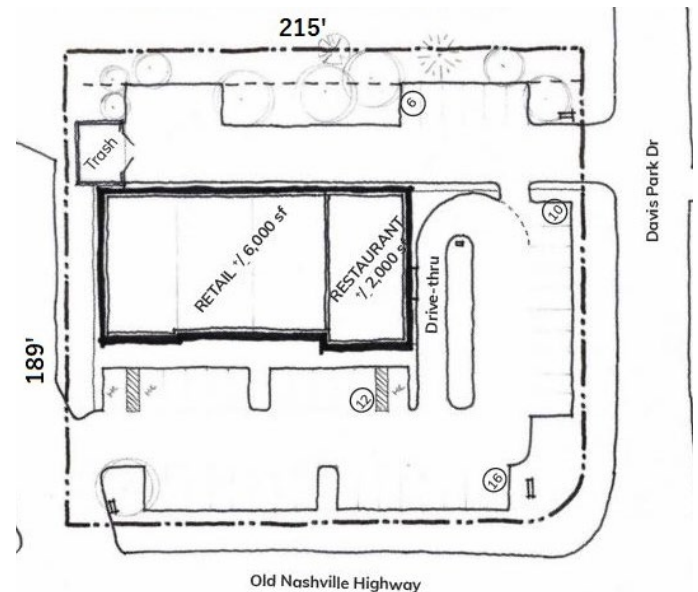

for more information, contact

POINTS OF INTEREST

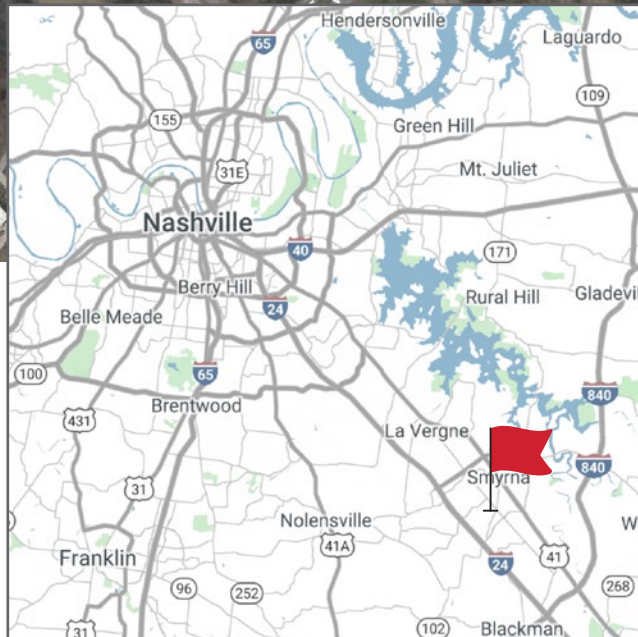

for more information, contact